



Eden Close, Croft Farm park, Luxulyan, Bodmin, Cornwall

£150,000

🛏 1 🚿 1 🚗 1



- Stunning Countryside Views
- Exclusive Over-55s Park
- Spacious Open-Plan Living Area
- Doors Onto Decked Area
- Large Double Bedroom
- Separate Dressing Room
- Contemporary Shower Room
- Modern Fitted Kitchen
- Private Parking & Shed
- Stunning Location and Condition



Occupying an enviable position on the highly sought-after Croft Farm Residential Park, this beautifully presented one double bedroom park home bungalow enjoys stunning uninterrupted countryside views across open fields. The bright and spacious accommodation includes a generous open-plan living/dining room with full-width doors opening onto a superb composite deck, creating a seamless connection between indoor and outdoor living. A modern fitted kitchen, stylish shower room and spacious double bedroom with adjoining dressing room complete the accommodation. Outside, the landscaped low-maintenance garden offers additional seating areas, a useful storage shed and the perfect setting to relax and enjoy the peaceful surroundings. With private parking, luxurious presentation throughout and located within this exclusive over-55s residential park close to the Eden Project and Cornish coast, this exceptional home is ready to move straight into.



Eden Close, Croft Farm Park, Luxulyan, Bodmin, PL30

Approximate Area = 614 sq ft / 57 sq m
 Outbuilding = 41 sq ft / 3.8 sq m
 Total = 655 sq ft / 60.8 sq m
 For identification only - Not to scale

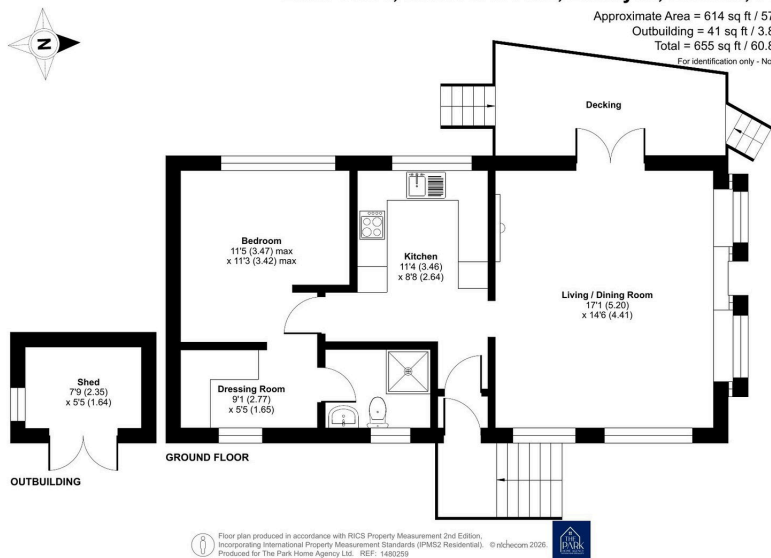

01793 230185
 sales@theparkhomeagency.co.uk

Agents Notes: All measurements are approximate and quoted in metric with imperial equivalents and for general guidance only and whilst every attempt has been made to ensure accuracy, they must not be relied on. The fixtures, fittings and appliances referred to have not been tested and therefore no guarantee can be given that they are in working order. Internal photographs are reproduced for general information and it must not be inferred that any item shown is included with the property. For a free valuation, contact the numbers listed on the brochure