

DAVID CHARLES

ESTATE AGENTS • VALUERS • SURVEYORS
THE ESTATE OFFICE • 34 HIGH STREET • PINNER • MIDDLESEX HA5 5PW
TELEPHONE 020 8866 0222 • FAX 020 8868 3544
WEBSITE www.david-charles.co.uk • E-MAIL pinner-sales@david-charles.co.uk

MEADOW ROAD, PINNER, MIDDLESEX, HA5 1ED



PRICE....£449,000....LEASEHOLD

This purpose built two double bedroom ground floor maisonette (614 sq ft/57 sq m) is presented in excellent condition and has been updated recently to include a new kitchen, bathroom and gas boiler. It is located on a desirable road within the catchment area of West Lodge School and a short walk to Pinner Memorial Park. It is also within half a mile of the village centre offering a wide range of amenities and the Metropolitan Line train station giving swift access to Central London. The property benefits from being double glazed throughout, has a feature fireplace in the living room and a private rear garden with a westerly aspect. There is a lease with over 100 years remaining and low outgoings and the property is offered with no upper chain.

020 8866 0222









COUNCIL TAX

London Borough of Harrow - Band D - £2,511.07

LEASE & BUILDING INSURANCE

Lease - 110 Years
Building Insurance - £358.48

LOCAL SCHOOLS

West Lodge Primary School - 0.24 Miles
Cannon Lane Primary School - 0.55 Miles
Northwood School - 0.73 Miles
Nower Hill High School - 1.21 Miles

LOCAL TRANSPORT

Pinner Station (Metropolitan Line) - 0.5 Miles

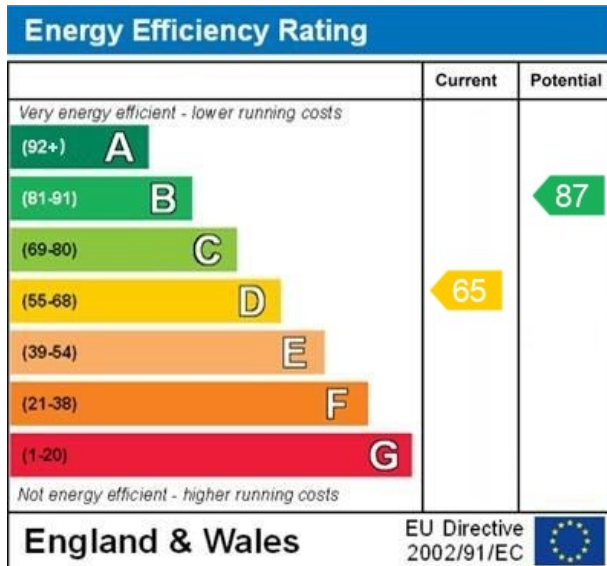
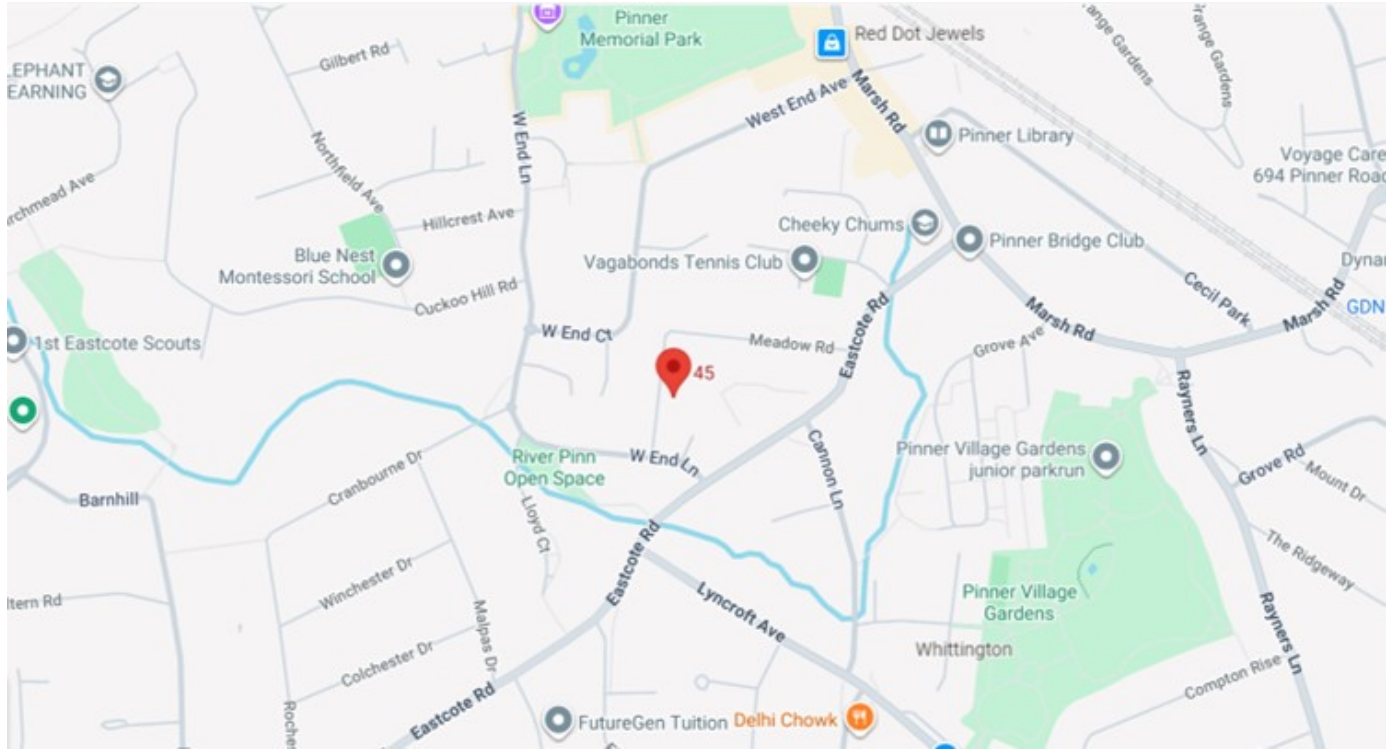

WWW.EPC4U.COM

Meadow Road

Approximate Gross Internal Area
57.0 sq m / 614 sq ft

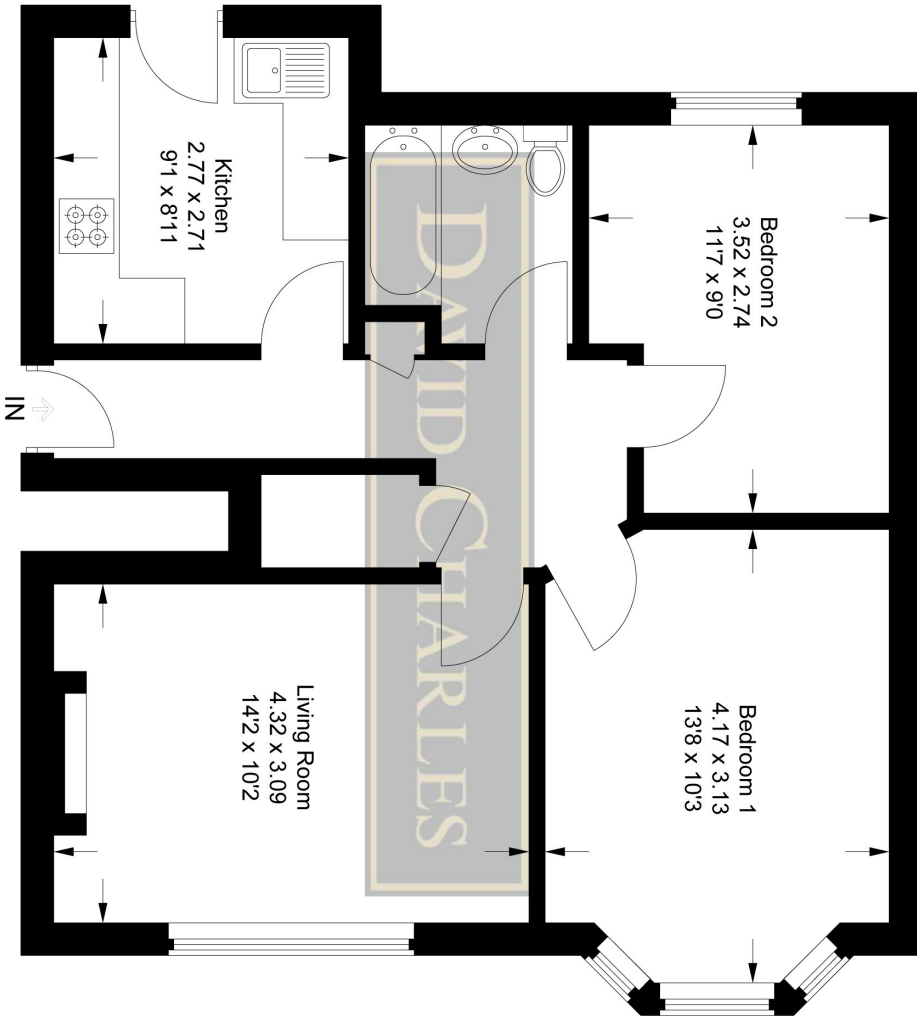

Ground Floor

This plan is for layout guidance only. Not drawn to scale unless stated. Windows and door openings are approximate. Whilst every care is taken in the preparation of this plan, please check all dimensions, shapes and compass bearings before making any decisions reliant upon them.

© CJ Property Marketing Ltd Produced for David Charles

For appointments to view please call David Charles 020 8866 0222

All measurements are taken manually and whilst every care is taken with their accuracy they must be considered approximate and should not be relied upon when purchasing carpets or furniture. No responsibility is taken for any error, omission or misunderstanding in these particulars which do not constitute an offer or contract. Services and appliances have not been tested and therefore no warranty is offered on their operational condition.