



Our View “A property that must be viewed to be appreciated”

A well-presented three-bedroom end-of-terrace property arranged over three levels, offering spacious living accommodation, enclosed gardens, and three off-road parking spaces, located on a cul-de-sac in Chudleigh Knighton.

The accommodation begins with an entrance hallway featuring wood-effect flooring, which continues throughout much of the ground floor. A door leads to the downstairs WC, fitted with a low-level flush WC, pedestal wash hand basin, and an obscure double-glazed window to the front, along with tiled flooring. From the entrance hallway, an internal glazed door provides access to the living room, which benefits from a double-glazed window to the front, continued flooring, a useful storage cupboard, and a further door leading to the kitchen/dining room. Located at the rear of the property, the kitchen/dining room features a modern fitted kitchen comprising a range of matching wall and base units with a mixer tap and drainer, an induction hob with extractor hood and light above, and a range of built-in appliances including a dishwasher and oven, with space for a washing machine and fridge/freezer. The room also includes tiled flooring, a double-glazed window, and double doors providing access to the garden. From the entrance hallway, stairs rise to the first floor. The landing provides access to two double

bedrooms, both featuring double-glazed windows to the front or rear. Dividing the bedrooms is a modern fitted bathroom suite comprising a low-level flush WC, pedestal wash hand basin, and panel bath with partly tiled walls and tiled flooring, along with an obscure double-glazed window to the side. There is also a useful airing cupboard housing the water cylinder. Stairs rise to the second floor, where the landing offers a useful area that could be utilised as a dressing room or study, with a double-glazed window to the front. This leads into the master bedroom, a good-sized double room benefiting from built-in wardrobes and access to a modern fitted en-suite shower room. The en-suite includes a low-level flush WC, pedestal wash hand basin, and mains-fed shower, with fully tiled walls and an obscure double-glazed window to the side. The bedroom also has a hatch providing access to the loft space. Externally, the property features enclosed gardens to the front, including a section of lawn bordered by mature trees, offering a good level of privacy. To the rear, there is an enclosed garden with a decking area leading from the kitchen/dining space onto artificial grass and a patio area, creating a low-maintenance outdoor space. There is also a wooden storage shed. Additionally, the property benefits from three off-road parking spaces.

- Superb property
- End of terrace
- Living room
- Kitchen / dining room
- Three double bedrooms (master en suite)
- Family bathroom
- Enclosed gardens
- Off road parking for three cars
- Culdesac
- Village location



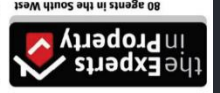

Total floor area 104.1 sq.m. (1,121 sq.ft.) approx

Ground Floor

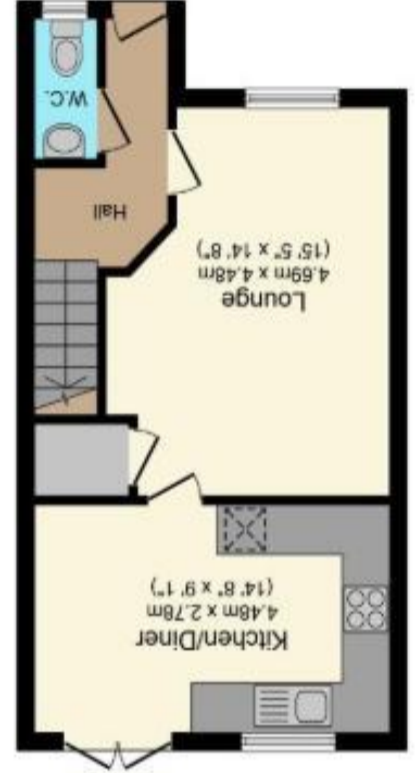

First Floor

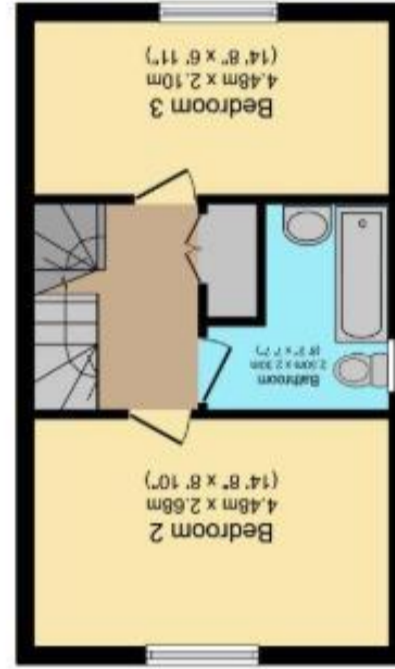

Second Floor

