



Connells

Pennycress Close
Swindon



Property Description

Tucked away within a peaceful cul-de-sac in the highly regarded Haydon Wick area of North Swindon, this attractive two-bedroom semi-detached home offers well-balanced accommodation with a modern finish throughout.

The ground floor welcomes you via an entrance porch into a light and inviting living room, providing a comfortable space to relax. To the rear, the modern kitchen/diner is thoughtfully designed, offering ample storage and worktop space alongside room for a dining table, making it a practical and sociable area for everyday living and entertaining.

Rising to the first floor, the property continues to impress with two generously sized bedrooms, both enjoying plenty of natural light. These are complemented by a well-appointed family bathroom finished in a contemporary style.

Externally, the home benefits from a low-maintenance, enclosed tiered rear garden, creating a private outdoor retreat with space to enjoy throughout the seasons. Further advantages include a garage and driveway parking, providing convenient and secure off-road parking.

Positioned within easy reach of local amenities, schools, and transport links, this well-presented home enjoys a desirable setting within one of North Swindon's most popular residential locations.

Ground Floor Accommodation Entrance Porch

Double glazed door to the front aspect.
Access to the lounge/Diner

Lounge

14' 1" x 12' (4.29m x 3.66m)
Double glazed window to the front aspect.
Stairs rising to the first floor accommodation.
Radiator.

Kitchen/Diner

12' 1" x 6' 11" (3.68m x 2.11m)
Double glazed window to rear aspect. Fully fitted kitchen with a range of base and wall mounted units comprising of modern cupboards and drawers and work surfaces. One and a half stainless steel sink with drainer. Integrated electric oven. Space and plumbing for washing machine. Space for fridge freezer. Tiled splash back to water sensitive areas. Radiator.

First Floor Accommodation First Floor Landing

Access to both bedrooms and family bathroom

Bedroom One

12' 1" MAX x 8' 9" MAX (3.68m MAX x 2.67m MAX)
Double glazed window to front aspect. Built-in double wardrobe. Television point. Radiator.

Bedroom Two

12' 2" x 6' 11" (3.71m x 2.11m)
Double glazed window to rear aspect. Built-in cupboard housing the water tank. Radiator.

Bathroom

Obscured double glazed window to side aspect. Three piece suite comprising of panelled bath with shower, Wash hand basin and Low level WC. Partially tiled to water sensitive areas Radiator.

External Features Garden

Low maintenance enclosed rear garden with fenced/walled boundaries. Tier style garden laid to patio. Steps leading to the garden laid to artificial lawn.

Garage

16' 5" x 8' 7" (5.00m x 2.62m)
Power and light. Up and over door.

Parking

Driveway parking



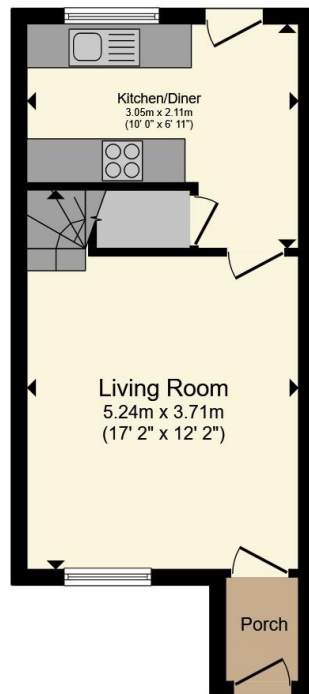

Ground Floor

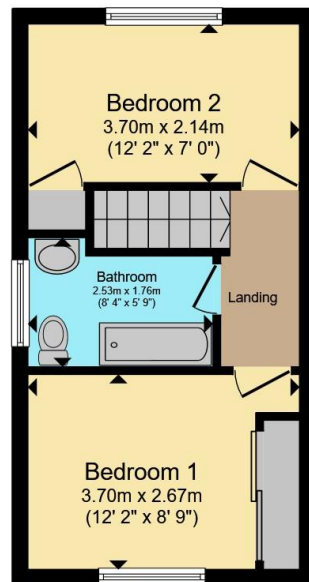

First Floor

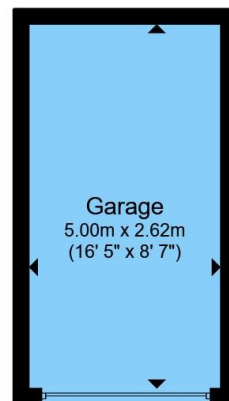

Garage

Total floor area 69.9 m² (753 sq.ft.) approx

This floor plan is for illustrative purposes only. It is not drawn to scale. Any measurements, floor areas (including any total floor area), openings and orientation are approximate. No details are guaranteed, they cannot be relied upon for any purpose and they do not form part of any agreement. No liability is taken for any error, omission or misstatement. A party must rely upon its own inspection(s). Powered by www.propertybox.io

Connells



To view this property please contact Connells on

T 01793 708050
E swindonnorth@connells.co.uk

Unit B11 North Swindon District Centre Thamesdown Drive
SWINDON SN25 4AN

EPC Rating: C Council Tax
Band: B

view this property online connells.co.uk/Property/SDN314576

Tenure: Freehold



1. MONEY LAUNDERING REGULATIONS Intending purchasers will be asked to produce identification documentation at a later stage and we would ask for your co-operation in order that there will be no delay in agreeing the sale. 2. These particulars do not constitute part or all of an offer or contract. 3. The measurements indicated are supplied for guidance only and as such must be considered incorrect. Potential buyers are advised to recheck measurements before committing to any expense. 4. We have not tested any apparatus, equipment, fixtures, fittings or services and it is in the buyers interest to check the working condition of any appliances.

Connells Residential is registered in England and Wales under company number 1489613, Registered Office is Cumbria House, 16-20 Hockliffe Street, Leighton Buzzard, Bedfordshire, LU7 1GN. VAT Registration Number is 500 2481 05.

See all our properties at www.connells.co.uk | www.rightmove.co.uk | www.zoopla.co.uk

Property Ref: SDN314576 - 0002