



Foley Court, Streetly
Sutton Coldfield, B74 3TG

£210,000

Set within the sought-after Foley Court development in the heart of Streetly, this well presented two bedroom ground floor apartment offers a rare combination of privacy, convenience, and location.

Positioned within a secure gated complex, the property benefits from its own private entrance door, meaning there are no internal communal areas. Internally, the accommodation is both spacious and well laid out, beginning with a welcoming entrance hallway. The generous lounge/dining room is a standout feature, boasting a charming bay window to the front that allows for plenty of natural light. There is also a separate fitted kitchen, offering ample storage and workspace. The property comprises two double bedrooms, including a master bedroom with the added benefit of an en-suite shower room. A second double bedroom is served by a well-appointed family bathroom.

Externally, residents can enjoy well-maintained communal grounds, along with shared parking available on a first come, first served basis. Ideally located, the apartment is within close proximity to a range of reputable local schools, excellent public transport links, and everyday amenities. Nature lovers will also appreciate being just a short distance from Sutton Park, a stunning 2,400-acre national nature reserve.

The property is offered for sale with approximately 98 years remaining on the lease and is available with no onward chain, making it an excellent opportunity for first-time buyers, downsizers, or investors alike.

Tenure: We can confirm the property is Leasehold.

Council Tax Band: We can confirm the Council Tax Band is E payable to Walsall Council.

Services Connected: Mains gas, electric, water and drainage.

Viewings: Strictly via appointment through our Streetly Residential Sales Department on 0121 353 6464

or via Streetly@paulcarrestateagents.co.uk



PAUL
CARR
Estate Agents
Sales & Lettings

Accommodation

Entrance Hall
24' 2" x 3' 8" (7.36m x 1.12m)

Lounge/Dining Room
24' 10" x 11' 10" (7.56m x 3.60m)

Kitchen
12' 0" x 6' 4" (3.65m x 1.93m)

Bedroom One
11' 4" x 10' 5" (3.45m x 3.17m)

En-Suite
4' 3" x 6' 5" (1.29m x 1.95m)

Bedroom Two
11' 7" x 7' 5" (3.53m x 2.26m)

Bathroom
7' 2" x 6' 5" (2.18m x 1.95m)

Lease Information

Management Company - Premier Estates
Approx. **98 Years** remaining on the lease.
Service Charge currently **£128.22 per month**.
Ground Rent currently **£368.56 per annum**.

(Lease charges provided by the vendor)





Floor Plan

This floor plan is not drawn to scale and is for illustration purposes only

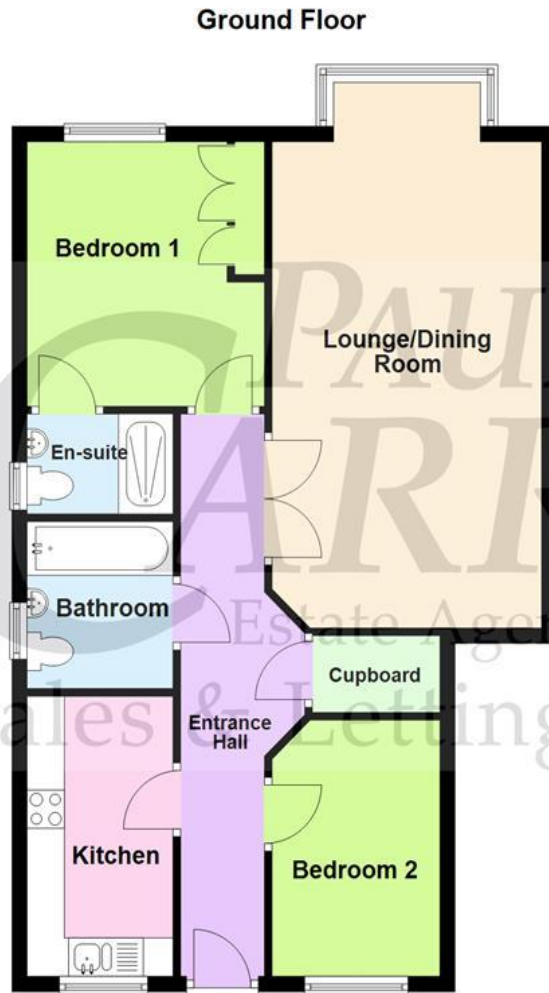

This floorplan is not drawn to scale and is for illustration purposes only
Plan produced using PlanUp.

Energy Performance Rating

Score	Energy rating	Current	Potential
92+	A		
81-91	B		
69-80	C	70 C	76 C
55-68	D		
39-54	E		
21-38	F		
1-20	G		

Map Location

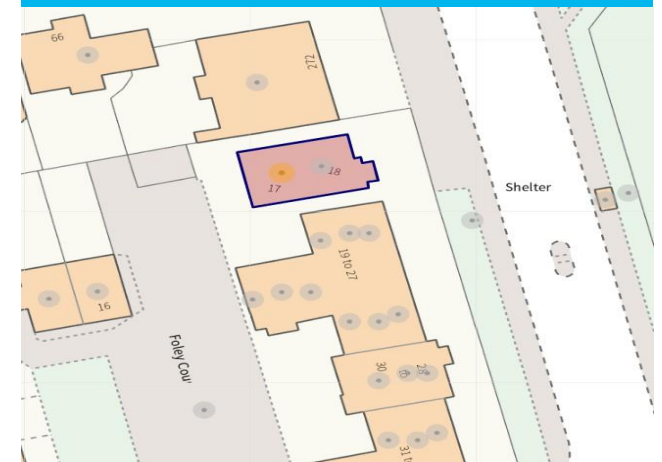







Agent's Note:

Every care has been taken with the preparation of these Sales Particulars but they are for general guidance only and complete accuracy cannot be guaranteed. If there is any point which is of particular importance, professional verification should be sought. The mention of any fixtures, fittings and/or appliances does not imply they are in full efficient working order as they have not been tested. All dimensions are approximate. Photographs are reproduced for general information and it cannot be inferred that any item shown is included in the sale. These Sales Particulars do not constitute a contract or part of a contract. Came on the market: 14th April 2026

Identity Verification Fee - We are required by law to conduct anti-money laundering checks on all those buying a property as part of our due diligence. As agents acting on behalf of the seller, we are required to verify the identity of all purchasers once an offer has been accepted, subject to contract. The initial checks are carried out on our behalf by Lifetime Legal. A non-refundable administration fee of £40 + VAT (£48 including VAT) applies which covers the cost of obtaining relevant data and any manual checks and monitoring which might be required. This fee will need to be paid by you in advance of us issuing a memorandum of sale, directly to Lifetime Legal, and is non-refundable.