



HEATHFIELD TERRACE, W4

£425,000

Situated in this popular residential development moments from Chiswick High Road, This two-bedroom, ground-floor apartment requires modernisation throughout.

Two bedrooms
On-site caretaker
Local amenities

No chain
Project
Energy rating: d

STEP INSIDE HEATHFIELD TERRACE

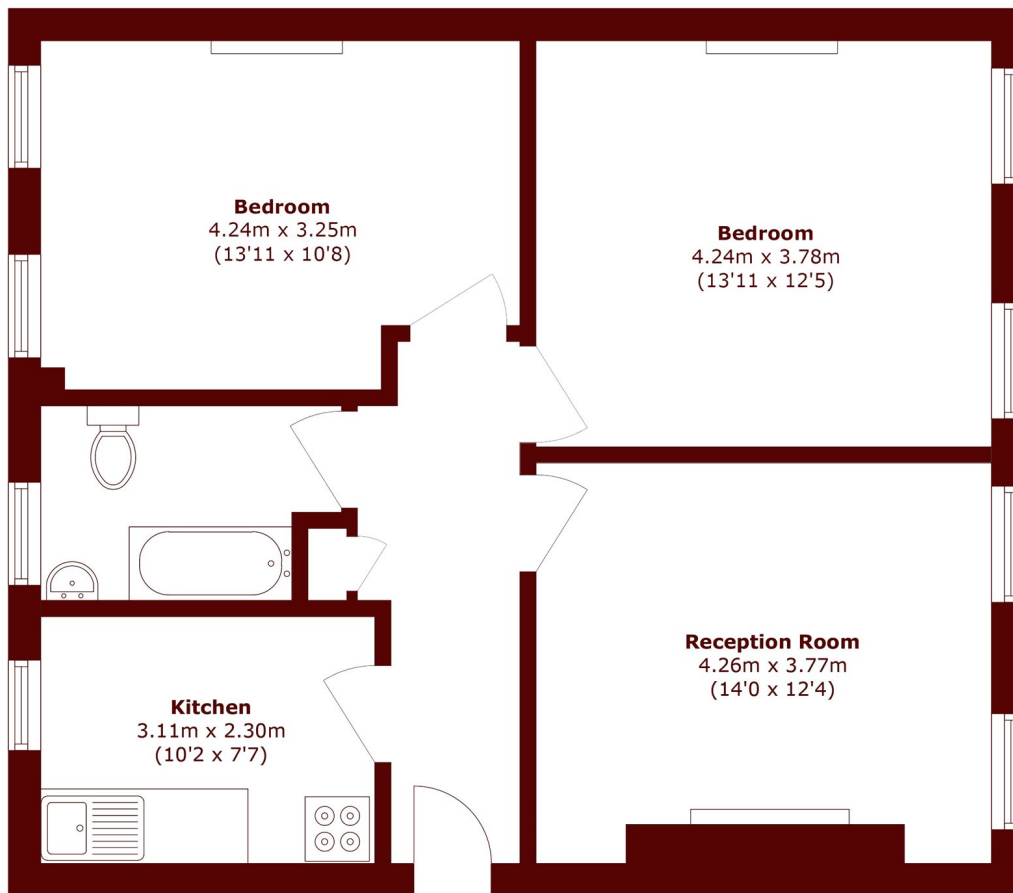

Total area (approx.): 67.7 sq. m (728.7 sq. ft)

Chiswick
020 8994 2556

Energy Rating: D We aim to make our particulars both accurate and reliable. However, they are not guaranteed; nor do they form part of an offer or contract. If you require clarification on any points then please contact us, especially if you're traveling some distance to view. Please note that appliances and heating systems have not been tested and therefore no warranties can be given as to their good working order

MARSH &
PARSONS