

37 Turnlee Drive, Glossop, Derbyshire, SK13 6XA



- NO VENDOR CHAIN
- Three Bedroom Terrace
- Head of a cul-de-sac
- Open Plan Living
- Light and Airy Lounge / Diner with countryside views

- Private Rear Garden
- Off Road Parking
- Close to Local Amenities, Schools and Transport Links
- Potential Investment Property
- Viewing Highly Recommended

37 Turnlee Drive, Glossop, Derbyshire SK13 6XA

MAIN DESCRIPTION

NO VENDOR CHAIN

Situated at the head of a quiet cul-de-sac, this charming upside-down home offers a perfect layout for modern family living. Designed with the living areas on the upper floor to make the most of light and views, the property is ideally suited to families seeking a safe, child-friendly environment.

The home boasts a spacious and well-appointed kitchen, flowing seamlessly into the dining and lounge areas, creating an open and sociable space. Three well-proportioned bedrooms provide flexibility for family members, while the modern bathroom and practical storage solutions enhance convenience.

Outside, the property benefits from off-road parking and a rear garden, perfect for children to play safely or for relaxing with family. The location offers peace and privacy at the end of a cul-de-sac, while remaining within easy reach of local amenities, schools, and transport links.

This property combines thoughtful design, family-friendly living, and an excellent location, making it a rare opportunity for those looking for a comfortable and practical family home.



37 Turnlee Drive, Glossop, Derbyshire, SK13 6XA

ENTRANCE HALLWAY

External door to hallway, ceiling light point, wall mounted radiator, internal doors to the ground floor accommodation.

BEDROOM ONE

12' 7" x 7' 5" (3.84m x 2.26m) Located at the rear of the property, this double bedroom overlooks the garden and is filled with natural light. with wall-mounted radiator and ceiling light.

BEDROOM TWO

7' 6" x 7' 0" (2.29m x 2.13m) uPVC double glazed window to the front elevation, wall-mounted radiator and ceiling light.

BEDROOM THREE

8' 4" x 7' 5" (2.54m x 2.26m) Featuring uPVC double glazed sliding patio doors that provide direct access to the garden, this bright and airy bedroom is ideal for enjoying indoor-outdoor living. Wall-mounted radiator and ceiling light point.

BATHROOM

6' 7" x 5' 0" (2.01m x 1.52m) A modern three-piece suite comprises a low-level WC, pedestal sink with storage underneath, and a shower unit. Floor-to-ceiling tiling, ceiling light point, and a chrome wall-mounted towel radiator.

LOUNGE/DINER

16' 8" x 12' 4" (5.08m x 3.76m) Stairs from the ground to the first floor offers access into a bright and airy lounge/dining room with large uPVC double glazed windows to both the rear and front elevations. Rear windows provide a lovely garden aspect, while front windows offer far-reaching countryside views. Two wall-mounted radiators and ceiling light points.

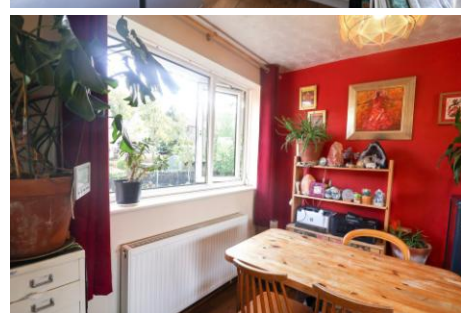

37 Turnlee Drive, Glossop, Derbyshire, SK13 6XA

KITCHEN

8' 4" x 7' 0" (2.54m x 2.13m) A spacious kitchen fitted with a mix of high and low-level units, complemented by contrasting work surfaces and a stylish tiled splashback. It features a four ring gas hob with extractor fan, electric oven, and a stainless steel sink with mixer tap and drainer. A uPVC double glazed window overlooks the rear garden, and an archway leads seamlessly into the dining area, creating a light and open space perfect for family meals.



EXTERNALLY

To the front there is a large lawned garden with space for off-road parking and to the rear a child-friendly garden.

DISCLAIMER

The vendor has advised the following:

Property Tenure - Leasehold
Annual Ground Rent - £15pa
Leasehold Term - 952 years remaining
EPC Rate - C
Council Tax Band Rating - B
Council - High Peak Borough Council

Key Information

- Built in 1989
- Leasehold – 999 years from 1978, £15 per annum ground rent
- No vendor chain
- Gas and electricity supplied to the property
- Water rates billed separately
- Previous owner lived at the property from 2001–2013, then rented out
- Loft not boarded, no ladder, but insulated and with a light
- Private garden with shed (no power)
- Gas boiler installed 10 years ago, located on the ground floor
- Gas and electricity meters at the front of the house
- Internet connection available

Disclaimer: The above information has been provided by the vendor to the best of their knowledge at the time of listing. Purchasers are advised to seek independent verification prior to purchase.

37 Turnlee Drive, Glossop, Derbyshire, SK13 6XA

GROUND FLOOR

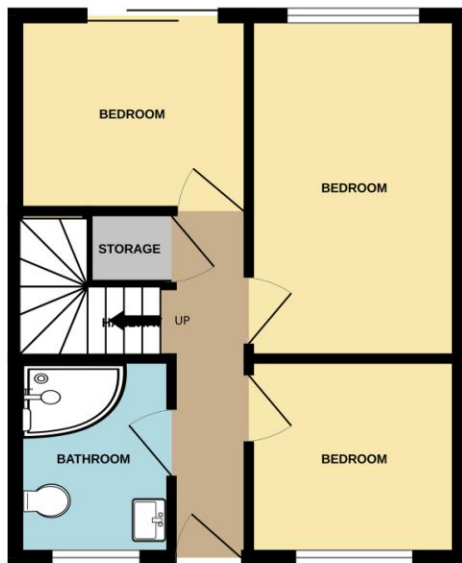

1ST FLOOR

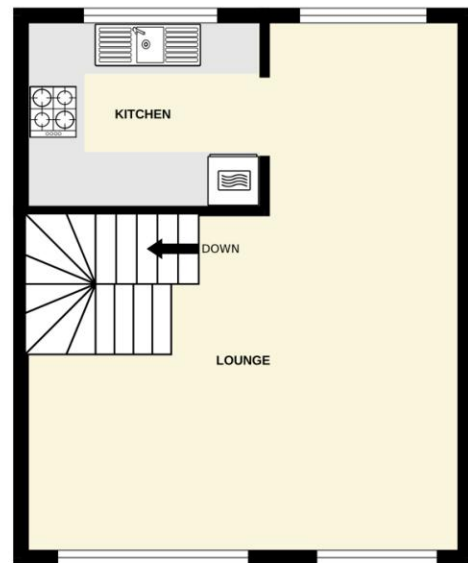

Whilst every attempt has been made to ensure the accuracy of the floorplan contained here, measurements of doors, windows, rooms and any other items are approximate and no responsibility is taken for any error, omission or mis-statement. This plan is for illustrative purposes only and should be used as such by any prospective purchaser. The services, systems and appliances shown have not been tested and no guarantee as to their operability or efficiency can be given.
Made with Metropix ©2025

Agents Disclaimer: Stepping Stones Asset Management Ltd, their clients and employees 1: Are not authorised to make or give any representations or warranties in relation to the property either here or elsewhere, either on their own behalf or on behalf of their client or otherwise. They assume no responsibility for any statement that may be made in these particulars. These particulars do not form part of any offer or contract and must not be relied upon as statements or representations of fact. 2: Any areas, measurements or distances are approximate. The text, photographs and plans are for guidance only and are not necessarily comprehensive. It should not be assumed that the property has all necessary planning, building regulation or other consents and Stepping Stones Asset Management Ltd have not tested any services, equipment or facilities. Purchasers must make further investigations and inspections before entering into any agreement.

Purchaser information -The Money Laundering, Terrorist Financing and Transfer of Funds(Information on the Payer) Regulations 2017(MLR 2017) came into force on 26 June 2017. Stepping Stones Asset Management Ltd require any successful purchasers proceeding with a property to provide two forms of identification i.e. passport or photocard driving license and a recent utility bill or bank statement. We are also required to obtain proof of funds and provide evidence of where the funds originated from. This evidence will be required prior to Stepping Stones Asset Management removing a property from the market and instructing solicitors for your purchase.

Third Party Referral Arrangements - Stepping Stones Asset Management may have established professional relationships with third-party suppliers for the provision of services to Clients. As remuneration for this professional relationship, the agent may receive referral commission from the third-party companies. Details are available upon request.