



Grove End House

Grove End Road, NW8

£2,750 per month
(£634.62 per week)

A spacious two bedroom top floor (with lift) apartment with private balcony and views of the city skyline in the heart of St John's Wood.

CHESTERTONS



Grove End House

Grove End Road, NW8

- Top Floor Flat
- 2 Bedrooms, 1 Bathroom
- Lift, Porter, Communal Garden, Balcony
- Close to St John's Wood Station



A spacious two bedroom top floor (with lift) apartment with private balcony and views of the city skyline in the heart of St John's Wood.

The property comprises two double bedrooms, modern bathroom, large reception room, fitted kitchen and private balcony.

Minimum Term: 6 months
Deposit Required: £3,173.08
Local Authority: City of Westminster
Council Tax Band: B
EPC Rating: D
Furnished

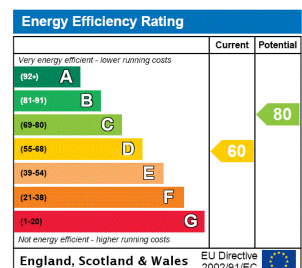

Chestertons St John's Wood Lettings

105 St. John's Wood Terrace
 London
 NW8 6PL
 stjohslettingsusers@chestertons.co.uk
 02030408622
 chestertons.co.uk

Additional tenant charges apply (fees apply to non-AST tenancies only)
 Tenancy Agreement Fee: £300
 References per Tenant/Guarantor: £60
 Inventory check (approx. £100 – £250 inc. VAT)
chestertons.co.uk/property-to-rent/applicable-fees

Grove End Road, NW8 9HS

Approx Gross Internal Area = 58.3 sq m / 628 sq ft

Balcony = 8.6 sq m / 93 sq ft

Total = 66.9 sq m / 720 sq ft

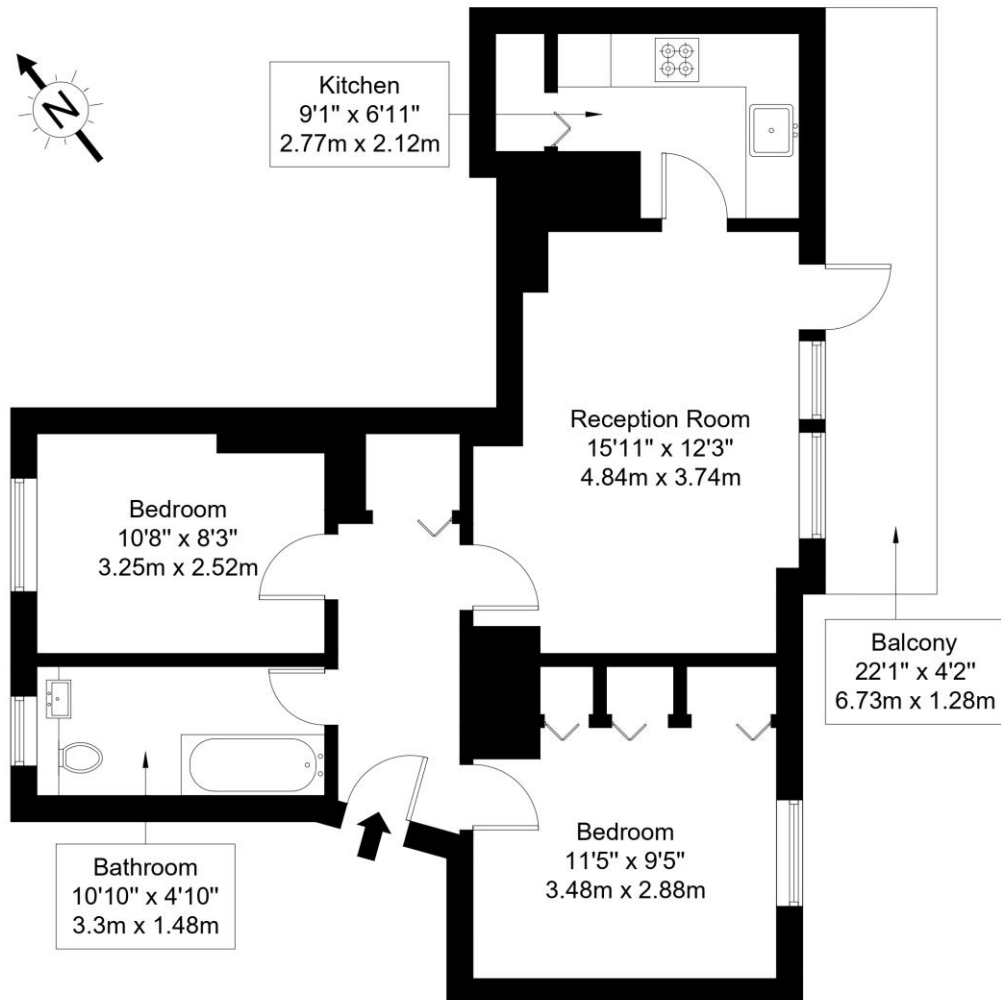

Eighth Floor

Ref :

Copyright **BLEU
PLAN**

The Floor plan is not to scale and measurements and areas shown are approximate and therefore should be used for illustrative purposes only. The plan has been prepared in accordance with the RICS code of Measuring Practice and whilst we have confidence in the information produced it must not be relied on. Maximum lengths and widths are represented on the floor plan. If there is any aspect of particular importance, you should carry out or commission your own inspection of the property.

Copyright @ BLEUPLAN

