



FISHER
ESTATES

Weetmans Drive, Colchester, CO4 9EA

£150,000

 2  1  1



- TWO BEDROOMS
- GROUND FLOOR
- POPULAR NORTH COLCHESTER LOCATION
- 20'4 LOUNGE/DINER
- ALLOCATED PARKING AND BIKE STORAGE
- DOUBLE GLAZED
- EASY ACCESS FOR THE A12
- NO ONWARD CHAIN



We are delighted to present this modern ground floor apartment situated to the North side of Colchester, situated close to local amenities including popular schooling (The Gilbert School), shops/pubs/restaurants, the North station and the A12.

This no chain apartment presents an IDEAL first time buy or investment opportunity.

The property benefits from 20'4 ft lounge/diner flooded with natural light through to a fitted kitchen. two double bedrooms, family bathroom, and allocated parking.

This Property does need some renovation.

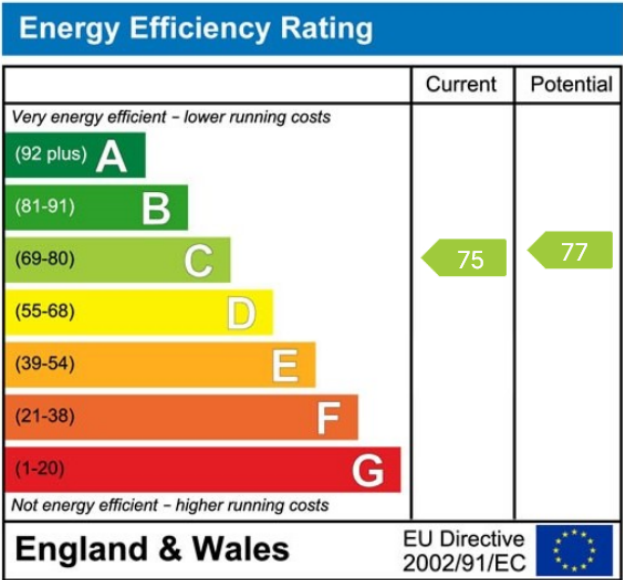
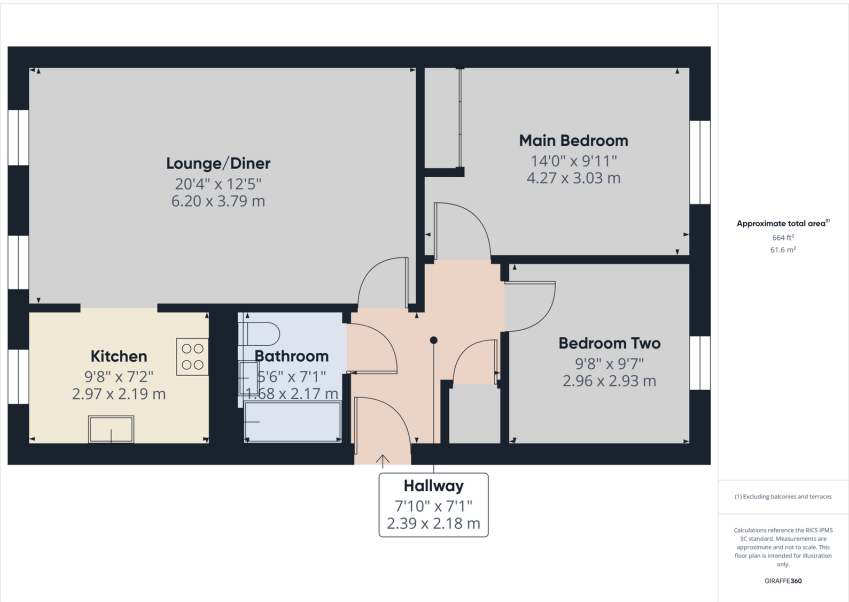

COLCHESTER 01206 480008 | BRAINTREE 01376 343777 | TAKELEY 01279 808707 | BISHOP STORTFORD 01279 808708

ENQUIRES@FISHERESTATES.CO.UK | LETTINGS@FISHERESTATES.CO.UK

WWW.FISHERESTATES.CO.UK