



Clapham Common South Side, £2,400 Per calendar month

A modern one double bedroom apartment in the Latitude Building, offering a spacious open plan reception room with modern kitchen, good sized bedroom, bathroom, storage space and concierge service. The property also has allocated, underground parking.

Situated on Clapham Common South Side, the property is ideally located for easy access to the many shops, bars and restaurants of the Abbeville Village, Nightingale Triangle & Balham Hill. Transport links are superb with Clapham South Underground Station located just over the road.

Features

- Open Plan Reception Room
- Modern Kitchen
- Double Bedroom
- Allocated Underground Parking
- Building Concierge

Clapham Common South Side, London, SW4

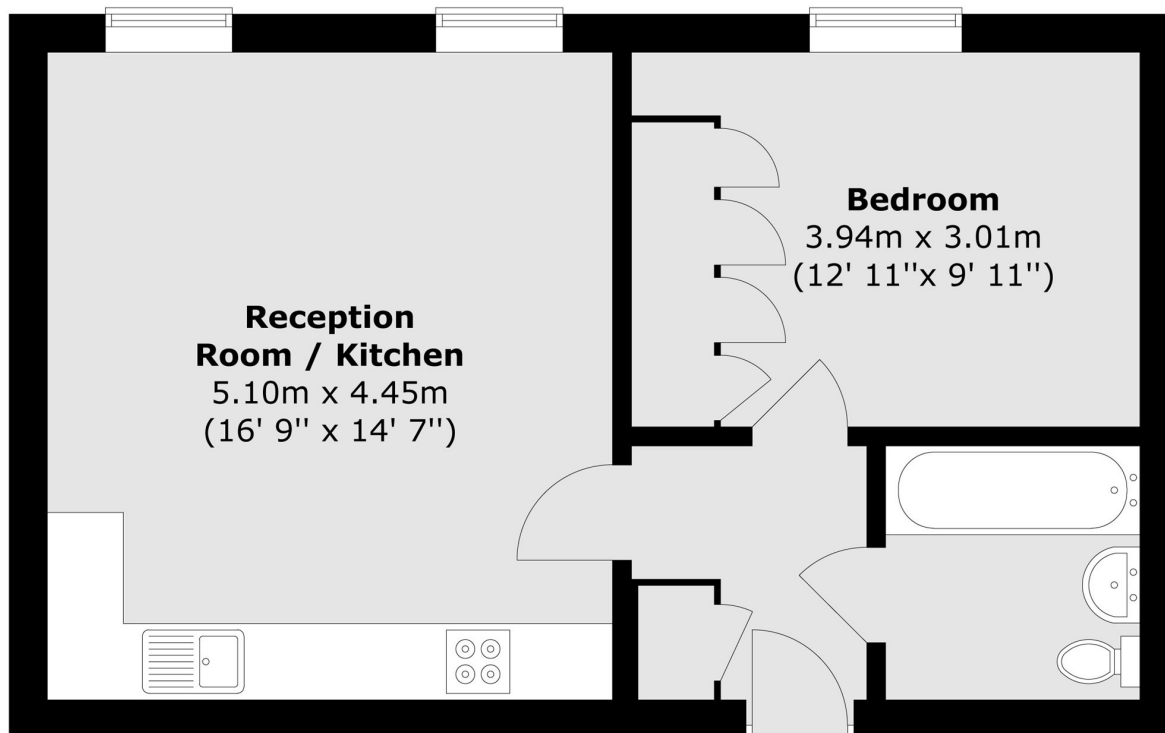

Total area (approx.) : 44 sq. m (474 sq. ft)