



8 Bramley Gardens

Ashford, TN23 6GY

Guide Price £280,000

GUIDE PRICE £280,000 - £300,000

Detached two bedroom bungalow in quiet cul de sac with an over 49 years age restriction.

Originally constructed in about 1992 by a local firm of builders, the bungalow requires some updating but has internal oak panelled doors. No Chain.

Viewing

Please contact our Ashford Office on 01233 646411 if you wish to arrange a viewing appointment for this property or require further information.

- DETACHED BUNGALOW
- FOR OVER 49's
- TWO BEDROOMS
- NICELY ENCLOSED REAR GARDEN
- QUIET CUL DE SAC LOCATION
- OAK PANELLED DOORS
- NO ONWARD CHAIN
- GAS CENTRAL HEATING
- DOUBLE GLAZING



Floor Plan

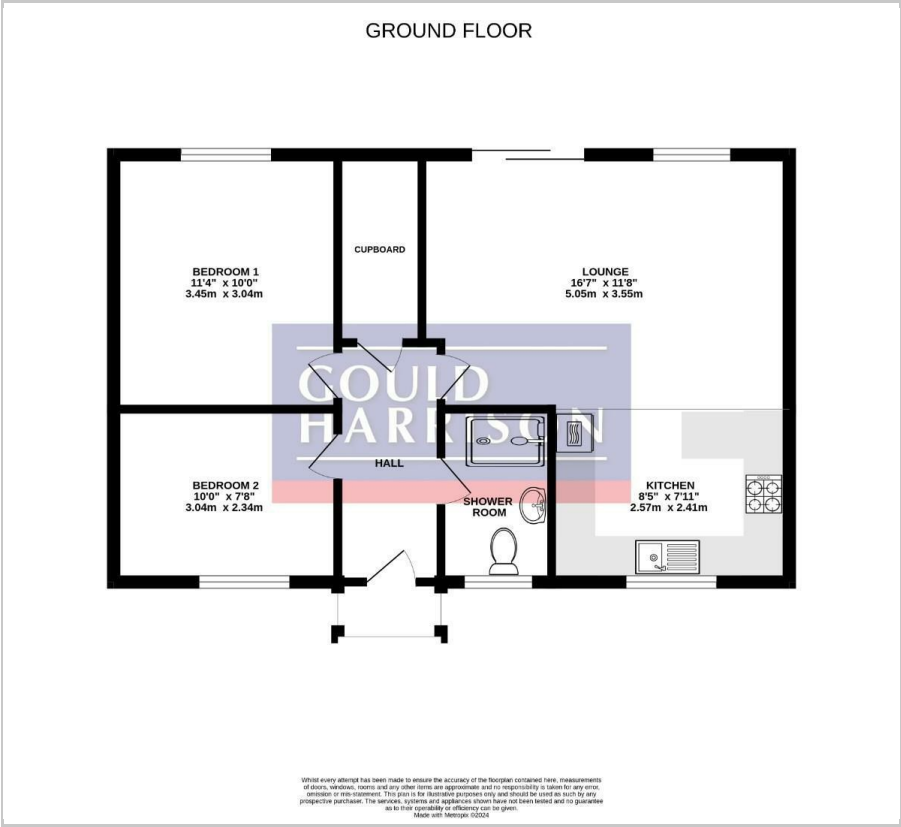

Area Map



Energy Efficiency Graph

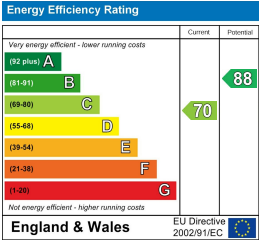

These particulars, whilst believed to be accurate are set out as a general outline only for guidance and do not constitute any part of an offer or contract. Intending purchasers should not rely on them as statements of representation of fact, but must satisfy themselves by inspection or otherwise as to their accuracy. No person in this firms employment has the authority to make or give any representation or warranty in respect of the property.