

76 Betjeman Way, Cleobury Mortimer

Guide Price £280,000

3 2 1



- Quote PC0649 Agent - Phil Cook.
- Three Bedroom Semi-Detached Modern Home
- Good Sized Lounge and Kitchen/Dining Room
- Private Driveway with Space for Two Vehicles
- Early Viewing Advised to Avoid Missing Out
- Hit 'Request Details'/'Email Agent' to secure a viewing now!
- Lovely Double Fronted Style with Good Sized Gardens to the rear
- Well Positioned to the Edge of the Development
- Excellent Cleobury Mortimer Location Near to all Local Amenities
- Hit 'Request Details'/'Email Agent' to secure a viewing now!

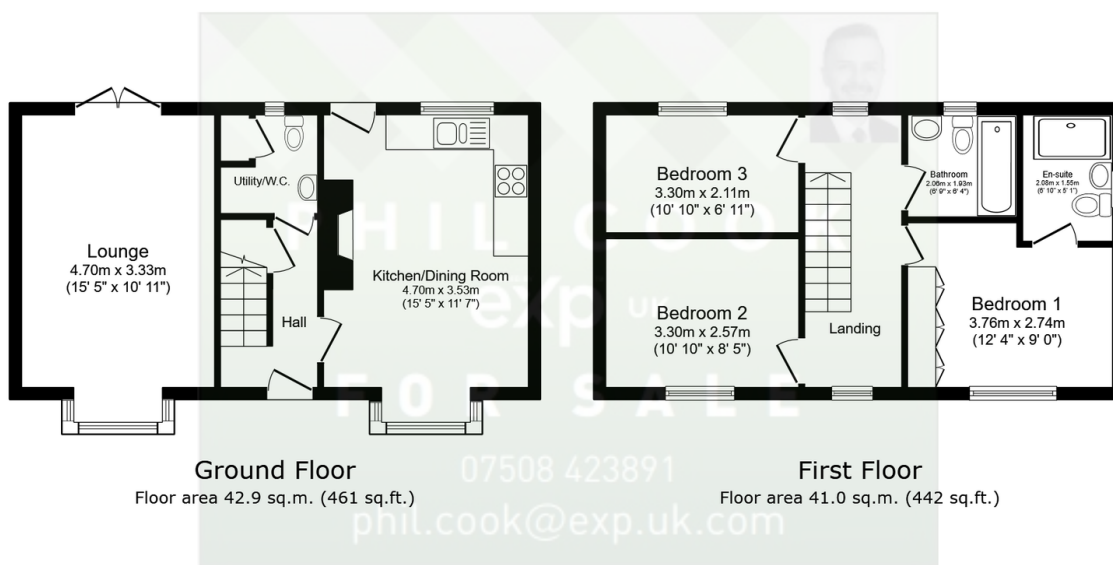

Total floor area: 83.9 sq.m. (903 sq.ft.)

This floor plan is for illustrative purposes only. It is not drawn to scale. Any measurements, floor areas (including any total floor area), openings and orientations are approximate. No details are guaranteed, they cannot be relied upon for any purpose and do not form any part of any agreement. No liability is taken for any error, omission or misstatement. A party must rely upon its own inspection(s). Powered by www.Propertybox.io