

24 Ronaldsway, Rhyl, LL18 2LB

£168,000

 2
  1
  1



For sale is this two-bedroom semi-detached bungalow located in a popular residential area in south Rhyl, suited to a variety of buyers. The property offers two double bedrooms, two reception rooms, bathroom, kitchen, together with a conservatory that provides additional living space and views over the south-facing rear garden. The bungalow benefits from a charming, enclosed garden, offering outdoor space for relaxation or entertaining, as well as ample off-street parking. The layout and proportions support comfortable single-storey living. Situated in South Rhyl, the property is well placed for local amenities including supermarkets, independent shops and services found in and around Rhyl town centre.

Key Features

- Two bedroom semi detached bungalow
- South-facing enclosed rear garden
- Popular residential area south Rhyl
- Would suite variety of buyers
- Freehold
- Two reception rooms plus conservatory
- Ample off-street parking
- Close to town centre amenities
- EPC - / Council tax - C
- Date: 06/05/2026

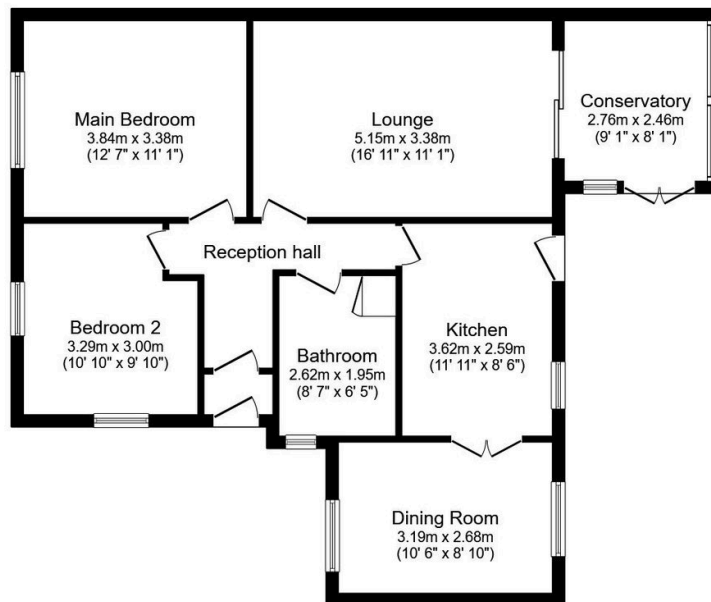

Floor Plan

Floor area 80.5 sq.m. (867 sq.ft.)

Total floor area: 80.5 sq.m. (867 sq.ft.)

This floor plan is for illustrative purposes only. It is not drawn to scale. Any measurements, floor areas (including any total floor area), openings and orientations are approximate. No details are guaranteed, they cannot be relied upon for any purpose and do not form any part of any agreement. No liability is taken for any error, omission or misstatement. A party must rely upon its own inspection(s). Powered by www.Propertybox.io