



Portinscale Road, SW15

£525,000

Dexters



Portinscale Road, SW15

This 795 sqft, two-bedroom, first-floor apartment is set within this well-maintained residential building just off West Hill. This spacious property comprises two generous double bedrooms, a light and spacious living room benefiting from large floor to ceiling windows and original parquet flooring. The flat also has a separate fitted kitchen with integrated appliances, bathroom and a separate w.c. The property also benefits from a beautifully kept communal garden.

Burton Lodge is located just moments away from a variety of Putney's trendy shops, bars and restaurants not forgetting excellent transport links in and out of London.

Features

- 795 sqft
- Two Bedrooms
- Parquet Flooring
- Communal Gardens
- On Site Permit Parking
- Share of Freehold







Portinscale Road, London, SW15

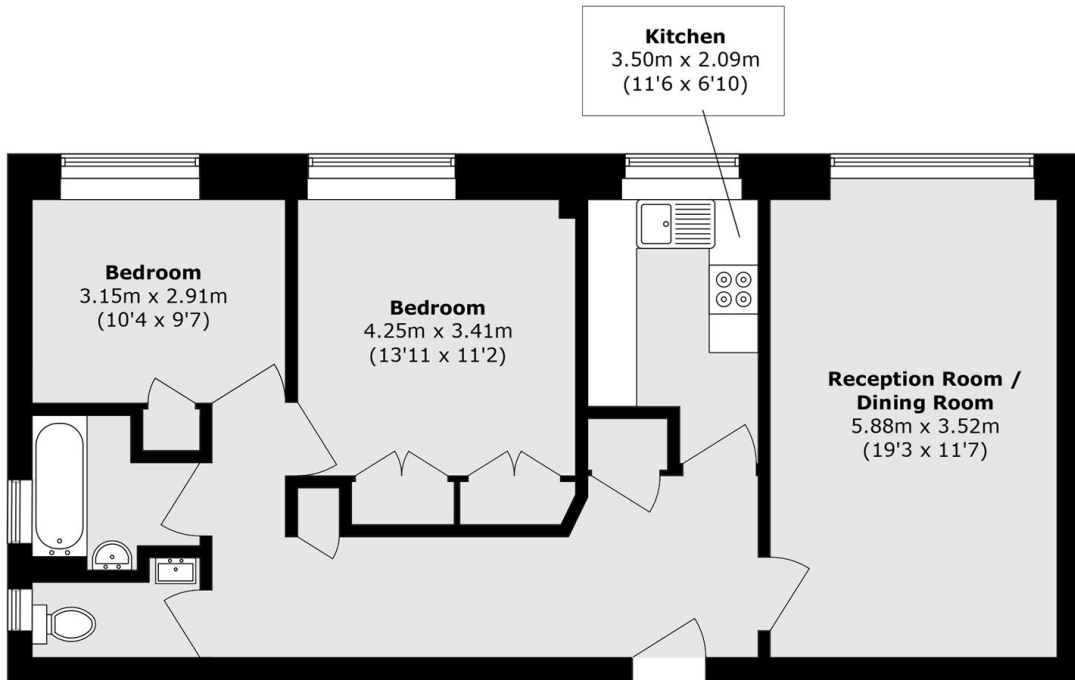

Total area (approx.): 73.9 sq. m (795.4 sq. ft)