

Yeolland Lane, Ivybridge

Guide Price £190,000

🛏 2 🚿 1 🚿 1



- Well-presented two-bedroom cluster home
- Bright and spacious lounge/diner
- Contemporary family bathroom with shower over bath
- Approx. 562 sq ft of internal accommodation
- Ideal for first-time buyers, downsizers or investors
- Garage and parking
- Modern fitted kitchen with high-gloss units and integral appliances
- Neutral décor throughout – move-in ready
- Quiet residential location
- Convenient for local amenities, schools and transport links

Approx Gross Internal Area
52 sq m / 562 sq ft

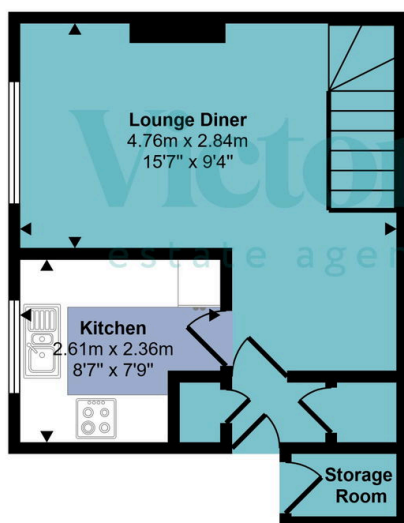

Ground Floor
Approx 27 sq m / 289 sq ft

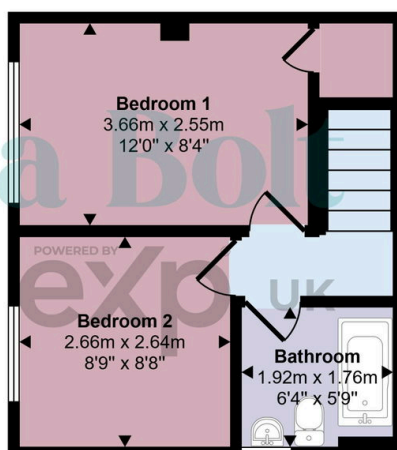

First Floor
Approx 25 sq m / 273 sq ft

This floorplan is only for illustrative purposes and is not to scale. Measurements of rooms, doors, windows, and any items are approximate and no responsibility is taken for any error, omission or mis-statement. Icons of items such as bathroom suites are representations only and may not look like the real items. Made with Made Snappy 360.

A modern and well-maintained two-bedroom cluster home in a popular Ivybridge location, offering a bright lounge/diner, stylish kitchen and contemporary bathroom. An excellent opportunity for first-time buyers, downsizers or investors alike.