



**For Sale**

**19 Purdy Close, Upper Lighthorne**

**£192,000**

 **3**

 **1**

 **2**

**\*\*\* MODERN SHARED OWNERSHIP TERRACE PROPERTY SET IN POPULAR LOCATION AND CLOSE TO ALL LOCAL AMENITIES \*\*\***

... MODERN SHARED OWNERSHIP TERRACE PROPERTY SET IN POPULAR LOCATION AND CLOSE TO ALL LOCAL AMENITIES ...

This property was built just over three years ago so has over 6 years of its NHBC remaining and is ideally located for Leamington Spa, Warwick, Banbury and Stratford Upon Avon and is a stone's throw from Jaguar Land Rover and Aston Martin as well as the M40.

The property is ideal for a first-time buyer's, a family or someone looking to stay on the property ladder, it is superbly presented from top to bottom and is ready to move straight into.

In brief on the ground floor the property comprises of; entrance, which is open plan into your living room, kitchen / dining area with plenty of space for a dining table and with access to under stairs storage cupboard, it also has access to downstairs WC / utility area and the enclosed rear garden.

Upstairs you have a very good-sized master bedroom, with built in storage over the stairs, it also has two further double bedrooms and there is a white modern family bathroom suite with



**Nathaniel Cleaver**

07793 363210

nathaniel@thepropertyexperts.co.uk



**The Property Experts UK**

01926436105

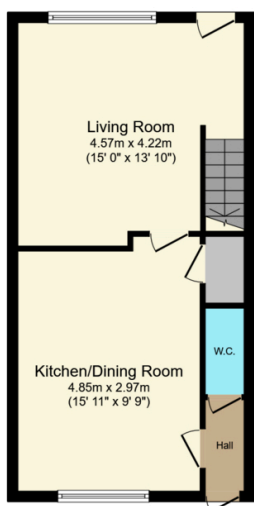

**Ground Floor**  
Floor area 43.3 sq.m. (466 sq.ft.)

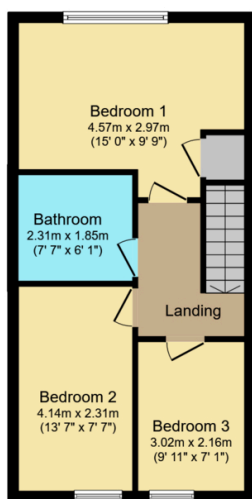

**First Floor**  
Floor area 43.3 sq.m. (466 sq.ft.)

Total floor area: 86.6 sq.m. (932 sq.ft.)

This floor plan is for illustrative purposes only. It is not drawn to scale. Any measurements, floor areas (including any total floor area), openings and orientations are approximate. No details are guaranteed; they cannot be relied upon for any purpose and do not form any part of any agreement. No liability is taken for any error, omission or misstatement. A party must rely upon its own inspection(s). Powered by www.Propertybox.io

- Modern 60% Shared Ownership Property
- Mid Terrace
- Three Double Bedrooms
- Living Room
- Kitchen / Dining Area
- Downstairs WC
- Allocated Parking For 2 Cars
- Enclosed West Facing Rear Garden With Rear Access
- Close To All Local Amenities & Transport Links
- EPC Rating - B

