

abbotFox



Foulsham, NR20
Offers In Excess Of £270,000

“

We are a team of genuine individuals who hold a deep passion for both property and marketing. Collectively, we bring over 70 years of experience in the property market of Norfolk and Suffolk. Our affection for both counties runs deep, and we are enthusiastic about sharing our passion with you.

Colin McKenzie | **Branch Partner**







THE DETAIL_____

abbotFox presents Bethany, a charming period home set within the heart of the historic and well connected village of Foulsham. Rich in character and thoughtfully maintained, this delightful cottage offers an inviting blend of traditional features and modern comfort.

Stepping inside, the accommodation unfolds with a warm and welcoming sitting room, enhanced by exposed beams and a feature fireplace that forms the centrepiece of the space. A well appointed kitchen diner provides generous work surfaces and storage, creating an ideal setting for everyday living. The ground floor is completed with the stunning addition of a garden room, which can be utilised for many different purposes. The first floor offers two well proportioned bedrooms, each enjoying a peaceful outlook, and is complemented by a modern bathroom.

Outside, the cottage benefits from an attractive garden, offering a private and tranquil spot perfect for outdoor dining, gardening, or simply unwinding. with off road parking to the front. Positioned along The Street, the property enjoys easy access to local amenities while maintaining the calm and characterful charm for which Foulsham is renowned.

With its blend of period charm, practical accommodation and desirable village setting, this home demands an internal inspection to be appreciated.







THE HIGHLIGHTS____

- Semi-detached cottage
- Off road parking
- Two bedrooms
- Generous living accommodation
- Sought after village setting
- Enclosed private gardens
- Character features throughout
- Internal viewing advised

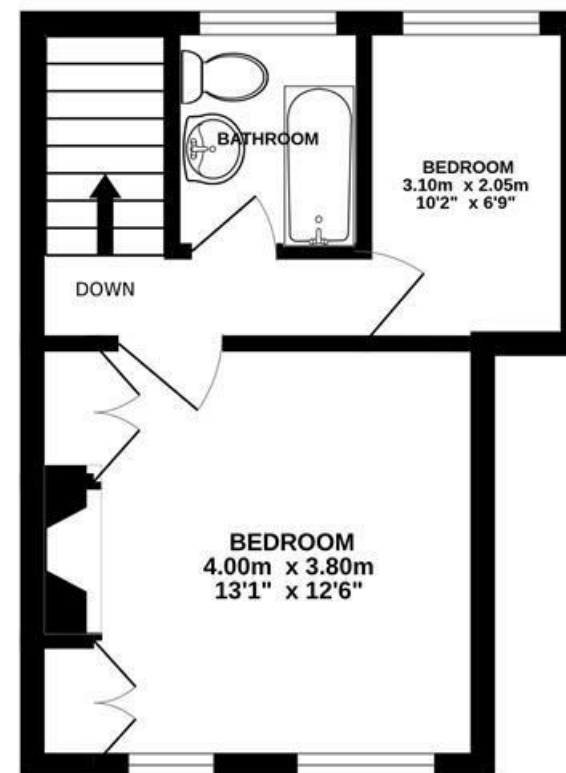
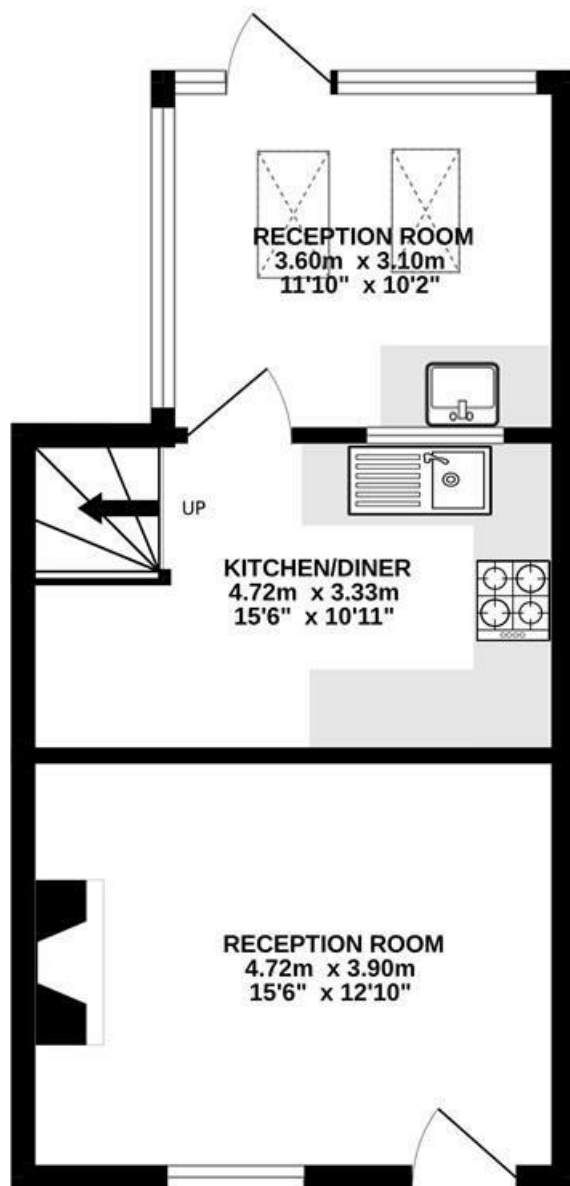

Let's talk

01603 660000

sales@abbotfox.co.uk

@abbotfox

EPC RATING -

Disclaimer – In accordance with the Property Misdescriptions Act, the company abbotFox gives notice that all descriptions, references to condition, necessary permissions for use and other details are given in good faith and believed to be correct, but any purchaser should not rely on them as statements of fact, and must satisfy themselves by inspection or other means, as to their accuracy.