



ICONIC
ESTATE AGENTS

Westwood Drive, Hellesdon
Guide Price £280,000 - £290,000 Freehold



- Semi Detached Bungalow
- Three Well Proportioned Bedrooms
- Fitted Kitchen
- Spacious Sitting Room
- Conservatory
- Generous Private Rear Garden
- Garage & Adjoining Outhouse
- Popular Hellesdon Location
- Offered With No Onward Chain
- EPC Rating D / Council Tax Band C



GROUND FLOOR
805 sq.ft. (74.7 sq.m.) approx.

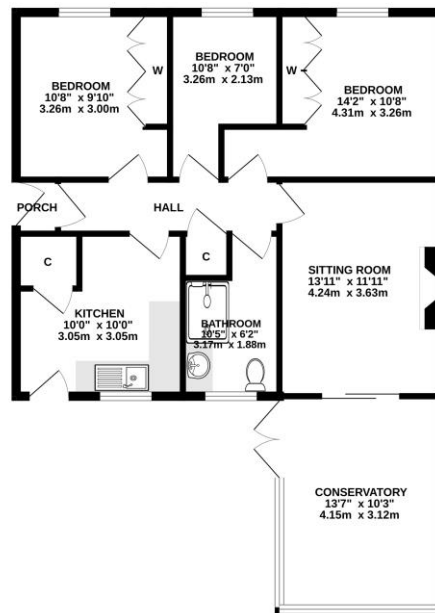

TOTAL FLOOR AREA: 805 sq.ft. (74.7 sq.m.) approx.
Whilst every attempt has been made to ensure the accuracy of the description contained herein, measurements of areas, volumes, rooms and any other items are approximate and no responsibility is taken for any misrepresentation or misstatement. This plan is for illustrative purposes only and should be used as such by any prospective purchaser. The services, systems and appliances shown have not been tested and no guarantee is given in their condition or otherwise. See for details.
Made with Floorplan 3.0.0.0

Leave Norwich via the A0167 Drayton Road and continue onto Drayton High Road, follow the road taking the right hand turn onto Drayton Wood Road. Follow the road taking the first left onto Westwood Drive where the property can be found on the right hand side.

Viewings strictly by appointment with: 297 Fakenham Road, Norwich, NR8 6LE

Taverham **01603 261104**
Norwich **01603 740044**

rightmove

zoopla

onTheMarket.com

THE GUILD
PROPERTY
PROFESSIONALS

We bring to prospective purchasers attention that we, as estate agents for the property, have not tested any appliances and purchasers should make their own enquiries of the relevant Authorities regarding the connection and viability of all services. These particulars, whilst believed to be accurate are set out as a general outline only for guidance and do not constitute any part of an offer or contract. Intending purchasers should not rely on them as statements of representation of fact, but must satisfy themselves by inspection or otherwise as to their accuracy.