



# Crews Street

London, E14

Asking Price £375,000

A stylish 11th floor one bedroom apartment, with a fully integrated kitchen and a private balcony offering exceptional view over the River Thames. Facilities include access to a communal gym and 24hr concierge service.



# Crews Street

## London, E14

- One Bedroom | 590sq ft Internal Living Space
- 11th Floor Apartment
- Expansive River Views
- EWS1 Certificate Pass
- 24 Hour Concierge
- Residents Gym
- Popular Canary Wharf Development



This stunning one bedroom apartment in Orion Point has stunning floor to ceiling windows looking out onto the River Thames.

The property boasts 590sqft of riverside living on the 11th floor. The open-plan, kitchen/reception room is bright and spacious with wooden floors and underfloor heating throughout.

The Odyssey development offers a 24 hour Concierge, resident only gym facilities and is close to local shops with the Canary Wharf shopping malls.

Canary Wharf offers the Jubilee underground, DLR and Crossrail all of which provide fast access to Stratford; City Airport; The City; Central London; West End and beyond.

**Tenure:** Leasehold 100 years approx. remaining.

**Service Charge:** £4,304 pa approx.

**Ground Rent:** £247 pa. Increased in line with the review value of the block and the clause in the Lease.

**Local Authority:** Tower Hamlets

**Council Tax Band:** E

Score	Energy rating	Current	Potential
92+	A		
81-91	B	83 B	83 B
69-80	C		
55-68	D		
39-54	E		
21-38	F		
1-20	G		

### *Chestertons Canary Wharf & Greenwich Sales*

Harbour Island  
 28 Harbour Exchange Square  
 London  
 E14 9GE  
 canarywharf@chestertons.co.uk  
 020 7510 8300  
 chestertons.co.uk

Orion Point,  
Crews Street, E14

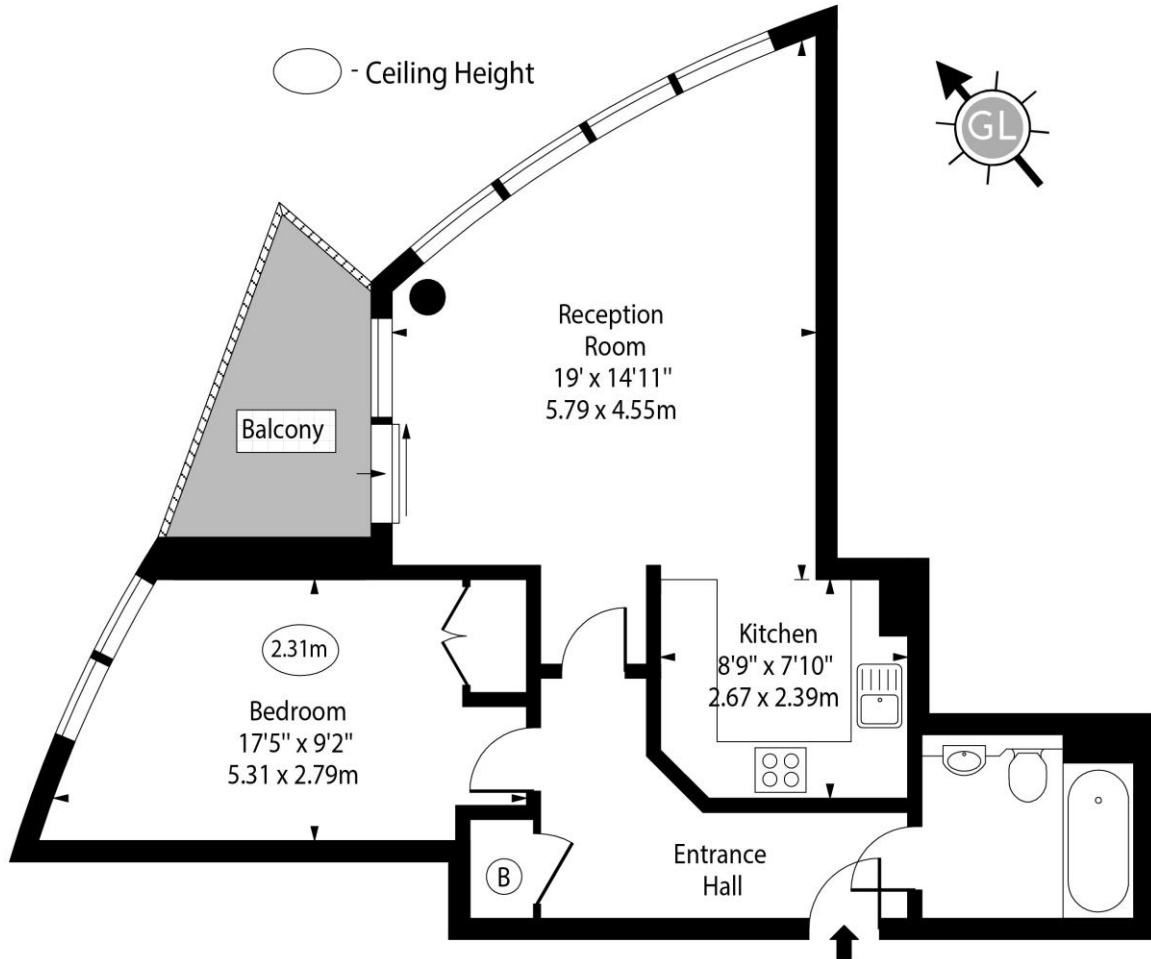

Eleventh Floor

Approx Gross Internal Area      590 Sq Ft - 54.81 Sq M

Every attempt has been made to ensure the accuracy of the floor plan shown. However, all measurements, fixtures, fittings, and data shown are approximate interpretations and for illustrative purposes only. Measured according to the RICS. Not To Scale.

[www.goldlens.co.uk](http://www.goldlens.co.uk)  
Ref. No. 028886E