



Constables
SALES & LETTINGS

Croft Green

Bromborough, Wirral

£175,000

Offered for sale with no onward chain.
A two bedroom mid-terraced property located in a
cul-de-sac just off New Chester Road in
Bromborough. The property is conveniently situated
for local amenities and transport links.
The accommodation comprises, hallway, lounge,
kitchen-dining room, two bedrooms and a bathroom.
Externally there is a driveway and at the rear is a low
maintenance garden and decked area.

*I can do all things
through Christ
who strengthens me*





Constables

SALES & LETTINGS

- Two Bedroom Mid-Terraced Property
- Lounge & Kitchen Dining Room
- Enclosed Rear Garden
- Cul-De-Sac Location
- Two Double Bedrooms
- No Onward Chain
- Close to amenities and transport links
- Off Road Parking

Hallway

Lounge

14'7" x 9'8" extending to 12'11"
(4.45m x 2.97m extending to
3.94m)

Kitchen-Dining Room

9'2" x 12'10" (2.8m x 3.93m)

Landing

Bedroom One

12'11" max reducing to 9'9" x 12'6"
max (3.94m max reducing to
2.99m x 3.82m max)

Bedroom Two

11'2" x 7'10" (3.42m x 2.40m)

Bathroom

8'9" x 4'9" (2.68m x 1.47m)





EPC & Floor Plan

Energy Efficiency Rating		
	Current	Potential
<i>Very energy efficient - lower running costs</i>		
(92 plus) A		90
(81-91) B		
(69-80) C	69	
(55-68) D		
(39-54) E		
(21-38) F		
(1-20) G		
<i>Not energy efficient - higher running costs</i>		
England & Wales	EU Directive 2002/91/EC	

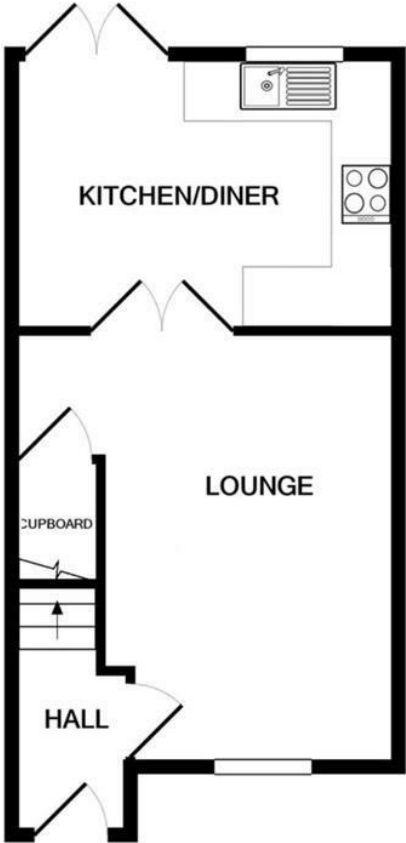

GROUND FLOOR

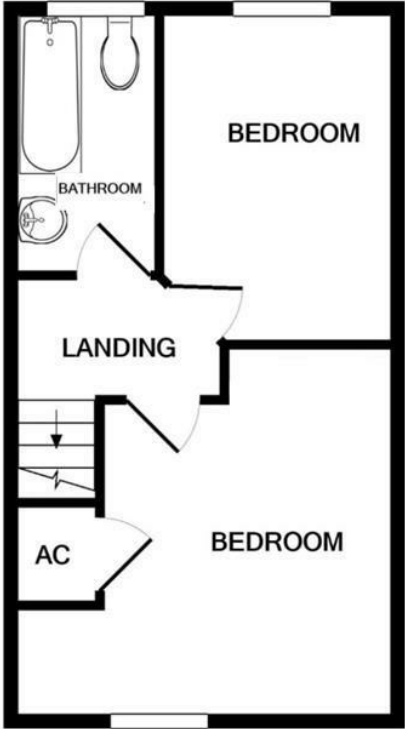

FIRST FLOOR

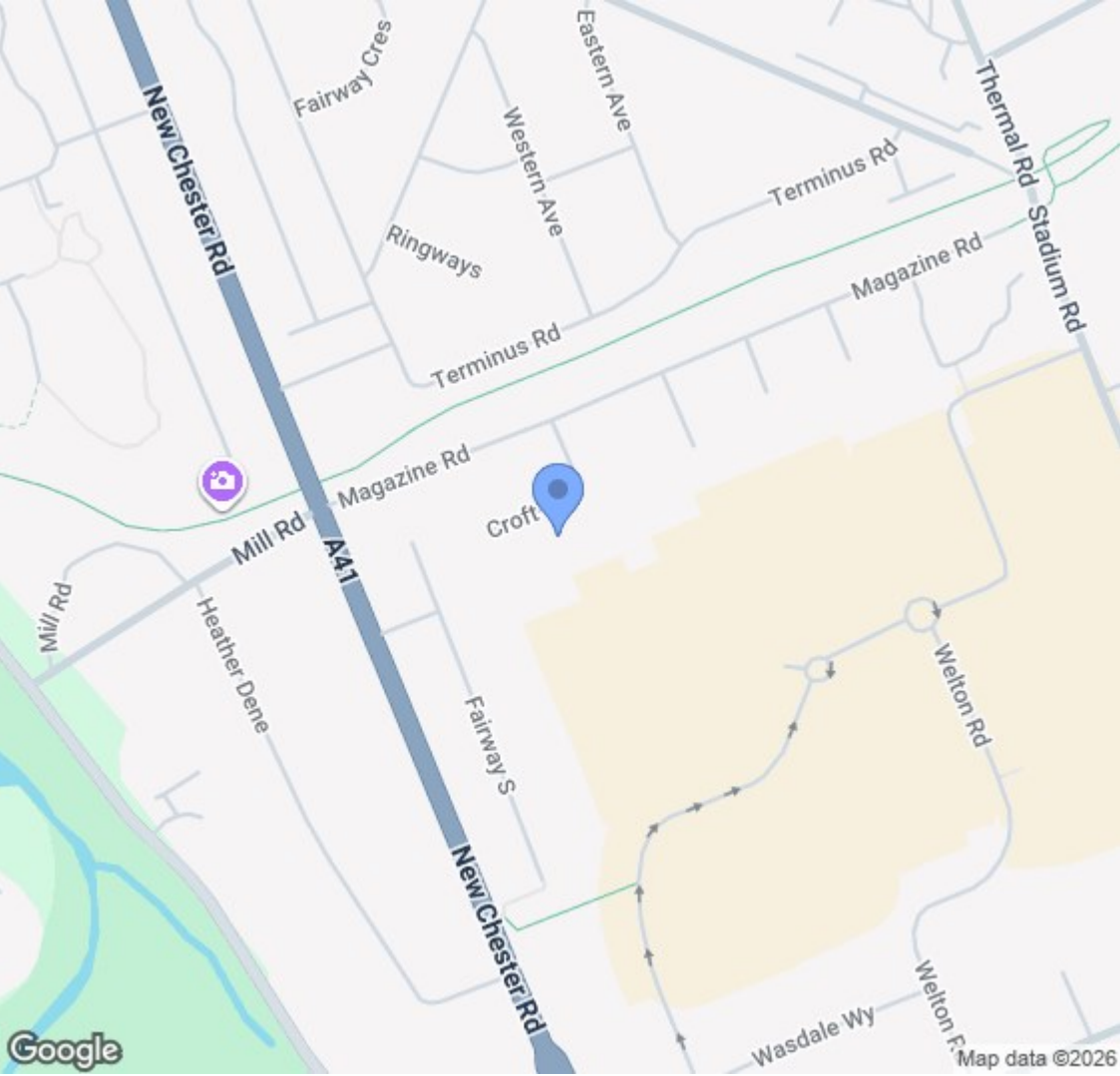
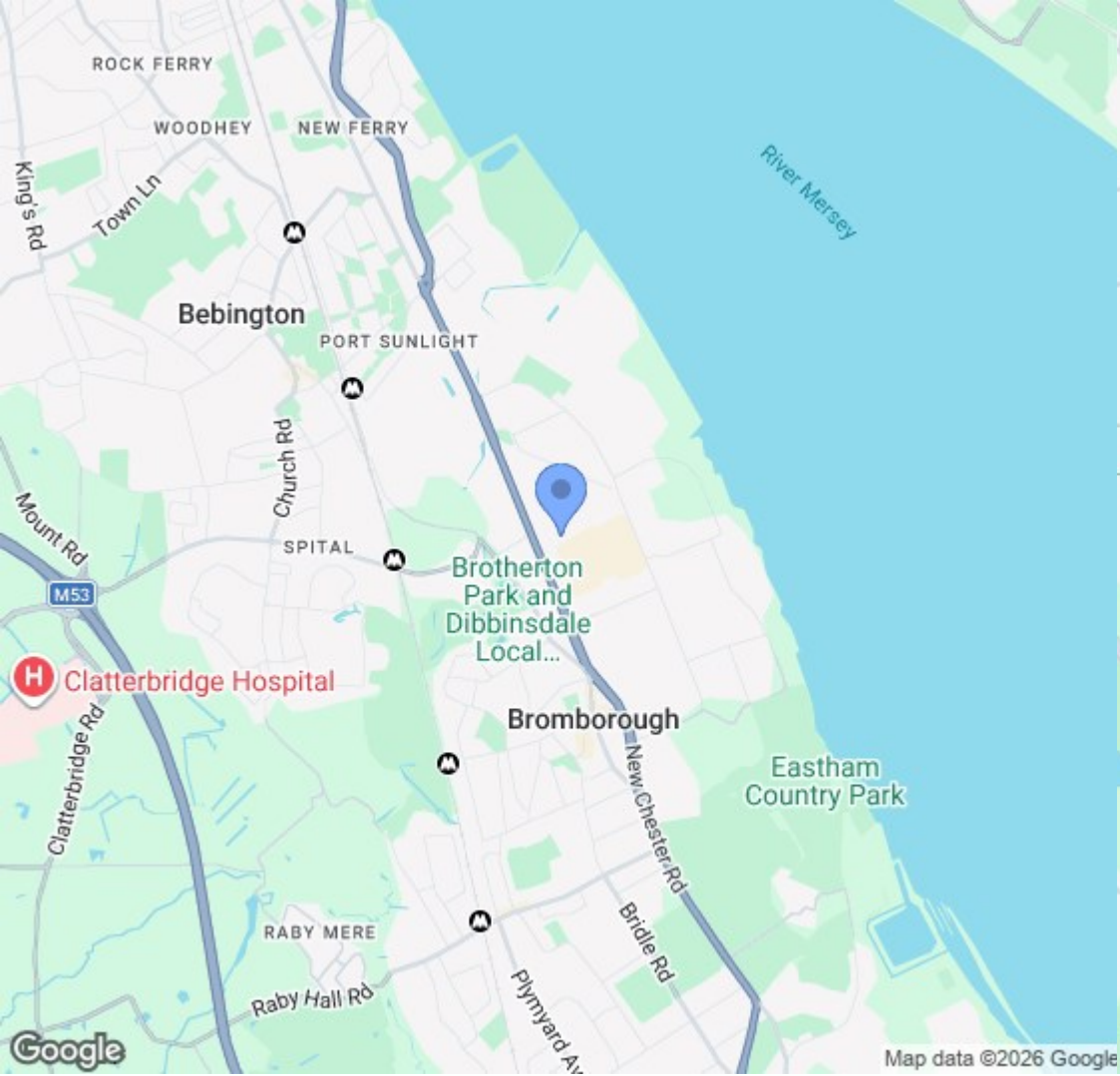

Location Map

Constables

S A L E S & L E T T I N G S

21 High Street, Neston

South Wirral, Neston, Cheshire

www.constablesestateagents.co.uk

info@constablesestateagents.co.uk

0151 353 1333