



**POOLE  
TOWNSEND**

# Foxfield Road, Walney, Barrow-in-furness, LA14 3SJ

£195,000

2 1 1



- 2 Bed Semi-Detached Bungalow
- Good Sized Plot
- Driveway And Garage
- Gas Fired Central Heating
- Council Tax Band - B
- Sought After Location
- Gardens Front And Rear
- Two Bedrooms
- UPVC Double Glazing Throughout
- NO UPPER CHAIN!



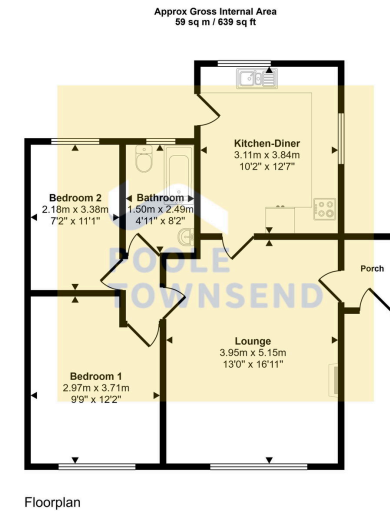

This floorplan is only for illustrative purposes and is not to scale. Measurements of rooms, doors, windows, and any items are approximate and no responsibility is taken for any error, omission or mis-statement. Icons of items such as bathroom suites are representations only and may not look like the real items. Made with Made Snappy 360.

NEW This nicely presented bungalow is located in the ever popular North Scale area of Walney. The property is set on a nice sized plot with an enclosed garden to the front, gated driveway leading to a garage and further enclosed garden to the rear with lawn and patio areas. The accommodation features a nicely proportioned lounge with large window overlooking the front garden, a kitchen/dining room, inner hallway, two bedrooms and a bathroom with a shower installed over the bath. The bungalow also benefits from having a gas-fired central heating system, UPVC framed double glazing throughout and no upper chain.

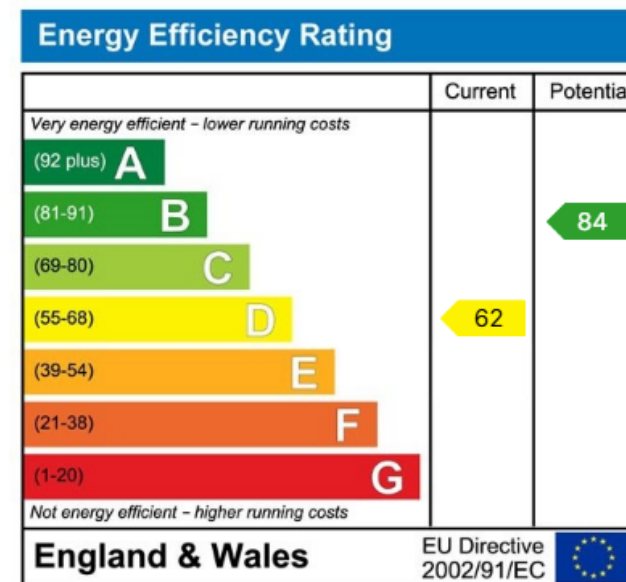

Visit us at  
[www.pooletownsend.co.uk](http://www.pooletownsend.co.uk)  
[enquiries@pooletownsend.co.uk](mailto:enquiries@pooletownsend.co.uk)

We are open  
 Monday – Friday 9.00 – 5.00  
 Saturday 9.00 – 1.00

Barrow 01229 811811  
 Ulverston 01229 588111  
 Grange 015395 33316  
 Kendal 01539 734455  
 Milnthorpe 015395 62044