



CHARLWOOD STREET, SW1V

£1,500,000

Three bedrooms
Private first floor entrance
Split-level apartment
Bright and spacious
Far reaching views
Energy rating: d

@marshandparsons
marshandparsons.co.uk

MARSH &
PARSONS



ABOUT THE PROPERTY

Set on one of Pimlico's most charming residential streets, this beautifully arranged three-bedroom split-level apartment offers a wonderful combination of space, light, and far-reaching views across the London skyline.

Accessed from the first floor and occupying the second and third floors above, the apartment has a natural sense of privacy and calm. The elevated position allows sunlight to pour through the home while framing some truly impressive views across the rooftops of London, creating an ever-changing backdrop from morning through to evening.



STEP INSIDE CHARLWOOD STREET

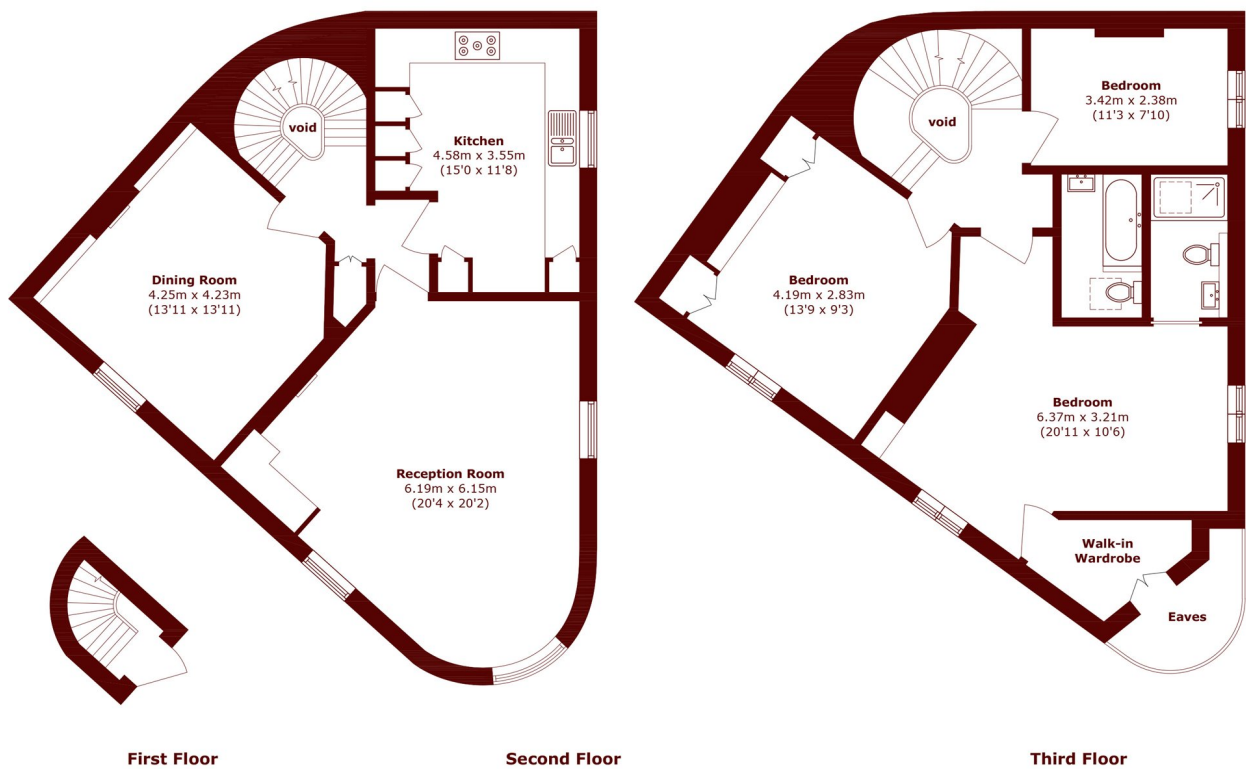

Total area (approx.): 141.5 sq. m (1523.1 sq. ft)
(Excluding Eaves & Void)

Pimlico & Westminster
020 7590 0800

Energy Rating: D We aim to make our particulars both accurate and reliable. However, they are not guaranteed; nor do they form part of an offer or contract. If you require clarification on any points then please contact us, especially if you're traveling some distance to view. Please note that appliances and heating systems have not been tested and therefore no warranties can be given as to their good working order

**MARSH &
PARSONS**