



Woodfield Place

London, W9

£2,250 per month
(£519.23 per week)

This modern one double bedroom apartment is situated on the ground floor within this impressive new development. The property comprises; spacious reception, modern eat-in kitchen, master bedroom and modern bathroom.

CHESTERTONS



Woodfield Place

London, W9

- Stylish New Build Apartment
- Spacious Reception With Separate Contemporary Kitchen
- Double Bedroom
- Modern Bathroom
- Moments To Westbourne Park Station
- EPC Rating B



This modern one double bedroom apartment is situated on the ground floor within this impressive new development. The property comprises; spacious reception, modern eat-in kitchen, master bedroom and modern bathroom.

This spacious apartment further benefits; wooden flooring, balcony, floor to ceilings windows and extremely spacious accommodation throughout.

Woodfield Place is located close to Westbourne Park underground station linking it conveniently to the City and moments away from local shops, restaurants and parks.

Minimum Term: 12 months
Deposit Required: 5 weeks
Local Authority: City of Westminster
Council Tax Band: D
EPC Rating: B
Unfurnished

Energy Efficiency Rating		
	Current	Potential
Very energy efficient - lower running costs		
(94-100) A		
(81-93) B	82	83
(69-80) C		
(55-68) D		
(39-54) E		
(21-38) F		
(1-20) G		
Not energy efficient - higher running costs		
England, Scotland & Wales EU Directive 2002/91/EC		

Chestertons Little Venice Lettings

26 Clifton Road
Maida Vale
London
W9 1SX
littlevenicelettingsusers@chestertons.co.uk
02072662369
chestertons.co.uk

Additional tenant charges apply (fees apply to non-AST tenancies only)
Tenancy Agreement Fee: £300
References per Tenant/Guarantor: £60
Inventory check (approx. £100 – £250 inc. VAT)
chestertons.co.uk/property-to-rent/applicable-fees

The Harland, Woodfield Place, W9

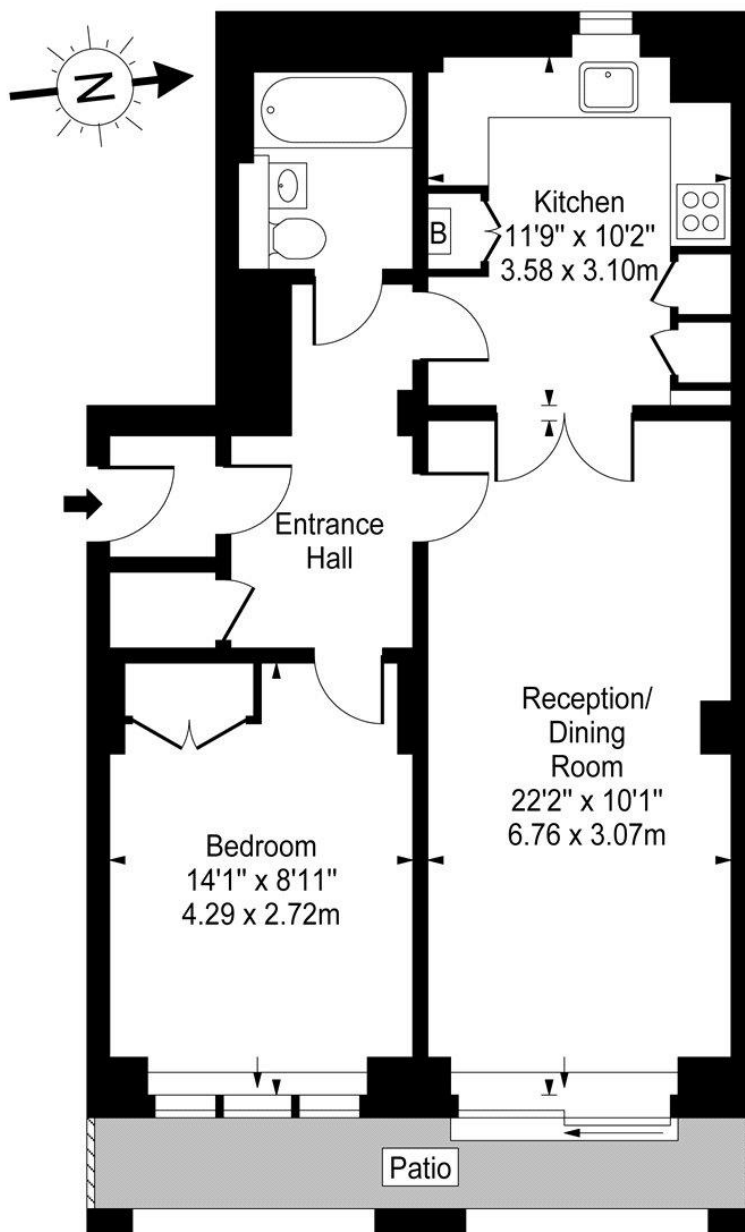

Ground Floor

Approx Gross Internal Area **625 Sq Ft - 58.06 Sq M**

For Illustration Purposes Only - Not To Scale

www.goldlens.co.uk

Ref. No. 005432M

