



# Castles

ASKING PRICE

**£475,000**

**Carterhatch Road**

Enfield, EN3 5ED    Freehold



## PROPERTY SUMMARY

Castles are delighted to present this well-maintained three-bedroom semi-detached house, ideally located on the ever-popular Carterhatch Road. This spacious home offers excellent accommodation throughout and benefits from a side garage, providing further parking or storage options.

The ground floor features a bright and welcoming reception room, a generous fitted kitchen, and a dining area with direct access to the rear garden—ideal for both everyday living and entertaining. Upstairs comprises three well-proportioned bedrooms and a modern family bathroom. Externally, the property boasts a private driveway, a side garage, and a sizeable rear garden offering a great outdoor space for families. The home is conveniently positioned within close proximity to Brimsdown train station array of shops, amenities, and transport links, as well as local schools, parks, and major road networks including the A10 and M25.

This is a fantastic opportunity to secure a well-located and spacious family home in a highly sought-after area Chain Free Early viewing is recommended.









APPROXIMATE GROSS INTERNAL AREA  
95.73 sqm / 1030.42 sqft (Excluding Storage)  
120.43 sqm / 1296.29 sqft (Including Storage)

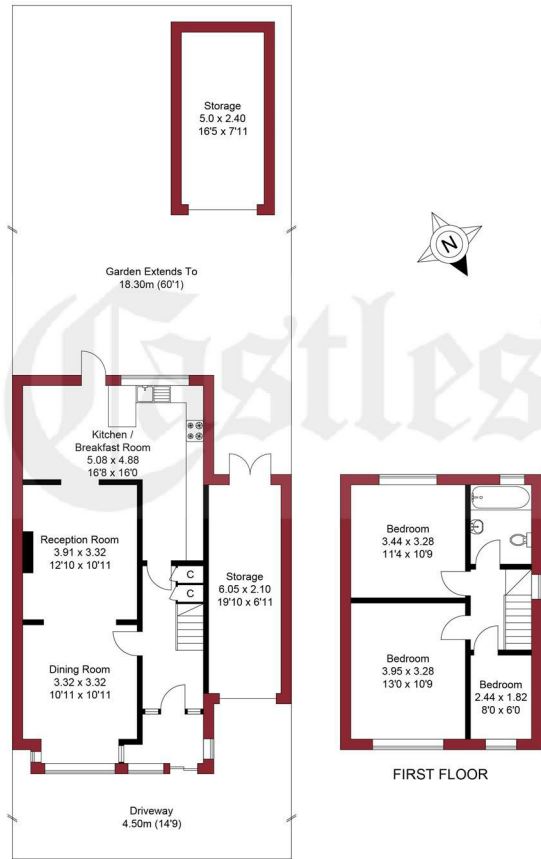

GROUND FLOOR

FIRST FLOOR

THIS PLAN IS FOR ILLUSTRATION ONLY AND MAY NOT BE  
REPRESENTATIVE OF THE PROPERTY

For a guide to the area  
please scan this code for  
more information

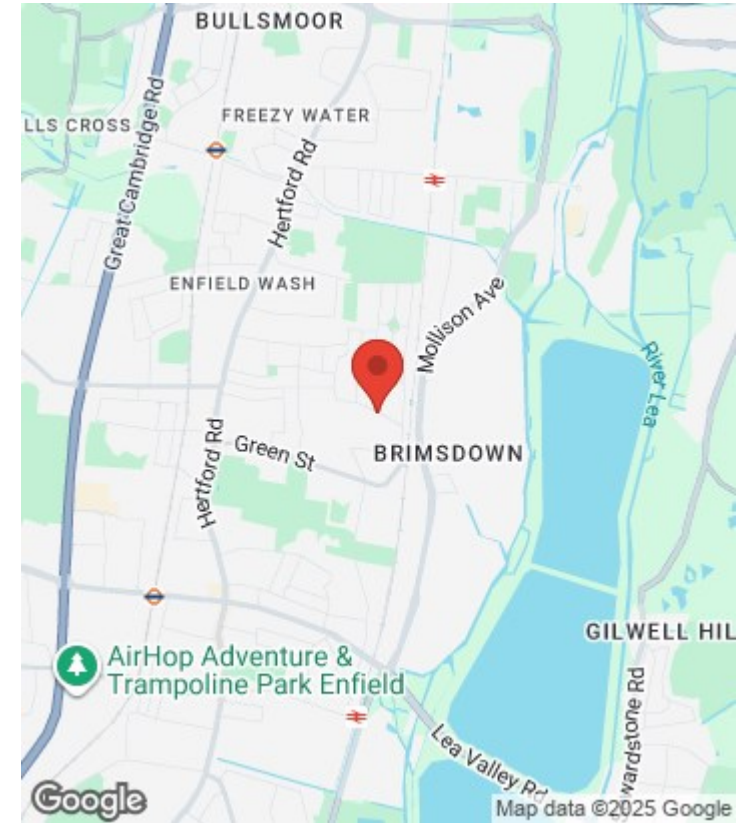

House

Freehold

**Council:** Enfield

**Council Tax Band:** D

Agents Note: Whilst every care has been taken to prepare these particulars, they are for guidance purposes only. All measurements are approximate and are for general guidance purposes only and whilst every care has been taken to ensure their accuracy, they should not be relied upon and potential buyers/tenants are advised to recheck the measurements



#### OFFICE ADDRESS

243 - 245 Hertford Road  
Enfield  
London  
EN3 5JJ

#### OFFICE DETAILS

0208 804 8000  
enfield@castles.london  
<https://www.castles.london>

