



Crown Apartments, Dryland Street, Kettering **Leasehold** £175,000 O.I.E.O.

**Pattison  
Lane**

# Key Features



- Three Bedroom Penthouse Apartment
- Master En-suite and a separate modern bathroom
- Circa 1,600 sq. ft. of beautifully presented accommodation
- Expansive Roof Terrace with artificial lawn and stunning views
- Refitted High-Spec Kitchen with all appliances included
- Secure Gated Parking with electronic remote access
- Prime Central Location within walking distance to all local amenities
- Main Line Rail Links and Main Road Links

\*circa 1,600 Sq Feet\* Occupying a commanding position with panoramic views across the town skyline-including a direct, picturesque outlook toward the church spire-this magnificent penthouse apartment offers a rare combination of sheer scale, modern luxury, and outdoor tranquillity.

Spanning approximately 1,600 square feet, this residence has been meticulously maintained and upgraded to offer a lifestyle of effortless sophistication.



### The Living Space

The heart of the home is an expansive, open-plan lounge and dining room. Flooded with natural light from multiple elevations, the space features elegant herringbone flooring and provides a seamless flow for both daily living and grand-scale entertaining. Directly accessible from the living area is the private roof terrace. A true urban oasis, this outdoor space is large enough for full-sized alfresco dining sets or sun loungers, offering a secluded spot to enjoy the sunset over the horizon.

### Gourmet Kitchen

The kitchen has been masterfully refitted to a high specification. It boasts sleek, handleless cabinetry, premium marble-effect worktops, and a full suite of integrated appliances. The layout is as functional as it is stylish, designed to satisfy the most demanding of home chefs.

### Bedrooms & Versatile Spaces

**Master Suite:** An impressive sanctuary featuring generous proportions, fitted wardrobes, and a dedicated modern en-suite shower room finished with contemporary tiling and fixtures.

**Two Further Bedrooms:** Well-appointed and spacious, served by a pristine principal family bathroom including a laundry cupboard with both washing machine and tumble dryer.

**Additional Eaves Rooms:** Unique to this penthouse are two further rooms located in the eaves. While subject to height restrictions, these serve as invaluable "bonus" spaces, perfect for a home office, hobby room, or climate-controlled storage.

### Security & Parking

Peace of mind is paramount, with the property benefiting from secure garage-style parking. Access is provided via a remote-controlled electronic gated entrance, ensuring both privacy and convenience in a central location.

Properties of this stature and finish are exceptionally rare to the market. An early internal viewing is essential to fully appreciate the space and quality on offer.



1600 sq.ft. (148.6 sq.m.) approx.

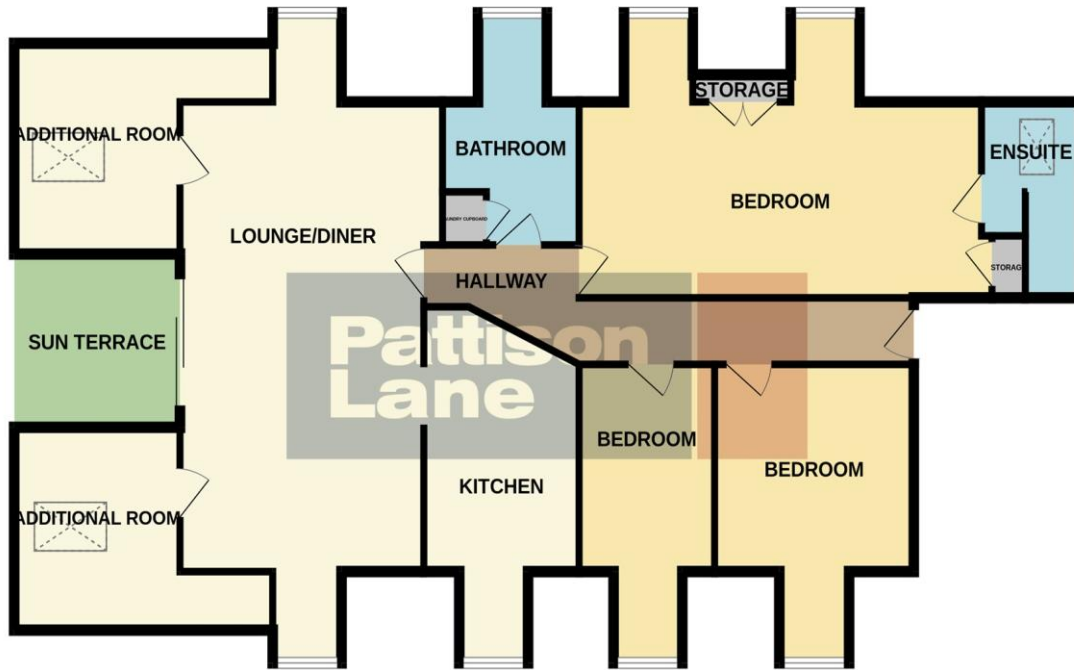

TOTAL FLOOR AREA: 1600 sq.ft. (148.6 sq.m.) approx.  
Whilst every attempt has been made to ensure the accuracy of the floorplan contained here, measurements of doors, windows, rooms and any other items are approximate and no responsibility is taken for any error, omission or mis-statement. This plan is for illustrative purposes only and should be used as such by any prospective purchaser. The services, systems and appliances shown have not been tested and no guarantee as to their operability or efficiency can be given.  
Made with Metropix ©2026

The accommodation comprises:

OPEN PLAN LIVING / DINING ROOM 24'2 plus bay x 14'7 max (7.36m x 4.44m)

BALCONY

KITCHEN 8'8 max x 13'8 max (2.64m x 4.16m)

BEDROOM ONE 10'1 plus bay x 18'10 max (3.07m x 5.74m)

EN SUITE

BEDROOM TWO 11'1 x 10'2 plus bay (3.37m x 3.09m)

BEDROOM THREE 7'6 max x 12'2 max (2.28m x 3.70m)

BATHROOM

OUTSIDE

OFF ROAD PARKING / GARAGE (Shared)

AGENTS NOTE:

Length of lease - 125 years lease one day from 1 January 2004

Annual Ground Rent - £350.00

Annual Service Charge - £2649.28

There are two additional rooms shown on the floorplan with restricted head height.

To view this property call Pattison Lane on:  
**01536 524425**



# Selling your property?

Contact us to arrange a **FREE** home valuation.

 01536 524425

 68-70 Gold Street, Kettering, Northamptonshire, NN16 8JB

 [kettering@pattisonlane.co.uk](mailto:kettering@pattisonlane.co.uk)

 [www.pattisonlane.co.uk](http://www.pattisonlane.co.uk)



 SCAN ME



Sharman Quinney Holdings Limited is registered in England and Wales under company number 4174227, Registered Office is Cumbria House, 16-20 Hockliffe Street, Leighton Buzzard, Bedfordshire, LU7 1GN. VAT Registration Number is 500 2481 05.

1: These particulars do not constitute part or all of an offer or contract. 2: The measurements indicated are supplied for guidance only and as such must be considered incorrect. 3: Potential buyers are advised to recheck the measurements before committing to any expense. 4: Sharman Quinney has not tested any apparatus, equipment, fixtures, fittings or services and it is the buyers interests to check the working condition of any appliances. 5: Sharman Quinney has not sought to verify the legal title of the property and buyers must obtain verification from their legal representative. 6: Intending purchasers will be asked to produce identification documentation at a later stage and we would ask your co-operation in order that there will be no delay in agreeing the sale. Ref: KPL206708 - 0006