



2



1



1



D





Key Features

- Beautifully refurbished detached two-bedroom bungalow
- Generous corner plot position
- Stylish Shaker-style kitchen with solid wood worktops
- Contemporary bathroom with bath and separate shower
- Light and well-balanced accommodation throughout
- Lawned frontage and low-maintenance rear garden
- Private driveway leading to detached garage
- Gas central heating and double glazing
- Prime Salvington location close to shops and transport links
- Council Tax Band D | EPC Rating D

**** Guide Price £400,000 - £450,000 ****

We are delighted to offer this beautifully refurbished detached two-bedroom bungalow, situated in the heart of the ever-popular Salvington district of Worthing. Occupying a generous corner plot on Franklin Road, this attractive home has been thoughtfully modernised by the current owner to an exceptional standard.

The property offers light-filled and well-balanced accommodation throughout, perfectly suited to modern living. A particular highlight is the stylish Shaker-style fitted kitchen, complete with solid wood worktops and ample storage, creating a warm yet contemporary space ideal for both everyday living and entertaining.

The bungalow further benefits from a stunning contemporary bathroom, beautifully finished with high-gloss tiling and featuring both a full-size bath and a large separate shower cubicle, offering a perfect blend of practicality and luxury.

Externally, the corner plot provides a wonderful sense of space and privacy. The property enjoys a low-maintenance rear garden, ideal for those seeking easy upkeep, alongside a lawned frontage. In addition, the home benefits from a private driveway leading to a detached garage, providing excellent off-road parking and storage.

Additional benefits include gas central heating and double glazing throughout.

Perfectly positioned, the property is just moments from local shops, excellent transport links, and provides easy access to Worthing town centre and the A27, making this an ideal home for downsizers, professionals, or anyone seeking single-level living in a prime location.



robertluff.co.uk

30 Guildbourne Centre, Worthing, West Sussex, BN11 1LZ | 01903 331247 | info@robertluff.co.uk

Robert
Luff & Co



robertluff.co.uk

30 Guildbourne Centre, Worthing, West Sussex, BN11 1LZ | 01903 331247 | info@robertluff.co.uk

Robert
Luff & Co

Floor Plan Franklin Road

Floor Plan

Approx. 64.0 sq. metres (688.8 sq. feet)

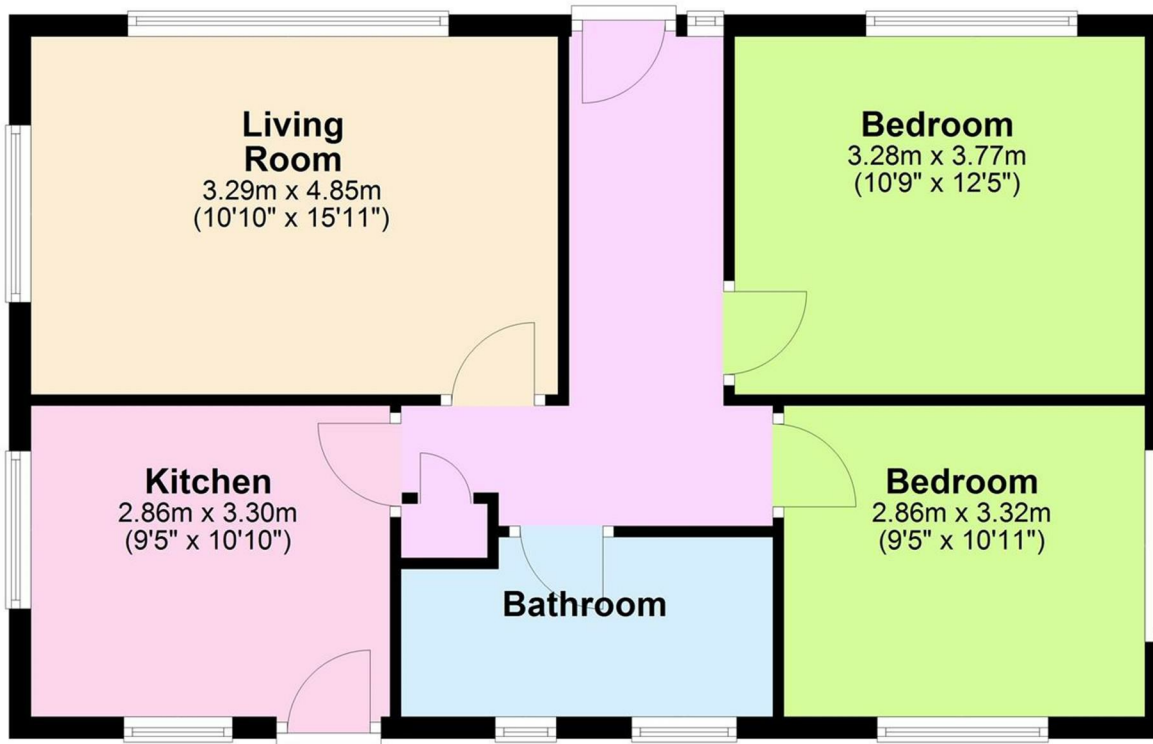

Total area: approx. 64.0 sq. metres (688.8 sq. feet)



Energy Efficiency Rating			Environmental Impact (CO ₂) Rating		
Very energy efficient - lower running costs	Current	Potential	Very environmentally friendly - lower CO ₂ emissions	Current	Potential
(92 plus) A			(81 plus) A		
(81-91) B			(69-80) C		
(69-80) C			(55-68) D		
(55-68) D			(39-54) E		
(39-54) E			(21-38) F		
(21-38) F			(1-20) G		
(1-20) G			Not environmentally friendly - higher CO ₂ emissions		
Not energy efficient - higher running costs England & Wales EU Directive 2002/91/EC			Not environmentally friendly - higher CO ₂ emissions England & Wales EU Directive 2002/91/EC		

The information provided about this property does not constitute or form any part of an offer or contract, nor may it be regarded as representations. All interested parties must verify accuracy and your solicitor must verify tenure/lease information, fixtures and fittings and, where the property has been extended/converted, planning/building regulation consents. All dimensions are approximate and quoted for guidance only as are floor plans which are not to scale and their accuracy cannot be confirmed. References to appliances and/or services does not imply that they are necessarily in working order or fit for the purpose.

robertluff.co.uk

30 Guildbourne Centre, Worthing, West Sussex, BN11 1LZ

01903 331247 | info@robertluff.co.uk

Robert
Luff & Co