

14 Fisher Close, Barton-le-Clay

Offers Over £380,000

3 2 1



Spacious 3-Bedroom Family Home | Large Garden | Sought-After Cul-de-Sac | Excellent Schools Nearby | No Chain

Located in one of Barton-le-Clay's most desirable residential areas, this attractive 3-bedroom home offers generous living space, a superb garden and exciting potential — all available with no onward chain for a smooth, stress-free purchase. The location is ideal for families, with excellent local schools close by.

AW1362

Key Features

- Quiet cul-de-sac position
- 3 well-proportioned bedrooms
- solid construction and modern layout
- Excellent Ofsted-rated local schools
- Reconsided football ground and sports facilities
- Large kitchen-diner with excellent storage and social layout
- Driveway parking for 3 cars, plus garage
- En-suite to master bedroom
- Short walk to village amenities including cafés, supermarket and shops
- AW1362

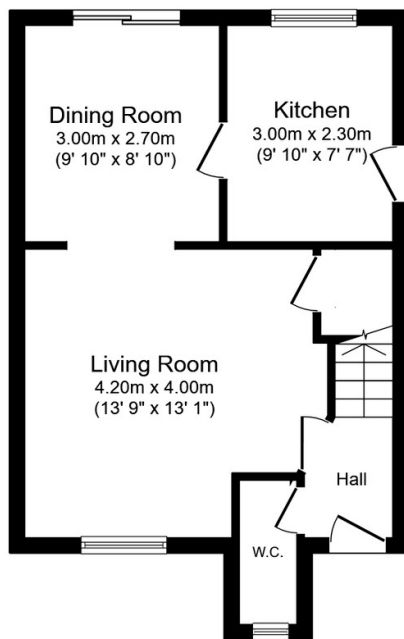

Ground Floor
Floor area 37.2 sq.m. (400 sq.ft.)

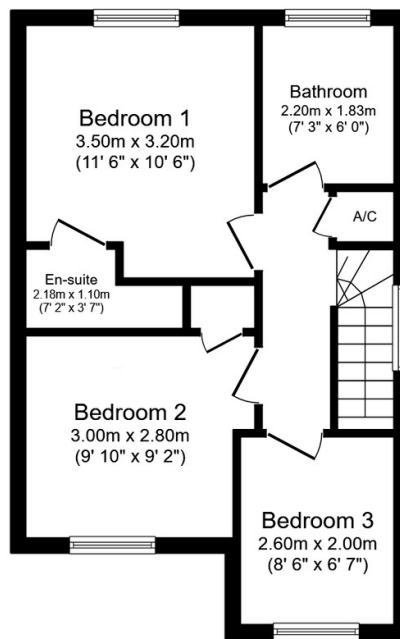

First Floor
Floor area 38.8 sq.m. (417 sq.ft.)

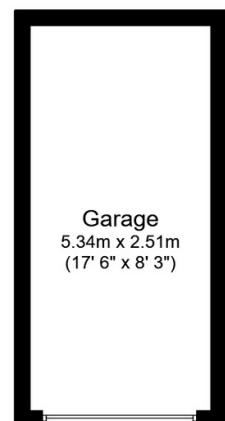

Garage
Floor area 13.4 sq.m. (144 sq.ft.)

Total floor area: 89.3 sq.m. (961 sq.ft.)

This floor plan is for illustrative purposes only. It is not drawn to scale. Any measurements, floor areas (including any total floor area), openings and orientations are approximate. No details are guaranteed, they cannot be relied upon for any purpose and do not form any part of any agreement. No liability is taken for any error, omission or misstatement. A party must rely upon its own inspection(s). Powered by www.Propertybox.io