



Ashford Road, NW2

£925,000

An end of terrace four bedroom house offering over 1400 sq ft of space with potential to increase this substantially with side, loft and back extensions, subject to planning permission. The property benefits from a south facing garden and is being offered chain free.

Ashford Road is a residential street conveniently located for local amenities and transport links. Cricklewood station (Thameslink) and Willesden Green station (Jubilee line) are both within 0.7 miles of the property.

Features

- End Of Terrace House
- Four Bedrooms
- Through Lounge
- Additional WC
- Extension Potential
- Chain Free

Ashford Road, London, NW2

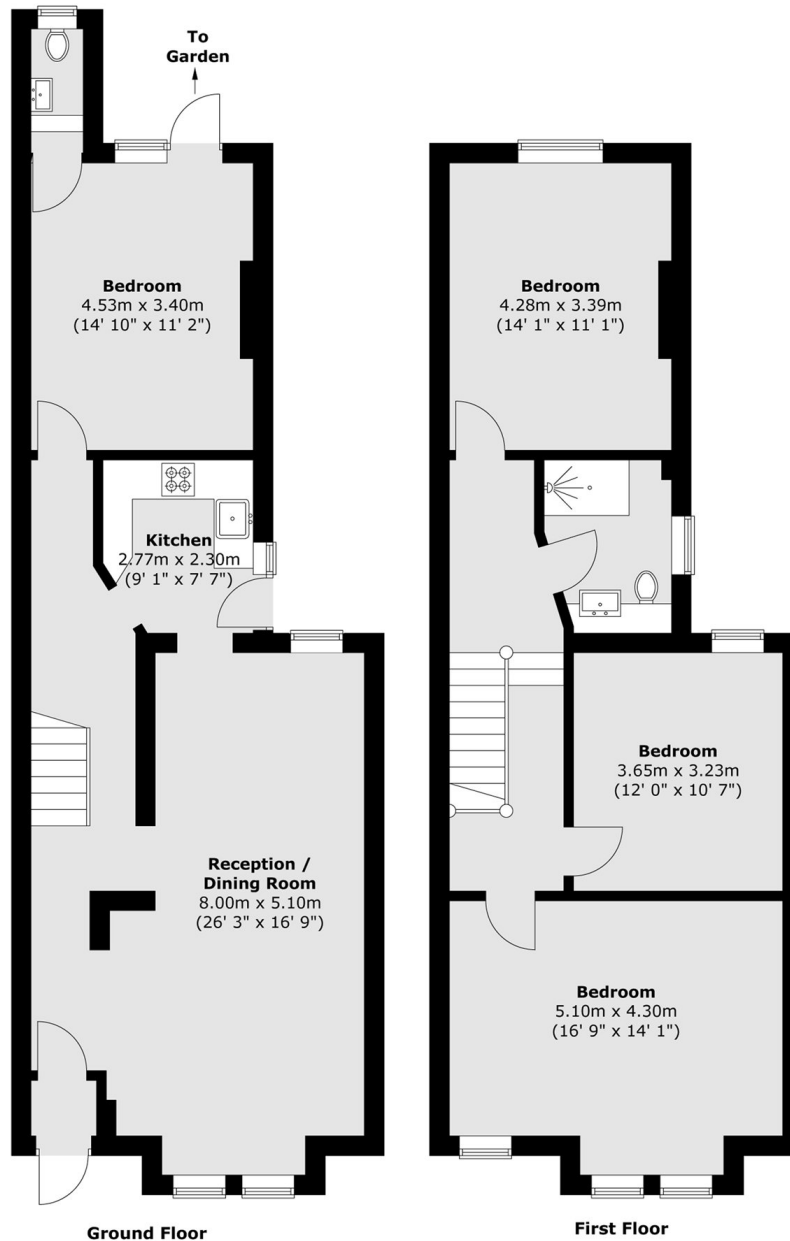

Total area (approx.) : 131.3 sq. m (1413 sq. ft)