



Coalport Close, Church Langley, CM17 9RD  
£400,000

3 1 1 C

# Coalport Close, Church Langley, CM17 9RD

Located at the end of a quiet cul-de-sac is this beautifully presented, three bedroom end terrace home with two parking spaces. As you enter there is a hallway leading to a large lounge/diner, a modern fitted kitchen with a range of wall and base units and a cloakroom/WC, whilst upstairs there are three bedrooms and a beautiful family bathroom with a white three piece suite. Outside, the rear garden is laid to patio and pebbles, with a shed that has power and side access leading out to the front with the two parking spaces. Coalport Close is located just off Kiln Lane, within walking distance of excellent local schools, shops and open fields.

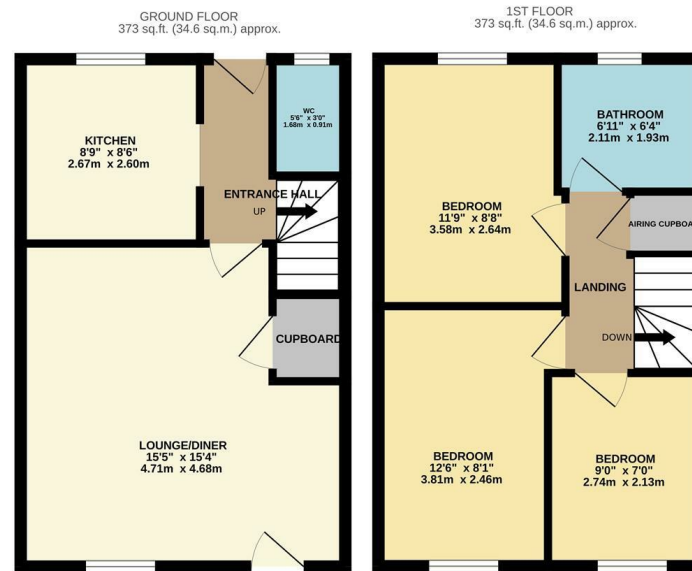
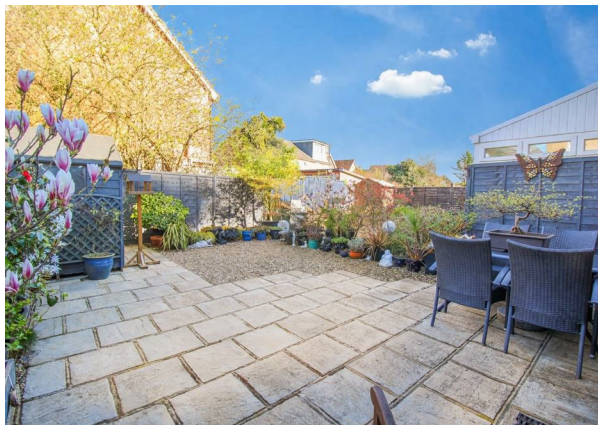
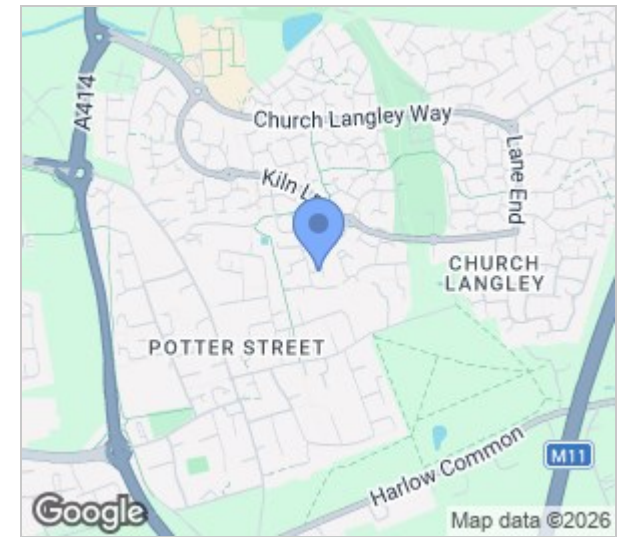

CC:REVLANDJOHNSON  
 TOTAL FLOOR AREA: 746 sq.ft. (69.3 sq.m.) approx.  
 Whilst every attempt has been made to ensure the accuracy of the floorplan contained here, measurements of doors, windows, rooms and any other items are approximate and no responsibility is taken for any error, omission or mis-statement. This plan is for illustrative purposes only and should be used as such by any prospective purchaser. The services, systems and appliances shown have not been tested and no guarantee as to their operability or efficiency can be given.  
 Made with Metropix ©2026



Energy Efficiency Rating		Environmental Impact (CO <sub>2</sub> ) Rating																													
Current	Potential	Current	Potential																												
Very energy efficient - lower running costs																															
Very environmentally friendly - lower CO <sub>2</sub> emissions																															
<table border="0"> <tr> <td style="width: 20px;">(92 plus)</td> <td style="width: 20px;">A</td> <td style="width: 20px;"></td> <td style="width: 20px;"></td> </tr> <tr> <td>(81-91)</td> <td>B</td> <td></td> <td></td> </tr> <tr> <td>(69-80)</td> <td>C</td> <td></td> <td></td> </tr> <tr> <td>(55-68)</td> <td>D</td> <td></td> <td></td> </tr> <tr> <td>(39-54)</td> <td>E</td> <td></td> <td></td> </tr> <tr> <td>(21-38)</td> <td>F</td> <td></td> <td></td> </tr> <tr> <td>(1-20)</td> <td>G</td> <td></td> <td></td> </tr> </table>				(92 plus)	A			(81-91)	B			(69-80)	C			(55-68)	D			(39-54)	E			(21-38)	F			(1-20)	G		
(92 plus)	A																														
(81-91)	B																														
(69-80)	C																														
(55-68)	D																														
(39-54)	E																														
(21-38)	F																														
(1-20)	G																														
<table border="0"> <tr> <td style="width: 20px;"></td> <td style="width: 20px;"></td> <td style="width: 20px;">73</td> <td style="width: 20px;">78</td> </tr> </table>				73	78																										
		73	78																												
England & Wales		England & Wales																													
EU Directive 2002/91/EC		EU Directive 2002/91/EC																													

These particulars, whilst believed to be accurate are set out as a general outline only for guidance and do not constitute any part of an offer or contract. Intending purchasers should not rely on them as statements of representation of fact, but must satisfy themselves by inspection or otherwise as to their accuracy. No person in this firm's employment has the authority to make or give any representation or warranty in respect of the property.