



Wisbech Road, March
£300,000 Freehold

**Sharman
Quinney**

Key Features



- Brilliant Family Home
- Ample Off-Road Parking with Garage
- Walking Distance to Town Centre and Local Schools
- Private Rear Garden with Workshop with Light and Power
- 27ft Conservatory with views of the garden

Ground Floor

Entrance Hall

Entrance door to front and window to side. Tiled flooring. Access into conservatory.

Conservatory

Part brick and UPVC construction, having been refitted with new windows, doors and roof recently. Access into lounge, inner hallway with stairs to first floor and kitchen. French doors to side and door to rear lead out into the garden.

Lounge

Bay window to front. Fitted carpet. Feature fireplace.



Kitchen

Tiled flooring and walls. Window to side into conservatory. Access into pantry. Fitted with a range of base and wall units with breakfast table attached. Stainless steel sink, Integrated gas hob, eye level double oven, space for undercounter fridge and dishwasher.

First Floor

Bedroom One

Window to side. Fitted carpet. Built in cupboard and walk in cupboard.

Bedroom Two

Window to front. Fitted carpet.

Bedroom Three

Window to front. Fitted carpet.

Bathroom

Window to rear. Tiled walls. Three-piece suite comprising of panelled bath with overhead shower, pedestal sink and low-rise toilet.

Outside

The front garden is walled and has a paved driveway offering ample off-road parking in front of the garage. There is a large area laid to lawn offering potential for more parking if needed. A side gate allows access to the rear garden.

The rear garden is beautifully maintained, a large



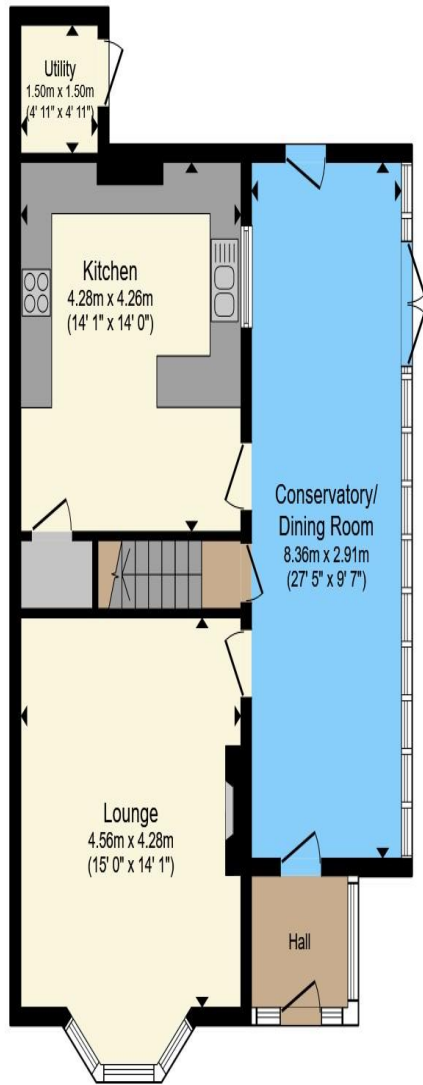

Ground Floor

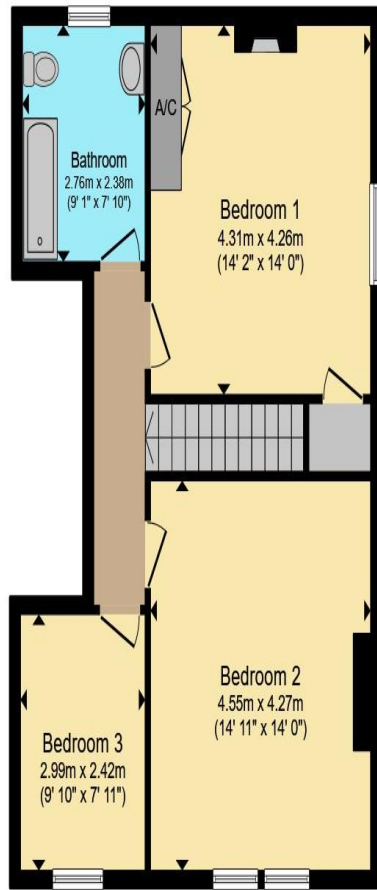

First Floor

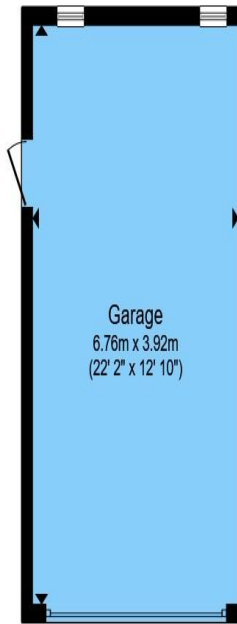

Garage

Total floor area 162.5 m² (1,750 sq.ft.) approx

This floor plan is for illustrative purposes only. It is not drawn to scale. Any measurements, floor areas (including any total floor area), openings and orientation are approximate. No details are guaranteed, they cannot be relied upon for any purpose and they do not form part of any agreement. No liability is taken for any error, omission or misstatement. A party must rely upon its own inspection(s). Powered by www.propertybox.io

**Sharman
Quinney**

section of lawn and a smaller section of artificial grass. Mature shrub and flower borders. Access to the garage through personal door to the side, there is also a workshop with light and power and a utility room with wall mounted boiler and plumbing for washing machine and tumble dryer.

To view this property call Sharman Quinney on:
01354 661166

Selling your property?

Contact us to arrange a **FREE** home valuation.

 01354 661166

 8 Broad Street, MARCH, Cambridgeshire, PE15 8TG

 march@sharmanquinney.co.uk

 www.sharmanquinney.co.uk



 SCAN ME



Sharman Quinney Holdings Limited is registered in England and Wales under company number 4174227, Registered Office is Cumbria House, 16-20 Hockliffe Street, Leighton Buzzard, Bedfordshire, LU7 1GN. VAT Registration Number is 500 2481 05.

1: These particulars do not constitute part or all of an offer or contract. 2: The measurements indicated are supplied for guidance only and as such must be considered incorrect. 3: Potential buyers are advised to recheck the measurements before committing to any expense. 4: Sharman Quinney has not tested any apparatus, equipment, fixtures, fittings or services and it is the buyers interests to check the working condition of any appliances. 5: Sharman Quinney has not sought to verify the legal title of the property and buyers must obtain verification from their legal representative. 6: Intending purchasers will be asked to produce identification documentation at a later stage and we would ask your co-operation in order that there will be no delay in agreeing the sale. Ref: MRC207217 - 0001

