



LB

Loporto Browne

— RESIDENTIAL —

Clanricarde Gardens, W2

£2,500PCM (Deposit: £2,884)

🛏 1 🚿 1 🚿 1



- Wooden floors
- Quiet cul-de-sac in Notting Hill, W11
- Ideal 1 bedroom, 1 bathroom flat
- High ceilings
- Separate kitchen
- Bright with natural sunlight

Tax Band: D Furnished: Not Specified

Elegant one bedroom flat nestled amongst the Victorian terraces of Clanricarde Gardens, Notting Hill.

This sunny apartment sits on the third floor of a quaint end-of-terrace just off Notting Hill Gate. Across 424 square feet, a spacious double bedroom neighbours a living room with large, sash windows, quintessentially Victorian picture rails, and a separate kitchen.

Clanricarde Gardens is just off Notting Hill Gate itself, with the underground station just 5-minutes' walk away for the central, circle and district lines. London's finest green spaces, Kensington Gardens and Hyde Park, are on your doorstep for a stroll in the frost of winter or a picnic with friends on a summer evening.

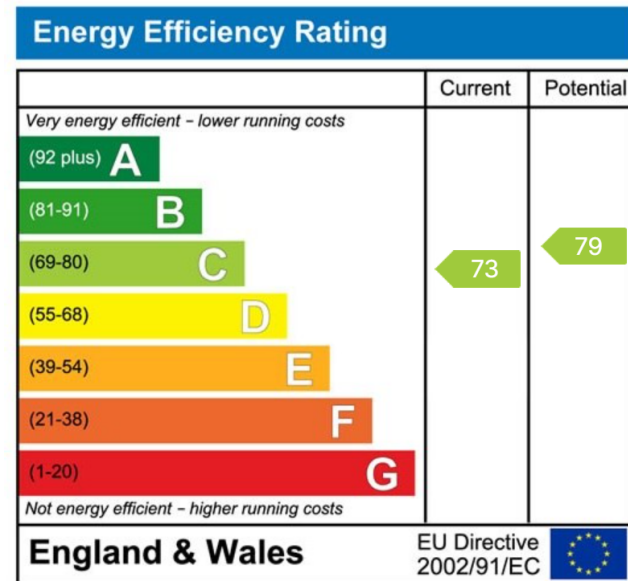
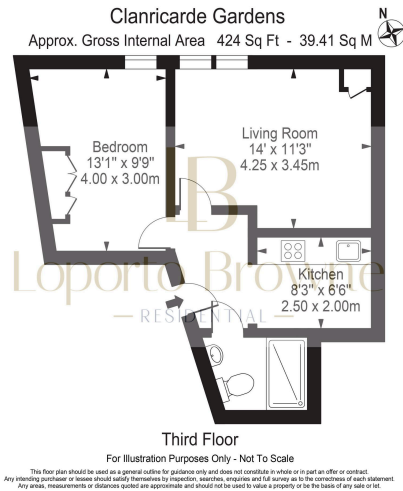

LB Residential
Grand Union Studios
332 Ladbroke Grove
W10 5AD

Email: hello@lbresidential.co.uk
Web: www.lbresidential.co.uk
Tel: 0203 062 6262