



23 Heywood Gardens, Maidenhead, SL6 3LY
Offers in excess of £95,000

 **HORLER**

23 Heywood Gardens, Maidenhead, SL6 3LY

Located in the charming Heywood Gardens of Maidenhead, this delightful two-bedroom single unit park home offers a perfect blend of comfort and convenience.

This park home is an excellent opportunity for those seeking a peaceful lifestyle in a well-connected area. With its inviting interiors and lovely outdoor space, it is sure to appeal to a variety of buyers. Don't miss the chance to make this charming property your new home.

Call today on 01753 621234 to arrange a viewing



Property Summary

Located in the charming Heywood Gardens of Maidenhead, this delightful two-bedroom single unit park home offers a perfect blend of comfort and convenience. Upon entering, you are welcomed by a spacious living room, ideal for relaxation and entertaining. The fitted kitchen boasts a range of eye and base level units, complemented by integral appliances, making it a joy for any home cook.

The property features a well-appointed family bathroom, ensuring practicality for everyday living. The first bedroom is a generous double, complete with fitted wardrobes that provide ample storage space. The second bedroom also benefits from fitted storage, making it suitable for guests or as a home office.

Outside, the property is enhanced by street parking at the front, providing easy access. The wrap-around garden is a true highlight, offering a secluded and fenced space perfect for enjoying the outdoors. A wooden garden shed at the rear adds extra utility for storage or gardening tools.

This park home is an excellent opportunity for those seeking a peaceful lifestyle in a well-connected area. With its inviting interiors and lovely outdoor space, it is sure to appeal to a variety of buyers. Don't miss the chance to make this charming property your new home.

Call today on 01753 621234 to arrange a viewing

General Information

Council Tax Band 'A'

Family Park

Pitch Fee £258.26 per month

Pet Friendly

Age of Unit 35 years

Mains Gas

Monthly Outgoings - approx Electricity £37.00/Gas
£35.00

Legal Note

Although these particulars are thought to be materially correct, their accuracy cannot be guaranteed and they do not form part of any contract





Haywood Gardens SL3

Approximate Gross Internal Floor Area = 35.5 sq m / 383 sq ft

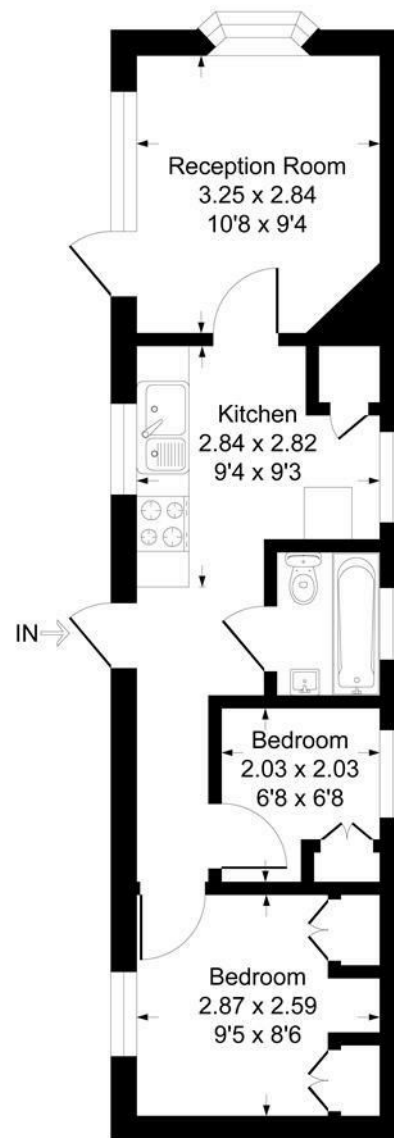

Illustration for identification purposes only, measurements are approximate, not to scale.
Produced By Ejsay Property Marketing