



Victoria Street
London, SW1H

CHESTERTONS





A spacious Manhattan style apartment located on the second floor of this modern and beautifully finished development in the heart of Westminster. The apartment benefits from an open plan living space with wide floor-to-ceiling windows, designer Italian kitchen, modern bathroom and oak wood plank floors throughout.

Further benefits include, private balcony, access to a 24-hour concierge, gymnasium, landscaped rear courtyard and an 8th floor Sky Garden with expansive south facing views.

55 Victoria Street is conveniently located for the shops, cafes and restaurants of Westminster and St James's Park as well as a number of London's most famous landmarks. The transport links can be found at St James's Park (Circle and District line) and Westminster (Jubilee, Circle and District line).

- Very Desirable Beautifully Designed Modern Development
- A Spacious 2nd Floor Manhattan Style Apartment
- Open Plan Reception with Modern Kitchen
- Family Bathroom
- Lift Access
- Private Balcony
- 24-Hour Concierge, Residents Gym, Sky Garden,

Asking Price £500,000

| Energy Efficiency Rating | | Current | Potential |
|--------------------------|---|---------|-----------|
| 100-109 | A | | |
| 81-100 | B | 83 | 83 |
| 69-80 | C | | |
| 55-68 | D | | |
| 39-54 | E | | |
| 21-38 | F | | |
| 1-20 | G | | |

Not energy efficient - higher running costs

EU Directive 2002/91/EC
England, Scotland & Wales

Tenure: Leasehold 986 years remaining (Lease expires on 1st June 3012)
Service Charge: £5,400 p.a. (Approximately)
Ground Rent: £500 p.a.
Local Authority: Westminster
Council Tax Band: E

Chestertons Westminster & Pimlico Sales

105 Wilton Road
 London
 SW1V 1DZ
 westminster@chestertons.co.uk
 020 3040 8201
 chestertons.co.uk

Victoria Street, SW1H
Approximate Gross Internal Area
41.42 sq m / 446 sq ft

(CH = Ceiling Heights)

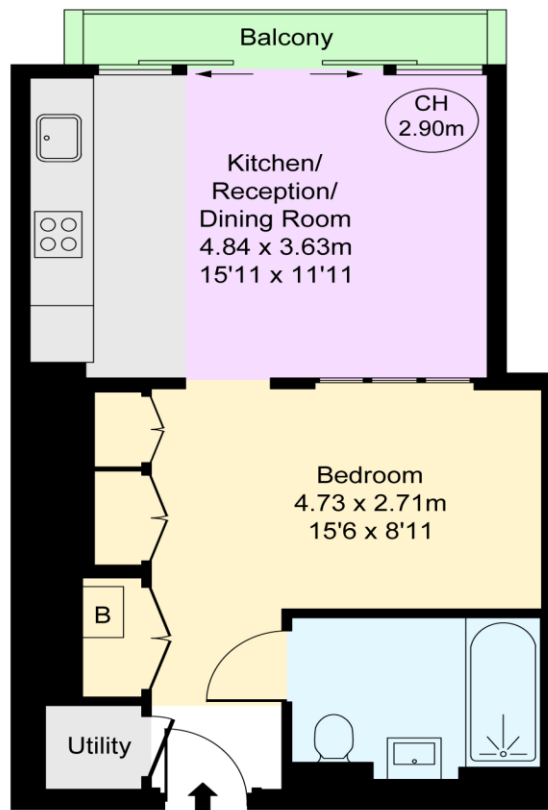
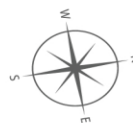

Second Floor



This plan is not to a given scale. A detailed layout plan to scale for valuation is available on request. All measurements and areas are within 1% tolerance and have been prepared in accordance with industry standards as defined in the RICS Code of Measuring Practice
© Fulham Performance

Chesterton UK Services Limited trading as Chestertons for themselves and for the vendor of this property whose agents they are, give notice that (i) these particulars do not constitute any part of an offer or contract, (ii) all statements contained within these particulars are made without responsibility on the part of Chestertons or the vendor, (iii) whilst made in good faith, none of the statements contained within these particulars are to be relied upon as a statement or representation of fact, (iv) any intending purchasers must satisfy themselves by inspection or otherwise as to the correctness of each of the statements contained within these particulars, (v) the vendor does not make or give either Chestertons or any person in their employment any authority to make or give representation or warranty whatsoever in relation to this property. Wide angle lenses may be used. ©Copyright Chestertons | Chesterton UK Services Limited | Registered Office 40 Connaught Street, Hyde Park, London W2 2AB Registered Company Number 05334580.



This paper is
100% recyclable