



River View, Enfield, EN2 6PX

welcome to
River View, Enfield

Beautifully appointed Edwardian character house situated in the heart of Enfield Town Conservation Area, overlooking and with views of the old course of The New River and surrounding by properties of character and stature and within close proximity of Enfield Chase Rail Station (Moorgate Line), Chase Green, Enfield Town with its multiple shopping facilities, parks, pubs, restaurants and good schools.

This delightful and beautifully presented character property has many pleasing features and is offered on a chain free basis.



Entrance Hall

Wood effect floor, double radiator, cornice to ceiling, sunken spotlights to ceiling.

Dual Aspect Through Lounge

11' 2" max x 25' (3.40m max x 7.62m)

Wood effect floor, two double radiators, attractive cast iron fire with tiled slips and hearth with wooden mantel over, cornice and rose to ceiling.

Dual Aspect Kitchen / Diner

17' 7" x 9' 10" (5.36m x 3.00m)

Beautifully appointed in a range of wood base, wall and display cupboards with one and half bowl stainless steel sink and drainer inset to contrasting worksurface, plumbing for washing machine and tumble dryer, breakfast bar, space for range cooker and fridge-freezer, sunken spotlights to ceiling, casement door to rear garden.

Cloakroom / WC

Low flush WC, bracket basin, extractor fan, sunken spotlights to ceiling, wood effect floor.

First Floor

Landing

Solid wood floor, cornice to ceiling, sunken spotlights to ceiling, access to loft.

Bedroom One

14' 10" max x 10' 7" (4.52m max x 3.23m)

Solid wood floor, double radiator, built-in wardrobe cupboards and base cupboards, cornice and rose to ceiling, views to front over old course of New River.

Bedroom Two

11' 1" x 9' 1" max (3.38m x 2.77m max)

Fitted carpet, cornice to ceiling, ceiling rose, radiator.

Bedroom Three

9' 10" x 9' 9" max (3.00m x 2.97m max)

Solid wood floor, cornice to ceiling, double radiator, built-in linen/storage cupboard.

Bathroom

Beautifully appointed in a white suite, comprising low flush WC, vanity basin with Victorian style mixer taps, panelled bath with Victorian style mixer tap and shower attachment, glass shower screen, tiled splashback, ceramic tiled floor, heated towel rail, frosted window to side.

Outside

Front Garden

Attractive tiled path with contrasting tiled slips to front porch, picket fence.

Rear Garden

West facing, stone paving with raised planters and beds, mature shrubs, BBQ area, rear pedestrian access.



view this property online barnfields.co.uk/Property/ENF103548







welcome to

River View, Enfield

- Three Spacious Bedrooms
- Conservation Location
- West Facing Rear Garden
- River Views
- Spacious Kitchen / Breakfast Room

Tenure: Freehold EPC Rating: Awaited
Council Tax Band: E

£800,000



Please note the marker reflects the postcode not the actual property

River View, Enfield, EN2

Approximate Area = 1034 sq ft / 96 sq m
For identification only - Not to scale

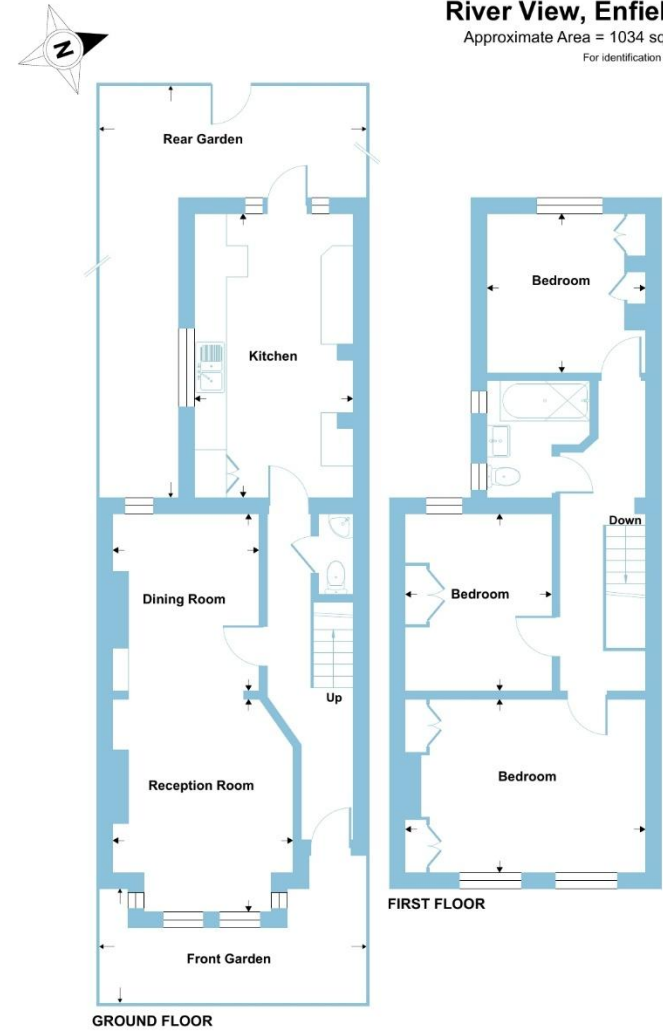

GROUND FLOOR

FIRST FLOOR

Floor plan produced in accordance with RICS Property Measurement 2nd Edition, Incorporating International Property Measurement Standards (IPMS2 Residential). © nrichcom 2026. Produced for Barnard Marcus. REF: 1435643



check out more properties at [barnfields.co.uk](https://www.barnfields.co.uk)



Property Ref:
ENF103548 - 0002

1. MONEY LAUNDERING REGULATIONS Intending purchasers will be asked to produce identification documentation at a later stage and we would ask for your co-operation in order that there is no delay in agreeing the sale. 2. These particulars do not constitute part or all of an offer or contract. 3. The measurements indicated are supplied for guidance only and as such must be considered incorrect. Potential buyers are advised to recheck measurements before committing to any expense. 4. We have not tested any apparatus, equipment, fixtures or services and it is in the buyers interest to check the working condition of any appliances. 5. Where an EPC, or a Home Report (Scotland only) is held for this property, it is available for inspection at the branch by appointment. If you require a printed version of a Home Report, you will need to pay a reasonable production charge reflecting printing and other costs. 6. We are not able to offer an opinion either written or verbal on the content of these reports and this must be obtained from your legal representative. 7. Whilst we take care in preparing these reports, a buyer should ensure that his/her legal representative confirms as soon as possible all matters relating to title including the extent and boundaries of the property and other important matters before exchange of contracts.

Barnfields is a trading name of Sequence (UK) Limited which is registered in England and Wales under company number 4268443, Registered Office is Cumbria House, 16-20 Hockliffe Street, Leighton Buzzard, Bedfordshire, LU7 1GN. VAT Registration Number is 500 2481 05.



020 8363 3394



info@barnfields.com



1a Windmill Hill, Enfield, Middlesex, EN2 6SE



[barnfields.co.uk](https://www.barnfields.co.uk)