



Stoneacre
Properties



Armley Lodge Road, Leeds, LS12 2AT
£725 Per Calendar Month

Stoneacre Properties are delighted to offer for rent this spacious one bedroom ground floor apartment in Armley.

As you enter the property, you are greeted with a large, light, open plan living room/ Kitchen. The bedroom is generously sized, providing a peaceful retreat at the end of the day. The bathroom is fitted with modern fixtures, ensuring convenience and comfort for daily routines. The property also benefits from a private garden area to the front.

With its location, residents will enjoy easy access to the city centre and local amenities, including shops, cafes, and parks, making it an ideal choice for those who appreciate both convenience and community.

AVAILABLE EARLY MARCH 2026!

Floor Plan

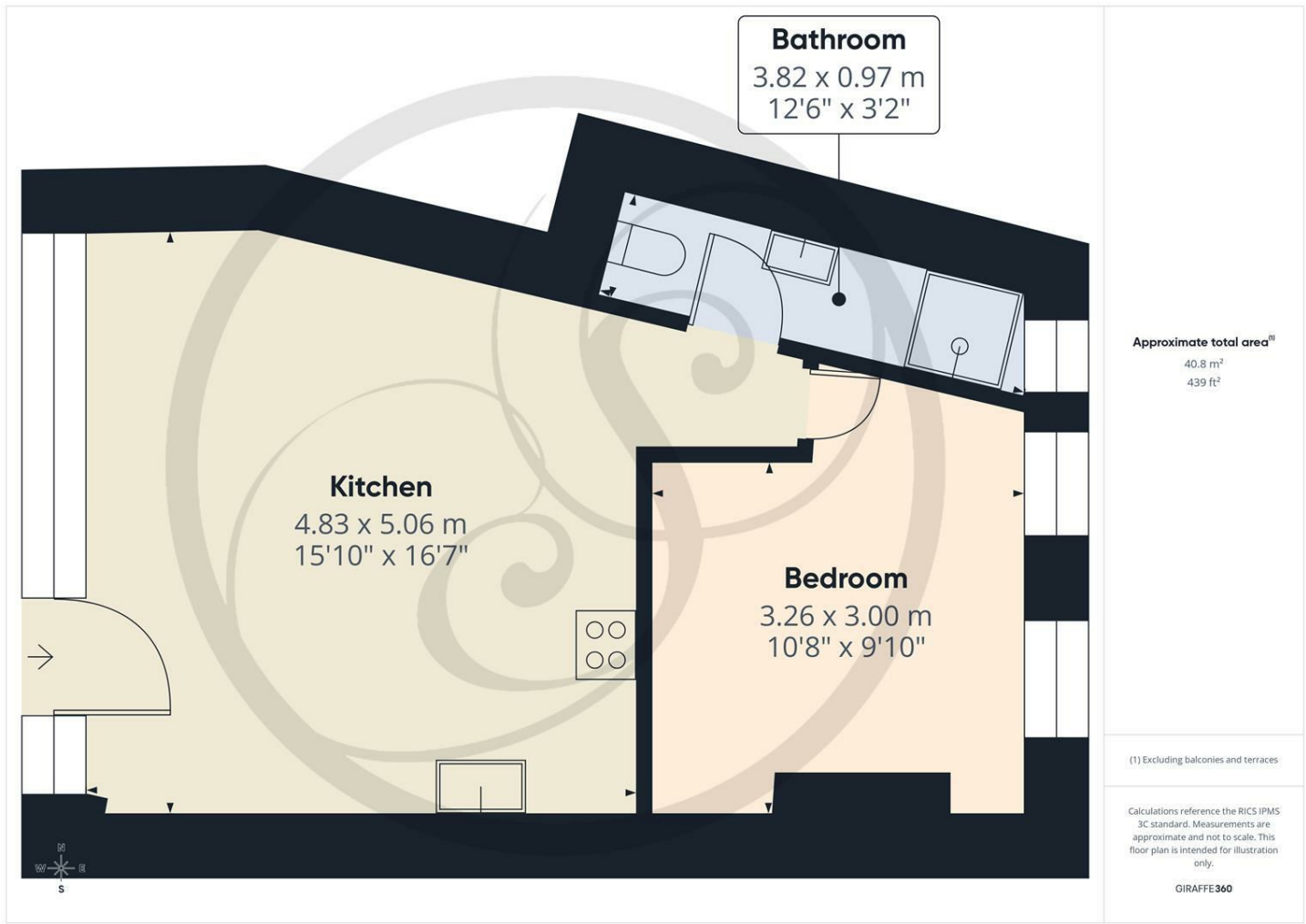

Area Map



Energy Efficiency Graph

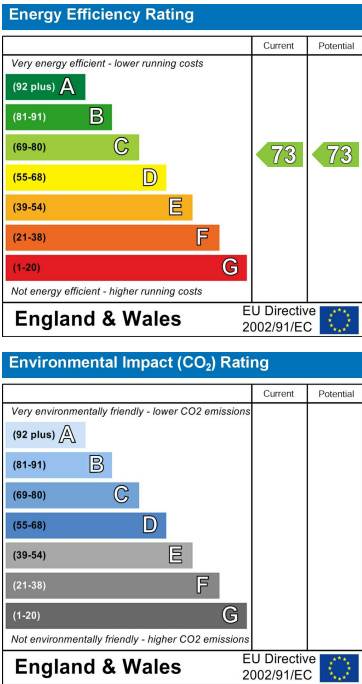

These particulars, whilst believed to be accurate are set out as a general outline only for guidance and do not constitute any part of an offer or contract. Intending purchasers should not rely on them as statements of representation of fact, but must satisfy themselves by inspection or otherwise as to their accuracy. No person in this firm's employment has the authority to make or give any representation or warranty in respect of the property.

