

Oxhath Crescent, Bromley, BR2

4 3 2



An immaculately presented family home offering stylish and versatile living accommodation across three floors. Featuring a stunning in-frame kitchen with quartz island, open-plan dining and family space with underfloor heating, a mature landscaped garden, and an impressive principal bedroom suite occupying the entire top floor. Finished to a high standard throughout and benefiting from EV charging, bespoke shutters, a satisfactory EICR, and excellent storage, this home is perfectly suited to modern family living.

Key Features

- Please Quote RF0924 for all enquiries.
- Open-plan dining and family room with underfloor heating
- Separate utility/laundry room with bespoke shelving
- Bespoke plantation shutters to bay windows and bedrooms
- Driveway parking with EV charging point
- Stunning in-frame kitchen with quartz island, Quooker tap and pantry storage
- Bi-fold doors opening onto a mature landscaped garden with rear access
- Oak flooring to hallway and living room
- Principal bedroom suite with en-suite, office/seating area and eaves storage
- Beautifully landscaped west-facing rear garden with limestone patio, rear access and excellent natural sunlight throughout the year

Oxhawth Crescent, Bromley, BR2

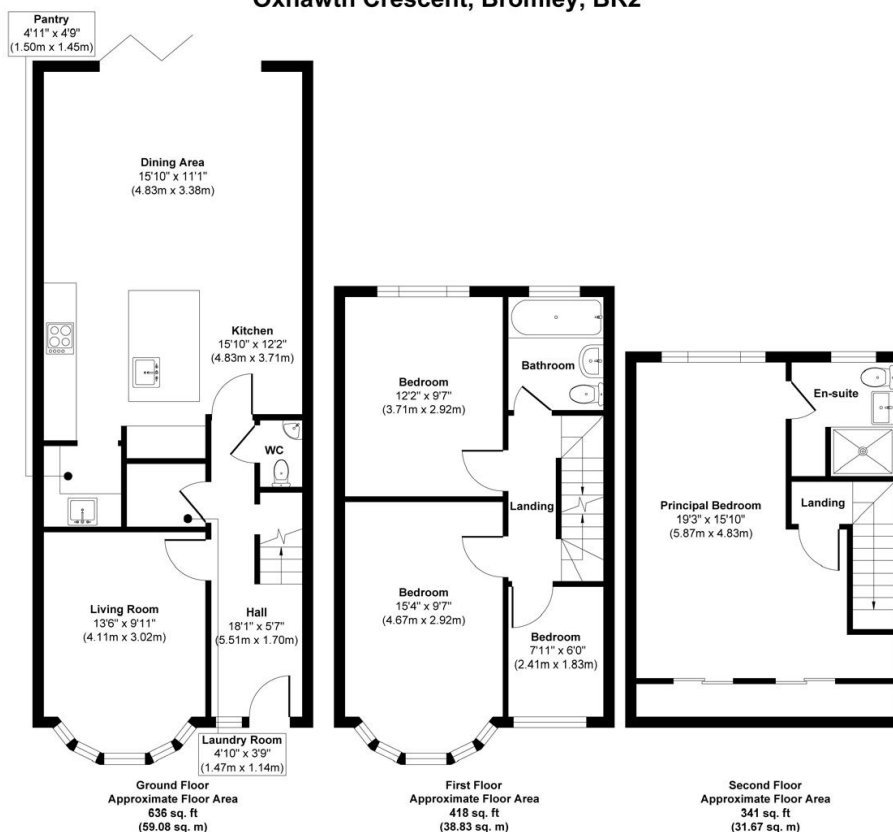

Approx. Gross Internal Floor Area 1395 sq. ft / 129.58 sq. m

Illustration for identification purposes only, measurements are approximate, not to scale.
Produced by Elements Property