

FLAGSTAFF HOUSE, SW8

£850,000

A beautifully refurbished two-bedroom, two-bathroom apartment in the sought-after Flagstaff House. Enjoy stunning river views from your private balcony, a spacious reception, and a modern fitted kitchen. Excellent transport links via Vauxhall station make getting around London effortless.

- 24 Hr Concierge
- On Site Gym
- Thames Clipper
- 929 Sq Ft
- River Views
- 0.1 Miles From Vauxhall Station



ABOUT THE HOME

St George Wharf, just 0.1 miles from Vauxhall Underground and National Rail.





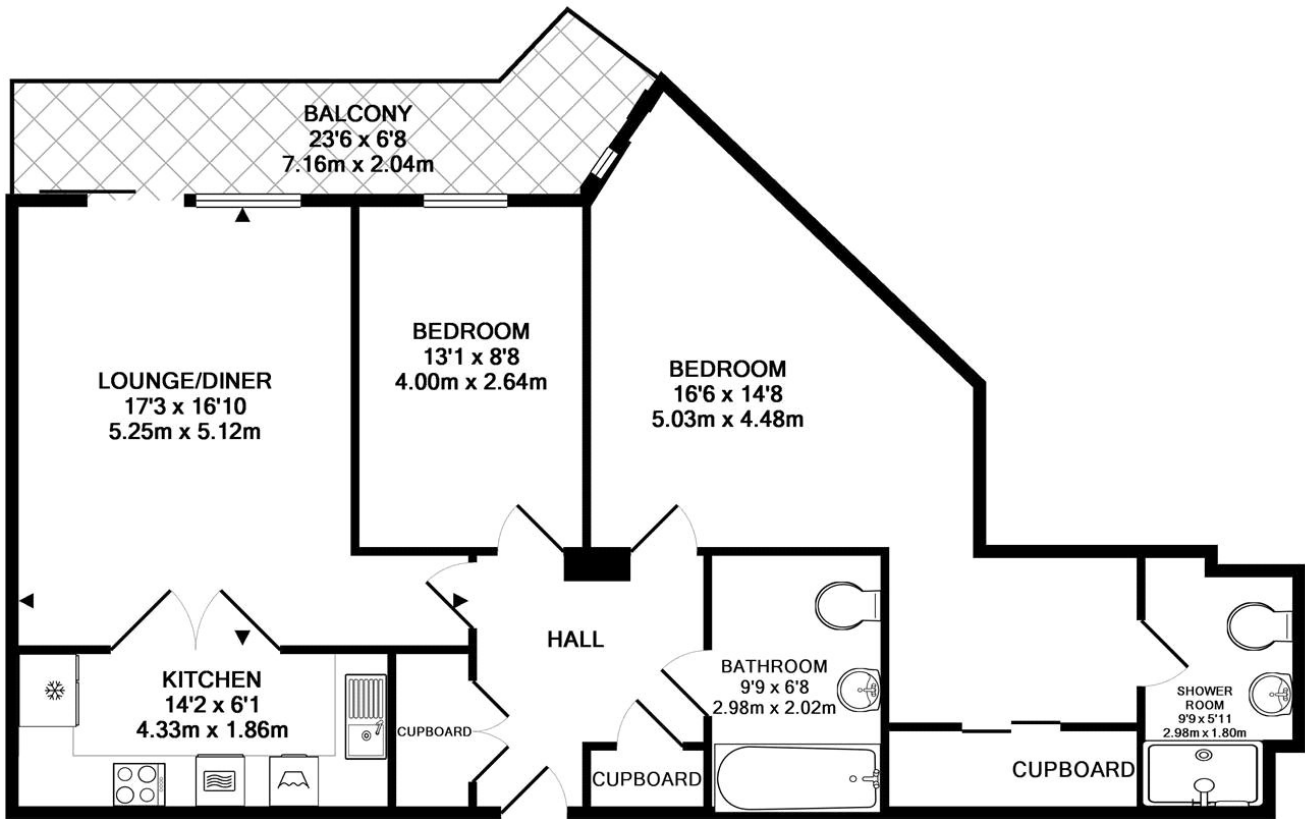

TOTAL APPROX. FLOOR AREA 929 SQ.FT. (86.3 SQ.M.)

Whilst every attempt has been made to ensure the accuracy of the floor plan contained here, measurements of doors, windows, rooms and any other items are approximate and no responsibility is taken for any error, omission, or mis-statement. This plan is for illustrative purposes only and should be used as such by any prospective purchaser. The services, systems and appliances shown have not been tested and no guarantee as to their operability or efficiency can be given
Made with Metropix ©2013

LiFE RESIDENTIAL

11 Flagstaff House, London,
SW8 2LZ
Sales: 020 7476 1408
Lettings: 020 7582 7989

Energy Rating: C. We aim to make our particulars both accurate and reliable. However they are not guaranteed; nor do they form part of an offer or contract. If you require clarification on any points then please contact us, especially if you're traveling some distance to view. Please note that appliances and heating systems have not been tested and therefore no warranties can be given as to their good working order.