



10 Whitchurch Close, Maidenhead, SL6 7TZ

£500,000 Freehold

A three bedroomed semi detached house in a quiet cul de sac location close to local amenities, Cookham and National Trust land. The property is located in a good school catchment area and is within walking distance of Furze Platt train station for connecting trains to Maidenhead, London and the Elizabeth Line.

Entrance Hall

Understairs storage.

Cloakroom

White suite of close coupled WC, wash basin unit.

Sitting Room

Double aspect.

Kitchen

Kitchen area well fitted with a comprehensive range of good quality units, inset stainless steel sink, ample work surfaces, cupboards and drawers, tall storage cupboard, integrated oven, space for washing machine and dishwasher, cupboard housing gas fired boiler, glazed door to garden.

Stairs leading from entrance hall to:

First Floor Landing

Access hatch to part boarded loft, airing cupboard.

Double Bedroom

Built in double wardrobe, overbed units, dual windows.

Double Bedroom

Built in double wardrobe, dual windows.

Single Bedroom

Storage cupboard.

Bathroom

White suite of WC, wash hand basin, panelled bath with Aqualisa shower, glass screen, fully tiled, heated towel rail, mirrored cabinet.

Outside

Enclosed private rear garden leading to single garage and private parking.

Garage

Door leading to garden.

Floor Plan

Approximate Floor Area = 82.5 sq m / 888 sq ft
 Garage = 13.4 sq m / 144 sq ft
 Total = 95.9 sq m / 1032 sq ft

Whitchurch Close

Waterman
 Established 1990

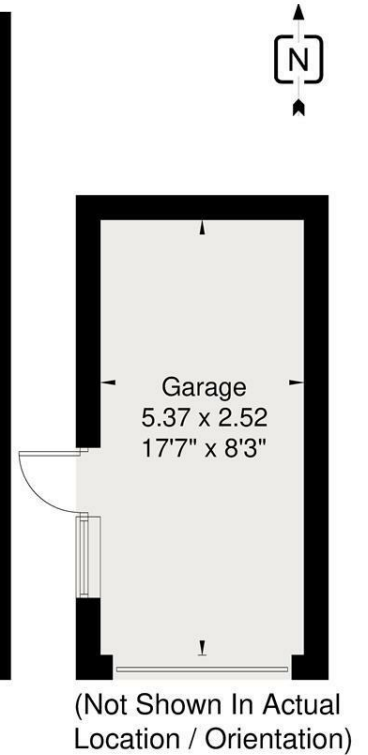
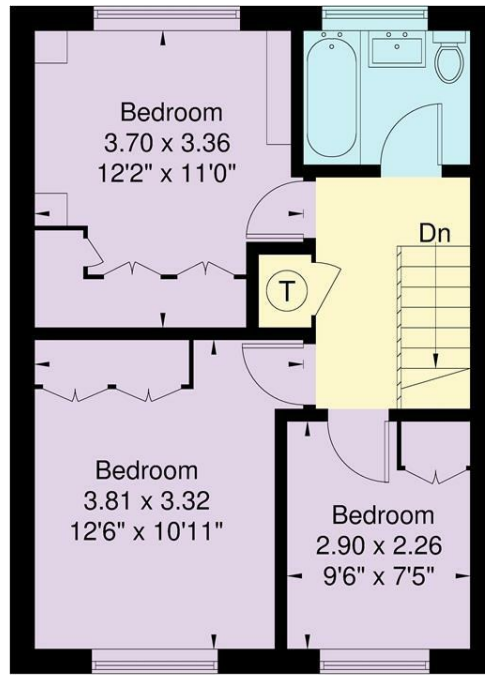
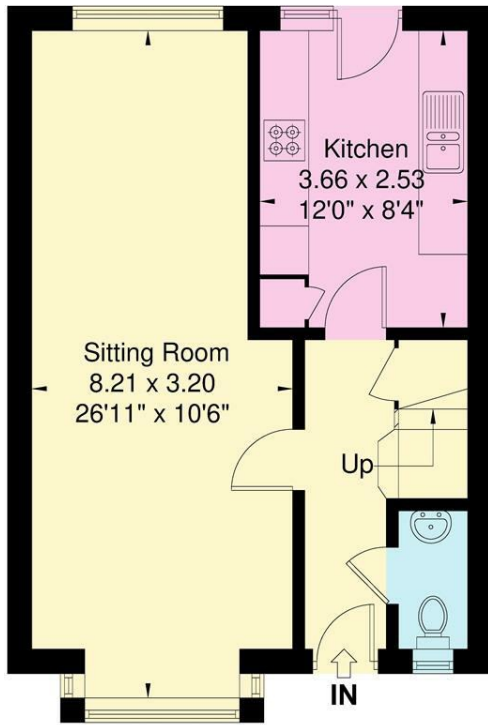
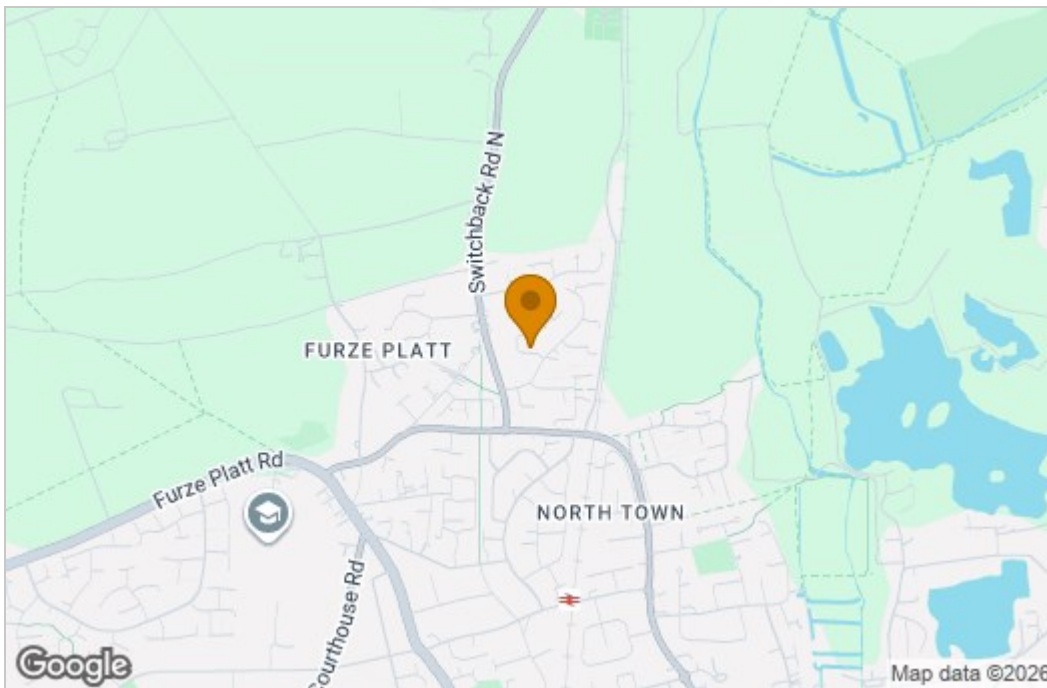
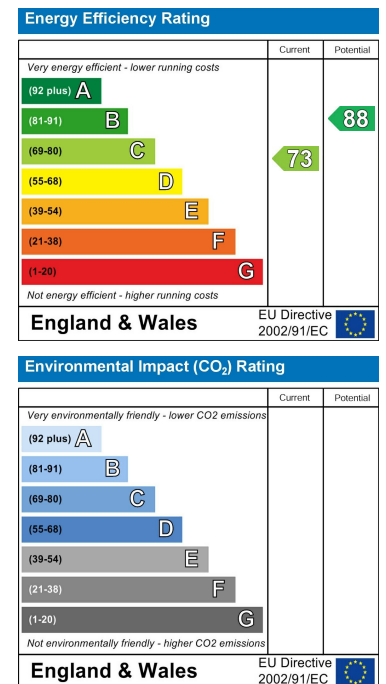

Illustration for identification purposes only, measurements are approximate, not to scale.

Area Map



Energy Efficiency Graph



These particulars, whilst believed to be accurate are set out as a general outline only for guidance and do not constitute any part of an offer or contract. Intending purchasers should not rely on them as statements of representation of fact, but must satisfy themselves by inspection or otherwise as to their accuracy. No person in this firm's employment has the authority to make or give any representation or warranty in respect of the property.