

# Upper Sandhurst Road

BRISLINGTON

APPROXIMATE FLOOR AREA  
85.7 SQM / 923 SQFT



GROUND FLOOR  
533 sq.ft. (49.6 sq.m.) approx.



1ST FLOOR  
389 sq.ft. (36.2 sq.m.) approx.

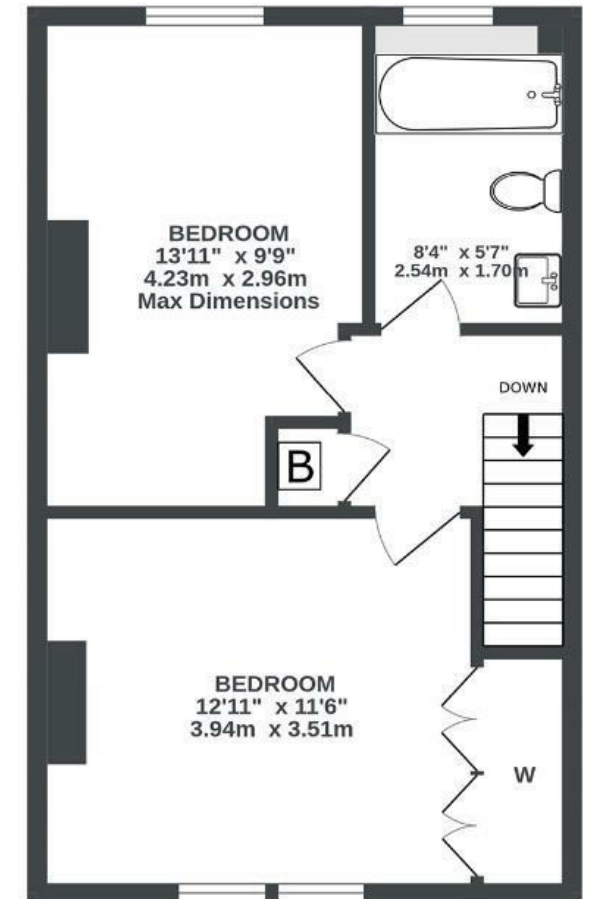

Illustrations are for reference purposes only, measurements are approximate, not to scale.

Boardwalk

# Upper Sandhurst , BRISTOL



£425,000



2 Bedrooms



BS4 3RR



1 Bathrooms

*" We love our home! It's been perfect for family life, from bringing home our first baby to hosting friends in the open-plan kitchen. Bi-fold doors lead to a private garden where we've enjoyed many homemade pizzas and cherries from the tree. Inside, morning light fills the front room, and our little one loves his animal wallpaper. We're lucky to have great cafés nearby such as Kin and Sandy Park Deli for Saturday croissants, lovely neighbours, and a welcoming community in a fantastic location. "*

