



32, Glendower Court, Greenfields, Shrewsbury, SY1 2RG
£850 Per Month



32, Glendower Court, Greenfields, Shrewsbury, SY1 2RG

£850 Per Month

VIRTUAL TOUR AVAILABLE: Modern two bedroom end of terrace house, offering well presented and improved accommodation. Ideally situated just outside Shrewsbury town centre and includes parking for two cars.

Available: 16/05/26

Description

Comprising: entrance hallway, living room, modern kitchen, conservatory, two bedrooms, refitted bathroom, easily managed gardens and car parking for two cars. Double glazing, gas central heating. EPC C



Unfurnished

Council Tax Band: B

Available: 16th May 2026

EPC: C

Floor Plans

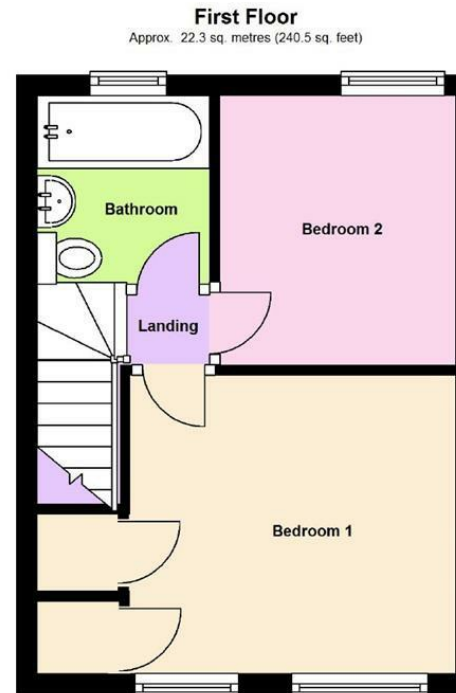
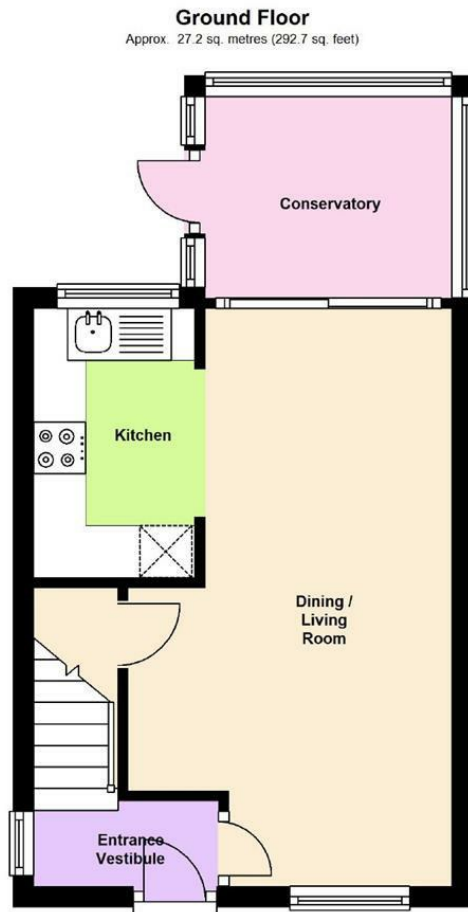

Total area: approx. 49.5 sq. metres (533.2 sq. feet)

We accept no responsibility for any mistake or inaccuracy contained within the floorplan. The floorplan is provided as a guide only and should be taken as an illustration only. The measurements, contents and positioning are approximations only and provided as a guidance tool and not an exact replication of the property.
Plan produced using PlanUp.

These particulars, whilst believed to be accurate are set out as a general outline only for guidance and do not constitute any part of an offer or contract. Intending purchasers should not rely on them as statements of representation of fact, but must satisfy themselves by inspection or otherwise as to their accuracy. No person in this firm's employment has the authority to make or give any representation or warranty in respect of the property.