



+44 (0) 1223 508050

lettings@cookecurtis.co.uk

www.cookecurtis.co.uk

Addenbrookes Road, Cambridge

A well-presented ground floor apartment featuring a west-facing balcony, ideally situated away from traffic within easy reach of Addenbrooke's Hospital.

£1,800 pcm

Addenbrookes Road,
Cambridge, CB2 9AS



A well-presented two-bedroom ground floor apartment situated in the highly sought-after area of Trumpington, conveniently located close to Addenbrooke's Hospital. The property offers excellent access to the city centre by road or bicycle, as well as easy connections to the M11.

The apartment features two generously sized double bedrooms, with the primary bedroom benefiting from a built-in wardrobe. There is a family bathroom fitted with a bath and shower over, WC, and wash basin. The spacious living area flows into an open-plan kitchen and dining space, creating a bright and practical layout.

The kitchen is fitted with a range of wall and base units and is fully equipped with white goods, including a hob, extractor fan, dishwasher, double ovens, and a fridge freezer. In addition, a separate washing machine is conveniently located in the hallway cupboard.

A TV storage unit located in the living room will also be included and will remain in the property.

The balcony can be accessed directly from the living area. The property also benefits from an allocated parking space, specifically the first space on the right as shown in the image as well as external bike storage.

Please note, there is no lift.

Available March 2026.

Please refer to the 'Tenant Guide' brochure, for more information





66 sqm / 712 sqft

2 bed, 1 recep, 1 bath

EPC - B / 81

Council tax band - C

Gas central heating

Allocated parking

Unfurnished

Available now



Ground Floor

Approx. 66.2 sq. metres (712.8 sq. feet)

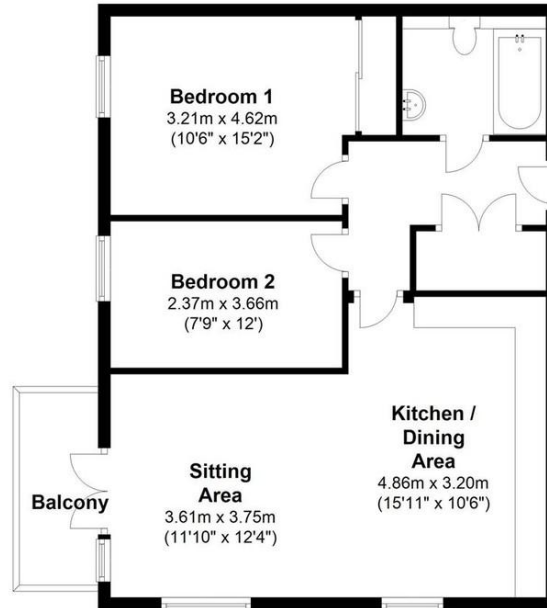

Total area: approx. 66.2 sq. metres (712.8 sq. feet)

Drawings are for guidance only.
Plan produced using PlanUp.

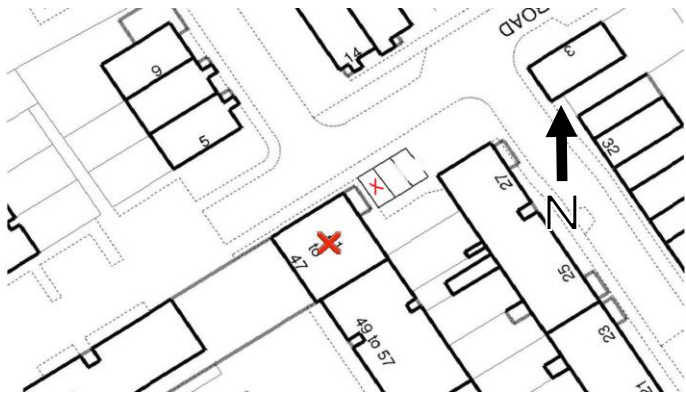

Trumpington is a thriving, fast growing part of the city that still manages to retain its village identity and sense of community. It is exceptionally well located for access into the Addenbrooke's campus, out to the M11 and into the city by car, bus, guided bus, one of a few purpose built cycle routes, or even an enthusiastic walk. The city's mainline station can be easily reached along the guided busway cycleway without having to mix with car traffic at all. The area has two primary schools with a brand new state-of-the-art secondary school built in 2016 with excellent sporting facilities. A number of Private schools are within cycling distance. There are also various restaurants, pubs, shops, a post office, hairdresser, surgery, chemist, Waitrose supermarket and two new country parks.

COOKE
CURTIS
& CO