



Welford Mews, SE6

£625,000

This beautifully presented mid-terraced modern house is in excellent condition throughout, featuring four spacious double bedrooms, two modern bathrooms and a private east facing garden.

Welford Mews is minutes away from Bellingham and a short walk from both Catford and Catford Bridge train stations, offering services to Blackfriars or London Bridge and Charing Cross respectively. The cafés, restaurants and shops of Catford town centre are within easy reach.

Features

- Four Double Bedrooms
- Three Bathrooms
- Open Plan Kitchen/Reception
- Freehold
- Private Garden
- Chain Free

Welford Mews, London, SE6

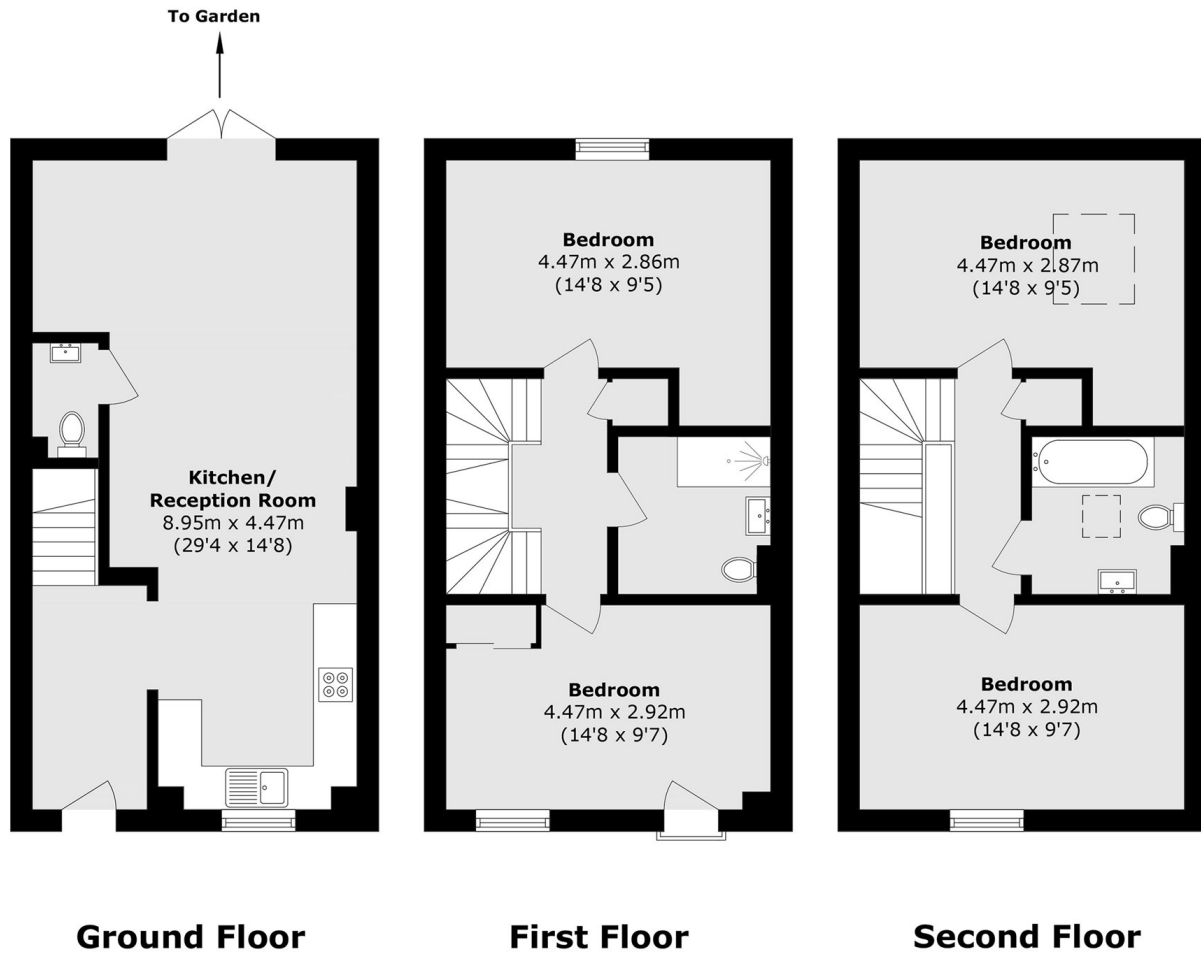

Total area (approx.): 120.0 sq. m (1291.6 sq. ft)