

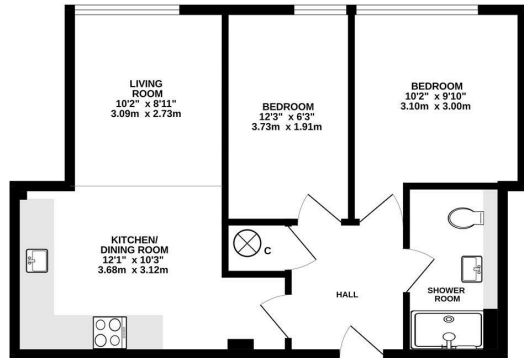

**Keith  
Ashton**

Hubert Road,  
Brentwood

FIFTH FLOOR  
534 sq.ft. (49.6 sq.m.) approx.



TOTAL FLOOR AREA: 534 sq.ft. (49.6 sq.m.) approx.  
Measurements are approximate. Not to scale. Dependent on position only.  
Made with Metagon 2020



## 112 Regent House Hubert Road, Brentwood, CM14 4WN

We are delighted to present this two-bedroom fifth-floor apartment, enviably located just moments from Brentwood High Street and the mainline railway station, offering excellent transport links into London and beyond.

The property features well-designed accommodation introduced by a welcoming entrance hall giving access to all rooms. At its heart is a bright, open-plan living area with a contemporary kitchen fitted with modern units and integrated appliances. Two well-proportioned bedrooms provide comfortable living space, with the principal room enjoying a large window that frames attractive views of the surrounding greenery. A modern, well-appointed bathroom completes the accommodation.

Positioned within a sought-after modern development, residents benefit from a concierge service, secure entry system, off-street parking, and lift access to all floors. Blending style, convenience, and superb connectivity, this apartment represents an outstanding home or investment opportunity in the heart of Brentwood.

Guide Price £290,000

Energy Efficiency Rating		Environmental Impact (CO <sub>2</sub> ) Rating	
Current	Potential	Current	Potential
Very energy efficient - lower running costs		Very environmentally friendly - lower CO <sub>2</sub> emissions	
(82 plus) <b>A</b>		(82 plus) <b>A</b>	
(61-81) <b>B</b>		(61-81) <b>B</b>	
(40-60) <b>C</b>		(40-60) <b>C</b>	
(29-39) <b>D</b>		(29-39) <b>D</b>	
(15-28) <b>E</b>		(15-28) <b>E</b>	
(9-14) <b>F</b>		(9-14) <b>F</b>	
(1-8) <b>G</b>		(1-8) <b>G</b>	
Not energy efficient - higher running costs		Not environmentally friendly - higher CO <sub>2</sub> emissions	
England & Wales	EU Directive 2002/91/EC	England & Wales	EU Directive 2002/91/EC

### SERVICES:

Local Authority: Brentwood  
Council tax band: E  
Post code: CM14 4WN

### VIEWING:

Strictly by prior arrangement with Keith Ashton Estate Agents

### OPENING HOURS:

Monday to Friday: 8.45AM - 6.30PM | Saturdays: 9AM - 5.30PM | Sundays: 10AM - 2PM

### MORTGAGE INFORMATION:

We offer the additional facility of an in-house Independent Financial Adviser who will access all mortgage lenders with the purpose of providing you with the benefit of choice. For quotations or comparables please call 01277 260858 or visit our interactive website at [www.mortgagebusiness.net](http://www.mortgagebusiness.net)



We the Agent have not tested any apparatus, fittings or services for this property. The plot size is intended merely as a guide and has not been officially measured or verified by the Agent. Photographs are for illustration only and may depict items which are not for sale or included in the sale of the property. As part of the service we offer we may recommend ancillary services to you which we believe may help you with your property transaction. We wish to make you aware, that should you decide to use these services we will receive a referral fee. For full and detailed information please visit 'terms and conditions' on our website [www.keithashton.co.uk](http://www.keithashton.co.uk)

Brentwood  
Tel. 01277 260858

Village Office  
Tel. 01277 375757

Lettings Office  
Tel: 01277 202200

Explore more @ [www.keithashton.co.uk](http://www.keithashton.co.uk)

