



SISTERS AVENUE, SW11

£720,000

Two Bedrooms
Two Bathrooms
Popular Residential Road
Exceptional Condition
Close To Transport
Parking Space

@marshandparsons
marshandparsons.co.uk

MARSH &
PARSONS



ABOUT THE PROPERTY

A spectacular two bedroom, two bathroom split level Victorian conversion apartment with two private terraces and an off street parking space.

Sisters Avenue is a popular tree lined residential road with convenient access to Clapham Junction station. Clapham Common is located at the end of the road and the amenities of Northcote Road and Clapham Old Town are also both close by.



STEP INSIDE SISTERS AVENUE

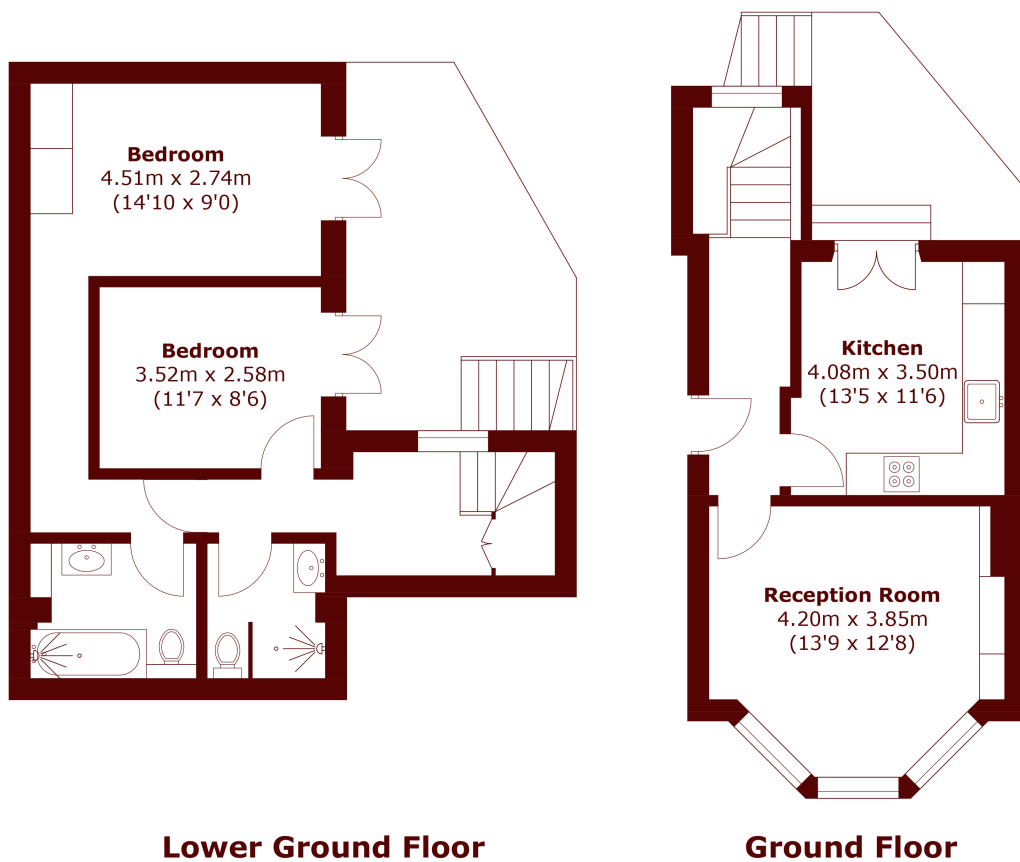

Total area (approx.): 73.3 sq. m (788.9 sq. ft)

Battersea
020 7326 9920

Energy Rating: D We aim to make our particulars both accurate and reliable. However, they are not guaranteed; nor do they form part of an offer or contract. If you require clarification on any points then please contact us, especially if you're traveling some distance to view. Please note that appliances and heating systems have not been tested and therefore no warranties can be given as to their good working order

**MARSH &
PARSONS**