

**2 Bed
Apartment
located in 11 Slivercroft Street**

AiHOMES.

TS1534095, 11 Slivercroft Street, Manchester



£2,000 Per Calendar Month

Welcome to this splendid apartment located at 11 Slivercroft Street in the vibrant city of Manchester. This modern residence boasts a generous living space of 1,033 square feet, providing ample room for both relaxation and entertaining.

The apartment features two well-appointed bedrooms, perfect for a small family or professionals seeking a comfortable living environment. Each bedroom is designed to offer a peaceful retreat, ensuring restful nights and rejuvenating mornings. Additionally, the property includes two stylish bathrooms, which add convenience and privacy for residents and guests alike.

Situated in a desirable area, this apartment offers easy access to local amenities, including shops, restaurants, and public transport links, making it an ideal choice for those who appreciate urban living. The combination of space, comfort, and location makes this property a fantastic opportunity for anyone looking to settle in Manchester.

Do not miss the chance to make this lovely apartment your new home.







TS1534095, 11 Slivercroft Street, Manchester



Jium Terrace

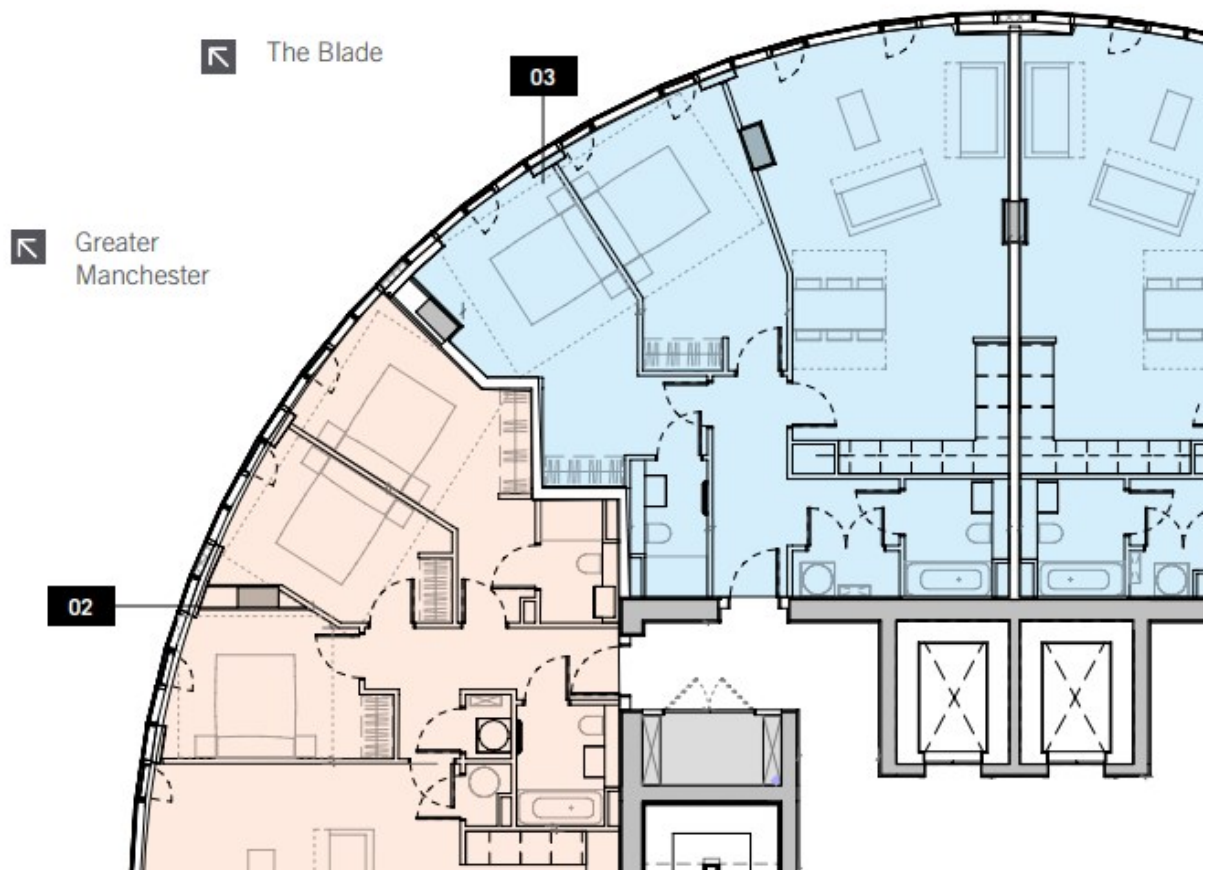

Energy Efficiency Rating		
	Current	Potential
<i>Very energy efficient - lower running costs</i>		
(92 plus) A		
(81-91) B		
(69-80) C		
(55-68) D		
(39-54) E		
(21-38) F		
(1-20) G		
<i>Not energy efficient - higher running costs</i>		
England & Wales	EU Directive 2002/91/EC	

EPC Rating:
Council Tax Band: F

CONTACT

5th floor, Empress Business Center
380 Chester Road
Manchester
M16 9EA

E: info@aihomes.uk

T: 0127 332 8069

