



**POOLE
TOWNSEND**

Ulverston Road, DALTON-IN-FURNESS, LA15 8EA

£85,000

🛏️ 2 🚿 1 🚗 1



Centrally located in the popular Furness town of Dalton, this mid-terraced home presents a fantastic opportunity, benefiting from being within walking distance of numerous town amenities, including bus and rail links, local shops, and reputable schools. The property offers open-plan living accommodation, providing a spacious and flexible layout, with convenient open access to the staircase. A large kitchen offers plenty of fitted storage and space for appliances, whilst the landing provides plenty of storage and access to two bedrooms and a modern bathroom.

Location

What3Words///situation.repair.shifters

Description

Dalton-in-Furness is a charming market town known for its community feel and excellent local amenities. Residents enjoy easy access to public transport, including bus and rail services, connecting them to surrounding areas. The town centre provides a variety of shops for daily needs, and quality schooling options are readily available within walking distance, making it an ideal location for many.

The heart of this home is the spacious, open-plan living accommodation, designed for flexibility and comfortable everyday living. This area provides ample room for both relaxation and dining, and open access onto the stairwell.

The kitchen is nicely proportioned and features a practical range of wall and base cupboards, complemented by a contrasting coloured worktop which thoughtfully incorporates an inset sink. There is dedicated space available for a freestanding cooker, a washing machine, and a fridge/freezer, ensuring all your culinary needs are met. A door from the kitchen leads out to a large rear yard, which features raised decking.

Ascending to the first floor, the landing benefits from fitted wardrobes with mirrored doors, offering excellent storage solutions. From here, separate doors lead to the modern bathroom and the two

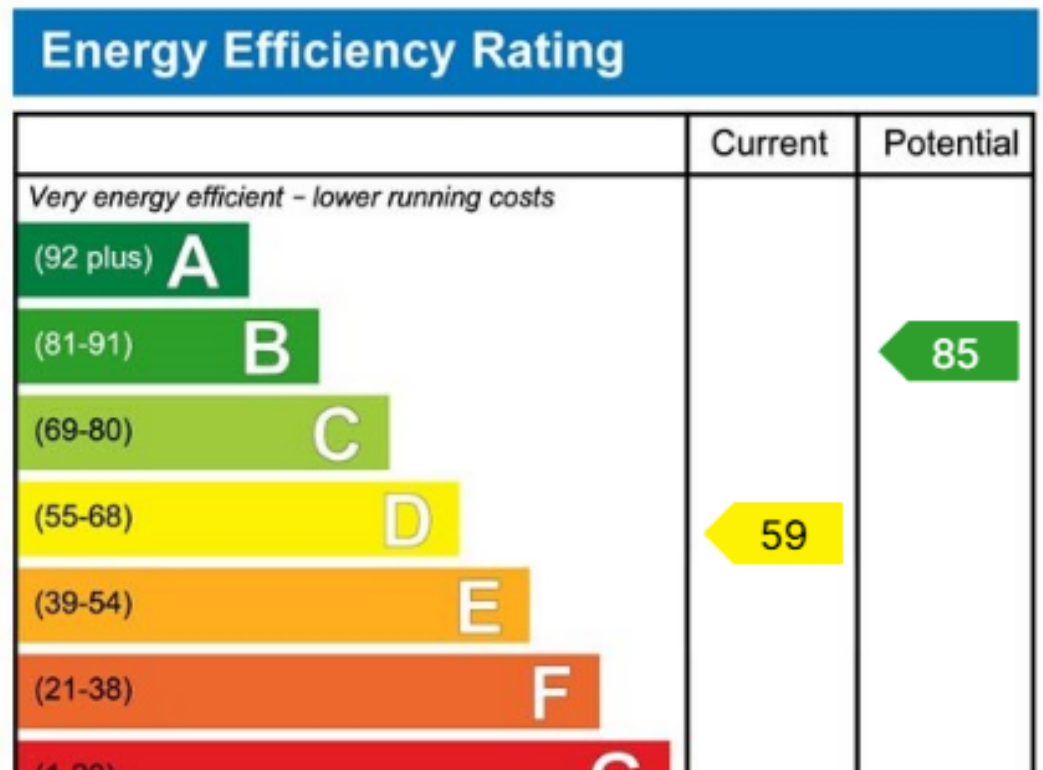

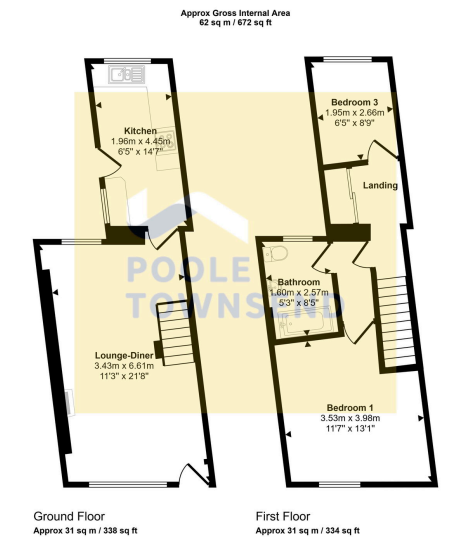

This floorplan is only for illustrative purposes and is not to scale. Measurements of rooms, doors, windows, and any items are approximate and no responsibility is taken for any error, omission or mis-statement. Items of items such as bathroom suites are representations only and may not look like the real items. Made with Made Snappy 360.

- 2 Bed Mid-Terraced House
- Walking Distance To Town Amenities
- Open Plan Living Accommodation
- Spacious And Flexible Layout
- Large Kitchen offers plenty Of Storage
- Plenty Of Storage
- Modern Bathroom
- Open Access To The Staircase
- Located In Popular Town Of Dalton

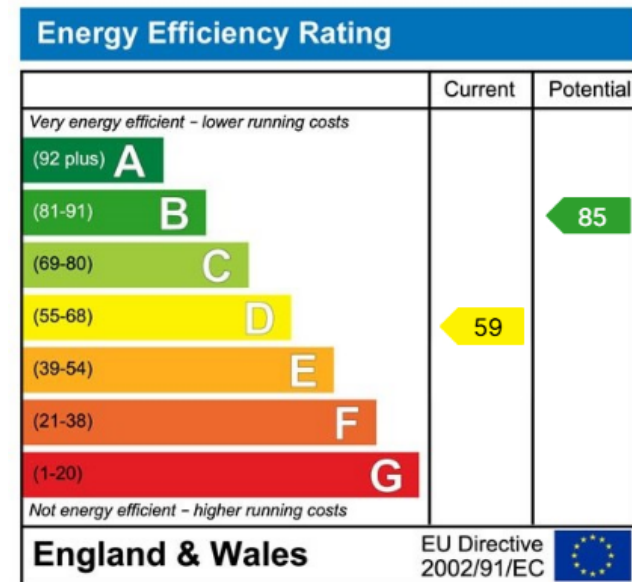

Visit us at
www.pooletownsend.co.uk
enquiries@pooletownsend.co.uk

We are open
 Monday – Friday 9.00 – 5.00
 Saturday 9.00 – 1.00

Barrow 01229 811811
 Ulverston 01229 588111
 Grange 015395 33316
 Kendal 01539 734455
 Milnthorpe 015395 62044