



19 - 27
FAIRVIEW
COURT

20 Fairview Court Manor Road, Ashford, TW15 2SN

£350,000

20 Fairview Court Manor Road, Ashford, TW15 2SN

Set within one of Ashford's most prestigious roads and fronting the picturesque Ashford Manor Golf Course, this stunning ground-floor apartment offers an exceptional blend of space, light, and exclusivity. Set within beautifully maintained communal grounds, the property enjoys a bright and airy living room with door out onto a patio area and communal gardens ideal for relaxing and enjoying this beautiful setting.

The property features two spacious double bedrooms, including a beautifully presented main bedroom with modern fitted wardrobes, and a modern fitted kitchen and bathroom. Additional highlights include a private garage located in a nearby block, a share of the freehold, and an outstanding lease term of more than 940 years with no ground rent. This exceptional home represents a rare opportunity to secure a premium apartment in one of Ashford's most exclusive settings. Call Alex White and his market leading sales team at Aspen estate agents.



Floor Plan

GROUND FLOOR
755 sq.ft. (70.1 sq.m.) approx.

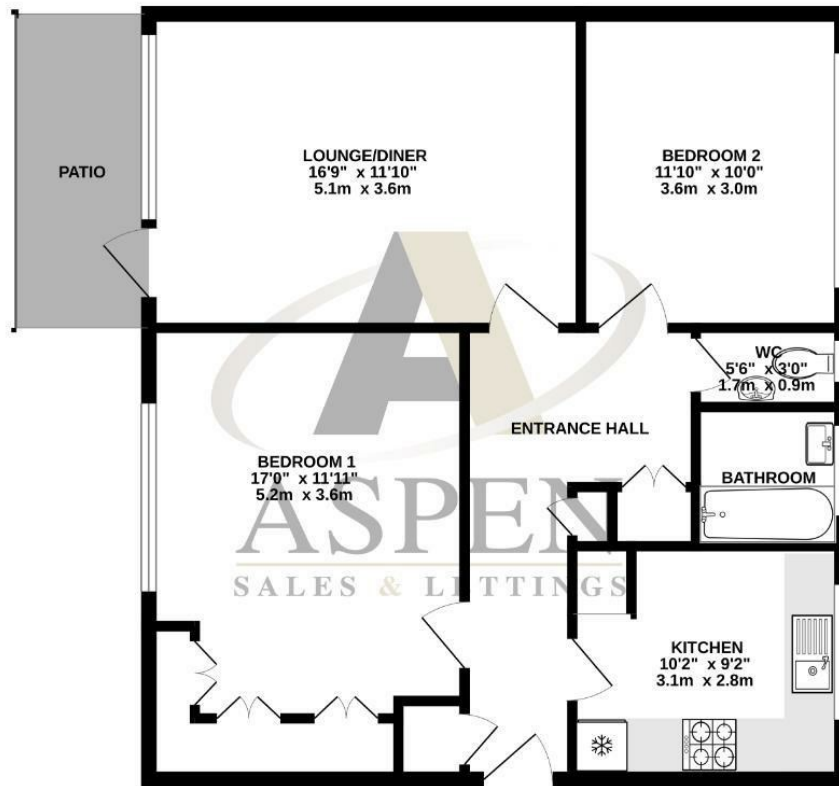

TOTAL FLOOR AREA: 755 sq.ft. (70.1 sq.m.) approx.
Whilst every attempt has been made to ensure the accuracy of the floorplan contained here, measurements of doors, windows, rooms and any other items are approximate and no responsibility is taken for any error, omission or mis-statement. This plan is for illustrative purposes only and should be used as such by any prospective purchaser. The services, systems and appliances shown have not been tested and no guarantee as to their operability or efficiency can be given.
 Made with Metropix 02026



Features

- Prestigious Ashford location overlooking the picturesque Ashford Manor Golf Course
- Bright and spacious living room with door onto private patio area
- Two generous double bedrooms including a superb main bedroom with fitted wardrobes
- Private garage in nearby block providing excellent storage and parking
- Outstanding lease of 940+ years with no ground rent
- Rare ground-floor apartment set within beautifully maintained communal grounds
- Patio opening onto attractive communal gardens ideal for relaxing
- Modern fitted kitchen and contemporary bathroom
- Share of freehold offering long-term security and ownership benefits
- Exceptional opportunity to purchase a premium apartment in one of Ashford's most exclusive roads

Aspen Residential Services
 77 Church Road, Ashford, Surrey, TW15 2PE
 Tel: 01784 252 202
 Email: enquiries@aspensalesandlettings.com

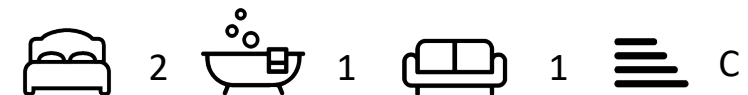

Tenure - Leasehold - Share of Freehold Council Tax Band - D

