



Rosewood Drive, Waverley, S60 8BA

£180,000

🛏️ 2 🚿 1 🚗 1



About the Waverley District

The Waverley district is a modern and thriving residential community situated between Sheffield and Rotherham, offering a perfect balance of contemporary living with convenient access to nearby city amenities. Known for its thoughtfully planned streets, landscaped green spaces, and attractive homes, Waverley has become a popular choice for families, professionals, and first-time buyers alike.

Residents enjoy a range of local facilities, including schools, shops, cafés, and leisure amenities, all within easy reach. Excellent transport links connect Waverley to Sheffield city centre and Rotherham, making it an ideal location for commuters. The area is also close to scenic walking and cycling routes, providing opportunities to enjoy the surrounding South Yorkshire countryside.

With its strong sense of community, modern infrastructure, and proximity to both urban and rural attractions, Waverley offers an appealing lifestyle for anyone seeking a contemporary home in a convenient and well-connected location.

Immaculate Two-Bedroom Upper Floor Apartment – Waverley Estate

This beautifully presented two-bedroom upper floor apartment on the sought-after Waverley Estate is ready to impress. Finished to a superb standard throughout, the property combines contemporary design with practical, comfortable living.

A communal hallway, stairs, and landing lead to a private entrance, opening into a spacious hallway. The open-plan lounge and kitchen form a bright, welcoming space, ideal for relaxing evenings or entertaining guests. Two generously sized bedrooms provide flexible accommodation, perfect for professionals, couples, or a small family, while the modern bathroom offers a touch of everyday luxury.

Externally, the property benefits from well-maintained communal areas and allocated parking, completing this stylish and convenient



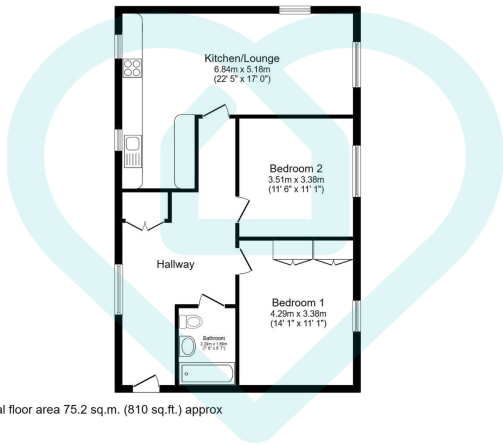

This floor plan is for illustrative purposes only. All measurements and layouts are approximations and do not necessarily capture the precise specifications of the property. No responsibility is taken for any error, omission, or misstatement. We always recommend viewing in person to confirm the exact floor plan of a property. Made with Metropix.



- Modern residential district between Sheffield and Rotherham
- Attractive homes appealing to families, professionals, and first-time buyers
- Excellent transport links to Sheffield and Rotherham
- Close to scenic walking and cycling routes
- Contemporary homes with modern infrastructure
- Thoughtfully planned streets and landscaped green spaces
- Local amenities include schools, shops, cafés, and leisure facilities
- Ideal location for commuters
- Strong sense of community in the area
- Balance of urban convenience and nearby countryside attractions

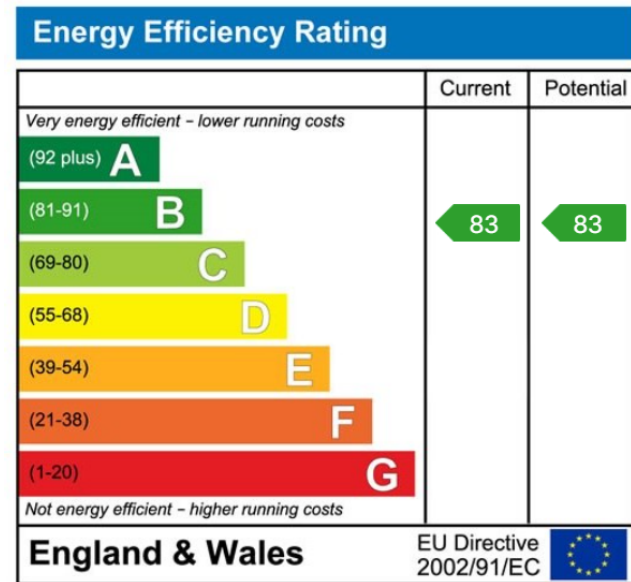

Sales | Lettings | New Homes

VAT Reg Number: 191 3588 84
 Company Reg Number: 08610489
 Company Reg Address: 67 Middlewood Road, Hillsborough, Sheffield, S6 4GX.

The MorfittSmith Building
 67 Middlewood Road
 Hillsborough
 Sheffield
 S6 4GX

Get in touch - arrange an appointment

0114 232 1764
 sales@morfittsmith.co.uk
 lettings@morfittsmith.co.uk
 newhomes@morfittsmith.co.uk
 www.morfittsmith.co.uk

@MorfittSmith
 @MorfittSmith
 MorfittSmith Estate & Letting Agent