

Frank Harris & Co.



Scrope Building, Bourne Estate, EC1N

£475,000

A very centrally located two bedroom, two bathroom apartment in a period building on the Bourne Estate. This flat is being sold with a long lease by the current owners and offers an excellent investment opportunity for a first time buyer or an investor.



Situated at the junction of Clerkenwell, Holborn and Hatton Garden, this property comprises a galley kitchen, a large reception room, two double bedrooms, a family shower room and an en suite shower room.

The location provides easy access to the many shops, bars and restaurants of Clerkenwell and Hatton Garden, with the West End approximately 20 minutes away by foot.

Transport links include the Circle Line, Metropolitan Line, Hammersmith and City Line and Elizabeth Line all located at Farringdon Station. The Central Line is accessible from nearby Chancery Lane station.

- Central Location • Two Bedrooms • Long Lease •
- Low Service Charge • First Floor • Large Reception Room •



Frank Harris & Co.

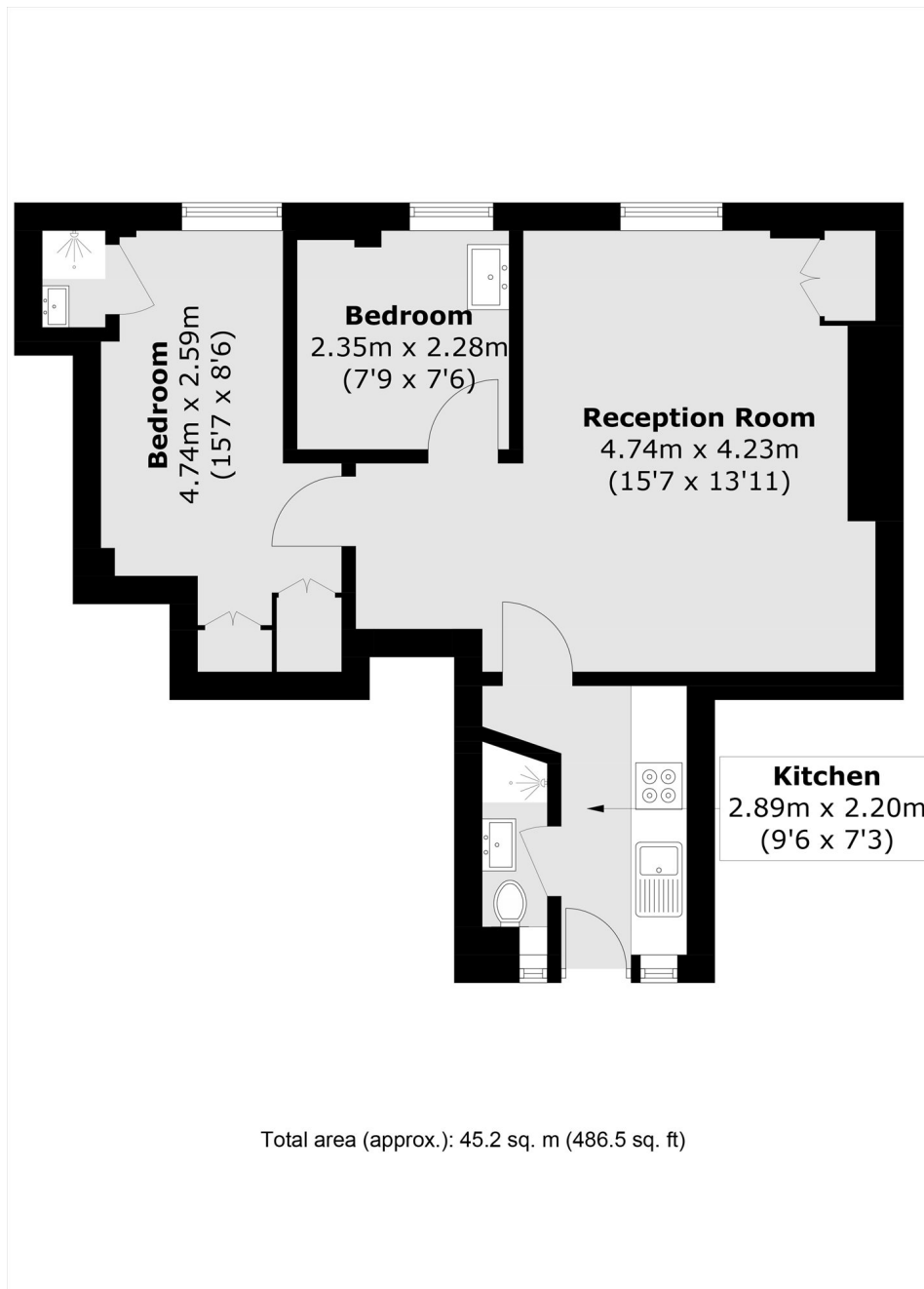

Frank Harris & Co. Barbican and City
87 Long Lane, London,
EC1A 9ET
020 7600 7000
citysales@frankharris.co.uk

Energy Rating: . We aim to make our particulars both accurate and reliable. However they are not guaranteed; nor do they form part of an offer or contract. If you require clarification on any points then please contact us, especially if you're traveling some distance to view. Please note that appliances and heating systems have not been tested and therefore no warranties can be given as to their good working order.

