



COUNTRY
HOLMES

4 Ashford Green, Gamesley

Offers Over £200,000

🛏️ 3 🚿 1 🚗 1



- Beautifully upgraded three-bedroom terraced home
- Stunning contemporary kitchen/dining room
- Useful utility room with potential for a ground-floor shower room
- Professionally landscaped front and rear gardens
- Ideal for first-time buyers, couples, and growing families
- Finished to an exceptional standard throughout
- Spacious and light-filled lounge with garden access
- Three double bedrooms, including principal bedroom with walk-in wardrobe
- Impressive summer house with fitted bar, power, and lighting
- No onward chain



An immaculately presented three-bedroom terraced home, extensively upgraded to an exceptional standard throughout. Featuring a stunning contemporary kitchen and bathroom, spacious lounge, utility room, walk-in wardrobe to the principal bedroom, and beautifully landscaped gardens to both the front and rear. The impressive outdoor space includes composite decking, a hot tub area, and a fully equipped summer house with bar, power, and lighting. Close to local amenities, this outstanding property offers stylish, move-in-ready accommodation perfect for first-time buyers and growing families.

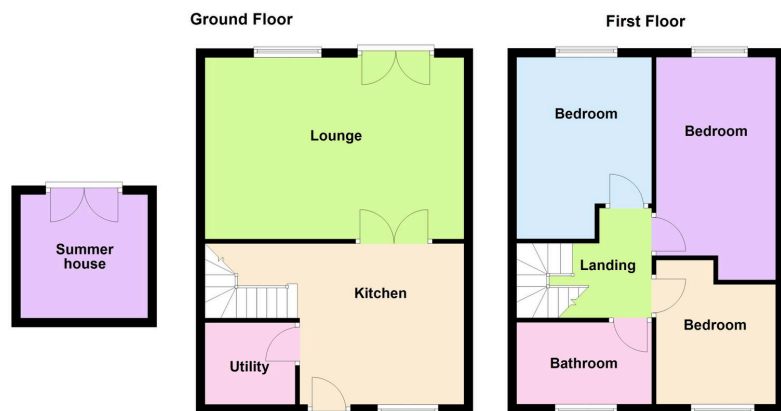

| Energy Efficiency Rating | | |
|---|-------------------------|-----------|
| | Current | Potential |
| Very energy efficient - lower running costs | | |
| (92 plus) A | | |
| (81-91) B | | 86 |
| (69-80) C | 75 | |
| (55-68) D | | |
| (39-54) E | | |
| (21-38) F | | |
| (1-20) G | | |
| Not energy efficient - higher running costs | | |
| England & Wales | EU Directive 2002/91/EC | |